

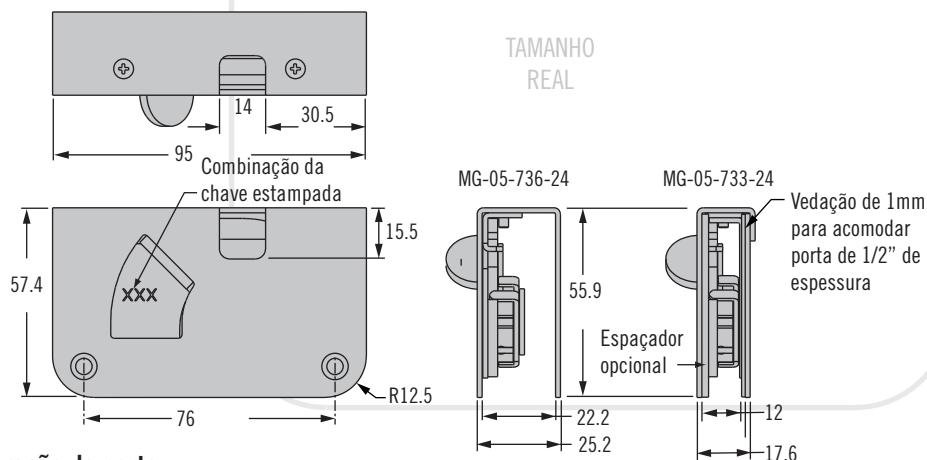

Fechadura Star Sailor

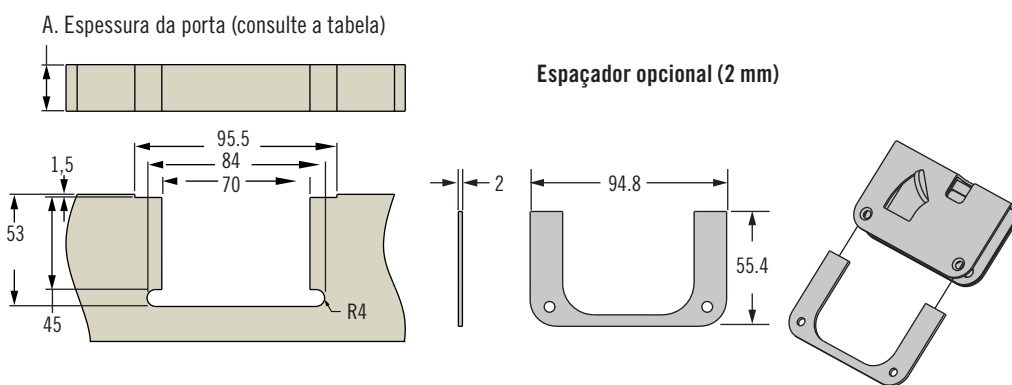

Preparação da porta



- Adequados para uso em portas de entrada com espessura de 12 mm e 22 mm
- Maior segurança com o módulo de travamento auxiliar com sistema de travamento Star Key Lock com cilindro tetrachave de seis pinos

Materiais e acabamentos

Caixa: Aço inoxidável
 Cilindro tetrachave: Latão
 Mola: Aço inoxidável classe 316
 Parafusos: Aço inoxidável classe 316

Código: MG-05-115

Para portas com 10 mm de espessura, use o espaçador MG-05-733-24
 Para portas com 20 mm de espessura, use o espaçador MG-05-736-24

Seleção do código de produto

Observações

Fechaduras e batentes devem ser pedidos separadamente. Para opções, consulte a tabela ao lado

Batentes e acessórios

Chave reserva, manopla preta (somente para segurança)		MF-96-XXX-41
Batente, alumínio anodizado		MG-90-102-60
Batente, alumínio anodizado preto		MG-90-102-50
Batente tipo olhal, aço inoxidável		MG-90-103-24
Batente tipo olhal, deslocado, aço inoxidável		MG-90-104-24
Espaçador para portas com 10 mm de espessura		MG-92-100-50
Batente P, alumínio anodizado		MG-90-105-50
Batente P, alumínio anodizado preto		MG-90-105-61

Fechadura Star Sailor

MG - 05 - 73 **C** - 24

C Espessura da porta (A)

- 3 12 mm
- 6 22 mm



MG - Fechaduras de Segurança

- Construção total em materiais resistentes à corrosão, incluindo poliamida, aço inoxidável e latão
- Travamento com mecanismo deslizante por dentro e chave por fora
- O conjunto inclui um contrabatente e duas chaves

Materiais e acabamentos

Acabamentos: Caixa em poliamida, nas cores branco ou preto

Acessórios

Travamento: Chave reserva com manopla preta disponível (opcional).

Espaçador: Espaçador disponível para uso em portas com 10 mm de espessura.

Contrabatente: Diversas opções de contrabatentes disponíveis, em alumínio anodizado incolor ou preto, ou aço inoxidável.

Para chaves adicionais, entre em contato com a Southco

Observações

Para mais opções em batentes e acessórios, consulte a página 537.

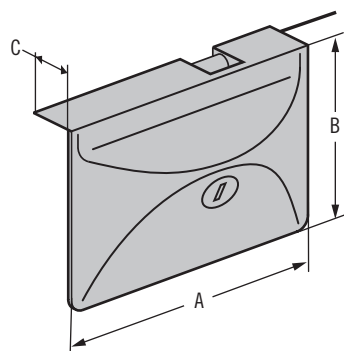

	Imperial		Métrica
	Nominal	Decimal	
A	3 27/64	3,43	87
B	2 11/64	2,17	55
C	15/32	0,47	12

Preparação da porta

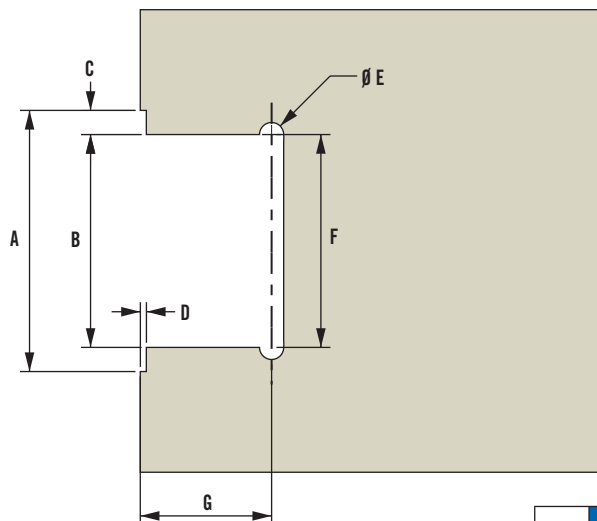

	Imperial		Métrica
	Nominal	Decimal	
A	3 13/32	3,41	86,5
B	2 25/32	2,78	70,5
C	15/16	0,32	8
D	5/64	0,08	2
E	5/16	0,31	8
F	2 27/32	2,84	72
G	1 23/32	1,71	43,5

Como determinar o segredo da sua chave

Segredo da chave (formato 8__ ou 9__) para pedido de chaves adicionais

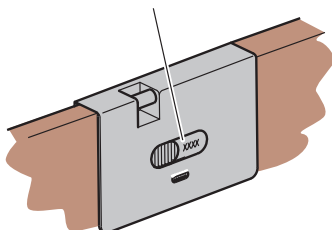

Fechaduras de segurança - Códigos		
	Preto	Branco
Com batente P e duas chaves	MG-01-110-50	MG-01-110-70

Outras opções disponíveis. Para mais informações sobre modelos, códigos, instalação e especificações, visite



www.southco.com/MG

Dimensões em milímetros, salvo quando especificado o contrário

southco
CONNECT · CREATE · INNOVATE

CABIN & COCKPIT ENTRY HARDWARE

MG L-Star Entry Door Lock

A

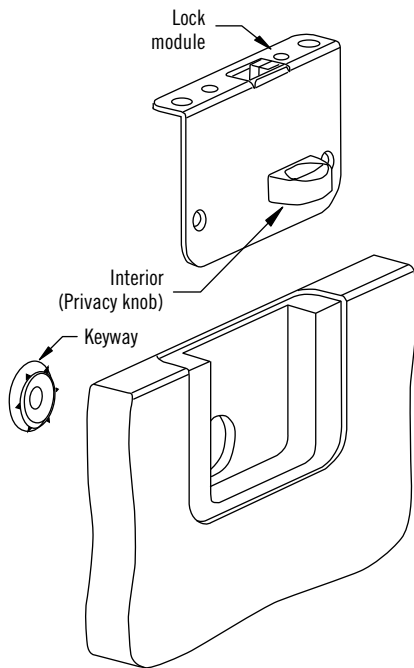

Part number

MG-03-630-24

Gain more stylish and more secure locking performance for specialised door applications in sail or motor boat and yacht construction. The Mobella L-Star is ideal for washboard entry ways – even those angled up to 7° beyond perpendicular – as well as for bi-fold doors and other cabin or entry doors. The security of the Star-Lock mechanism adds peace of mind, while all-marine-grade construction ensures robust performance.

- Enhance high-end security with the hard-to-compromise Star-Lock three-axis six-pin tumbler design
- Locks can be matched to other Southco deck latches
Contact Southco Marine for more information
- Simplify installation with slip-in mounting on the back edge of the door
- Satisfy customer preferences with a variety of decor options
- including diamond brass, polished chrome and satin finishes
- Accommodate door thicknesses from 19 mm to 45 mm without a recess, and engage with overhead hatches of 10 mm or thicker

Panel Preparation

Minimum panel thickness A 20 mm (0.71), Maximum panel thickness 44 mm (1.75).

No mounting hardware included.

Flush mount panel preparation shown

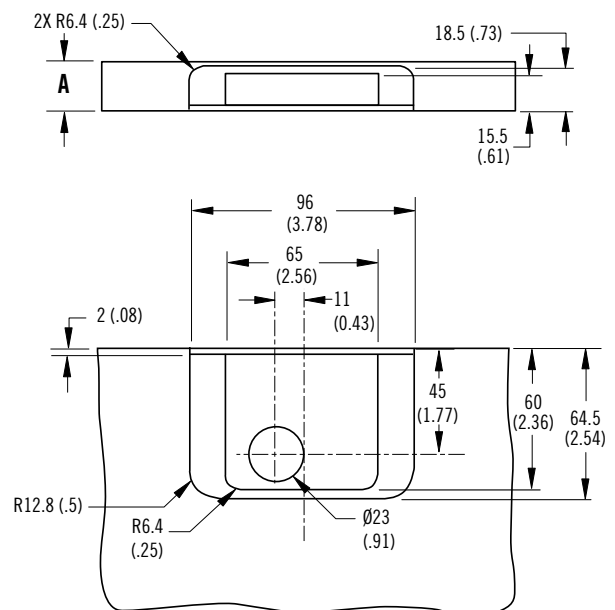
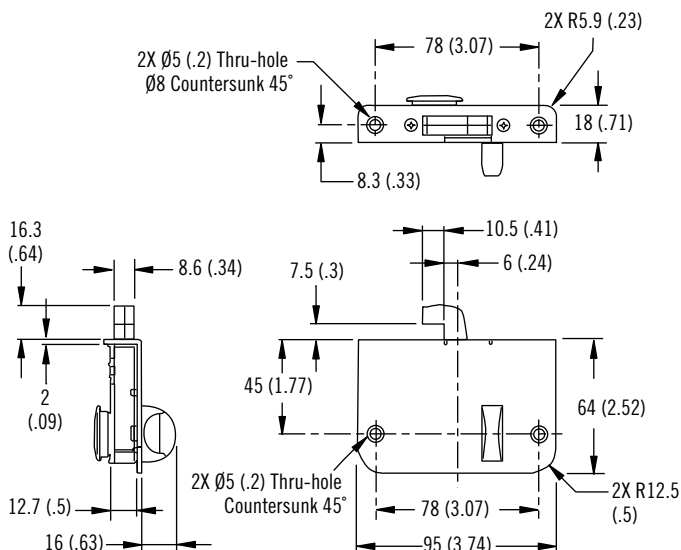

CABIN & COCKPIT ENTRY HARDWARE

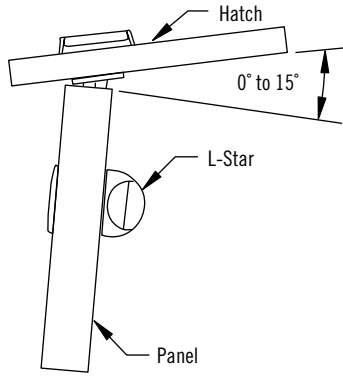

Striker

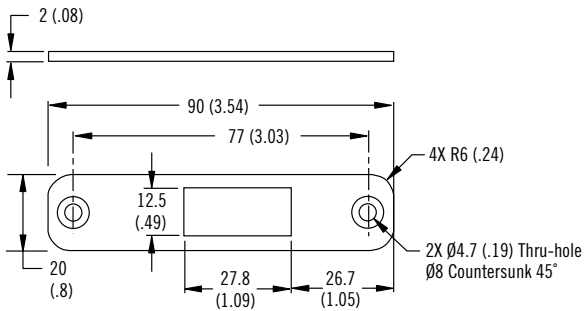

Striker Part number

MG-90-300-24

Panel Preparation

Minimum panel thickness without recess 19 (.75). Angle range between hatch and panel -7° to +7°. No mounting hardware supplied.

Flush mount panel preparation shown

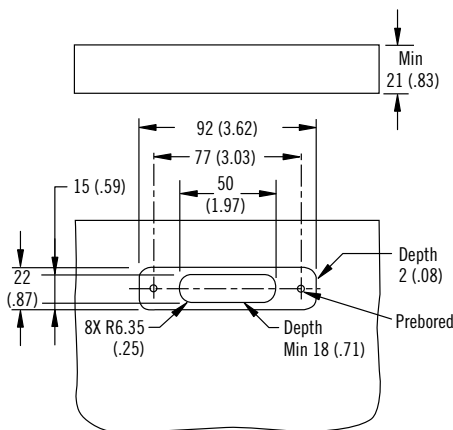

Striker Hood

The Striker Hood is designed for thin panels, or where the panel may not be suitable to directly attach the striker. Note: A striker must be used with the Striker Hood.

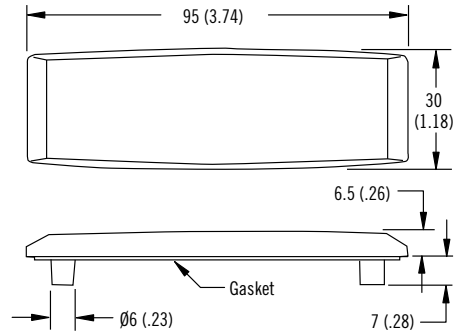

Striker Hood Part number

MG-90-330-24

Panel Preparation

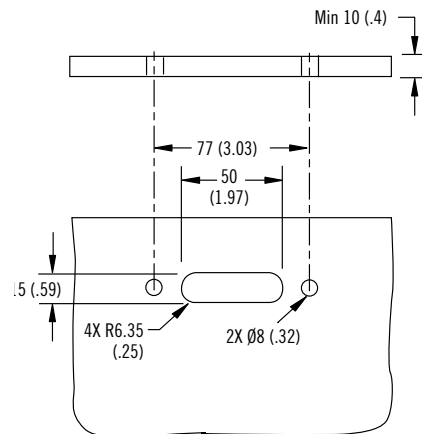

CABIN & COCKPIT ENTRY HARDWARE

MG Single Star Entry Door Lock

A



The Mobella Single Star-Lock provides the flexibility and functionality of a deadbolt that can be installed alone or combined with another latch mechanism for cabin doors, washboard doors, and other door security. By combining reliable Star-Lock performance, all-marine-grade construction, and a clean look with multiple keyhole finish options, it offers the perfect blend of robustness and style for sail or motor boat and yacht applications.

- Enhance high-end security with the hard-to-compromise Star-Lock three-axis six-pin tumbler design
- Locks can be matched to other Southco deck latches
Contact Southco Marine for more information
- Mortise mount design provides a clean appearance
- Satisfy customer preferences with a variety of decor options – including diamond brass, polished chrome and satin finishes
- Accommodate door thicknesses ranging from 22 mm to 45 mm

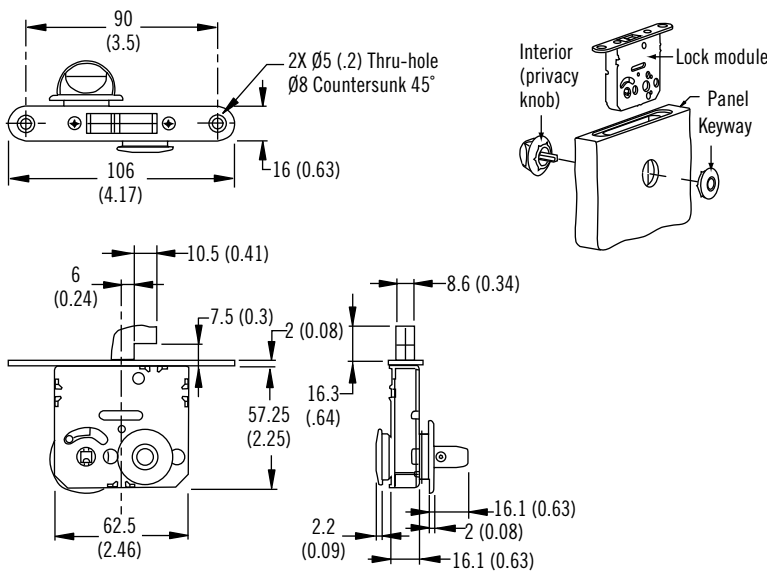

Panel Preparation

*see part number table

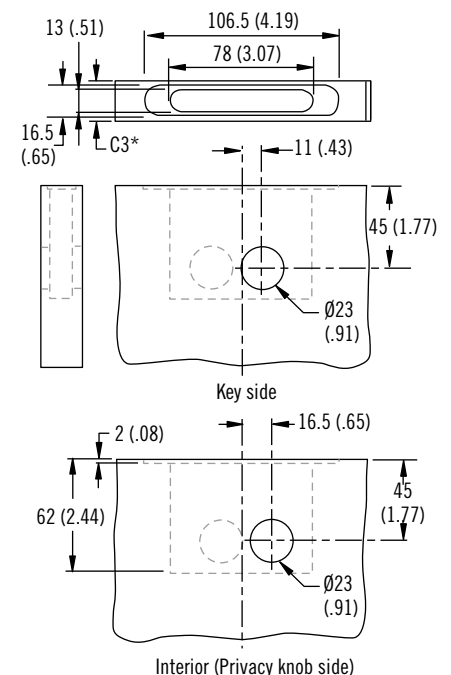

How to order Single Star

Part number formula MG-04-53C ₃ -FF		
DOOR THICKNESS		
C ₃	0	22-30mm (7/8-1 3/16")
	1	28-37mm (1 1/8-1 1/2")
	2	36.5-45mm (1 7/16-1 3/4")
FINISH Handle/Privacy/Escutcheons		
FF	10	Chrome
	20	Satin (matte chrome)
	40	Diamond brass



CABIN & COCKPIT ENTRY HARDWARE

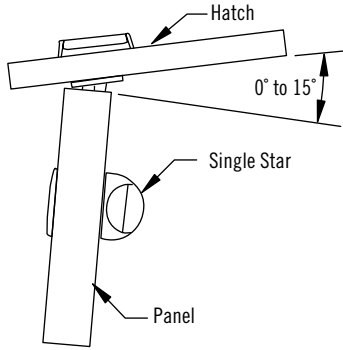

Striker

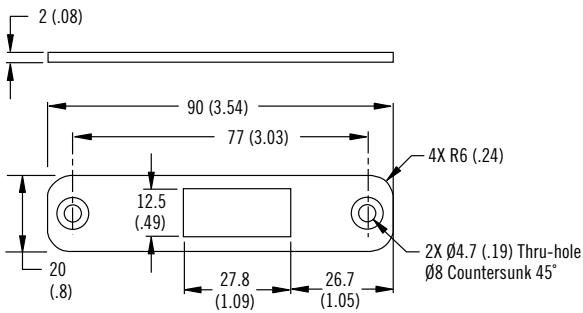

Striker Part number

MG-90-300-24

Panel Preparation

Minimum panel thickness without recess 19 (.75). Angle range between hatch and panel -7° to $+7^\circ$. No mounting hardware supplied.

Flush mount panel preparation shown

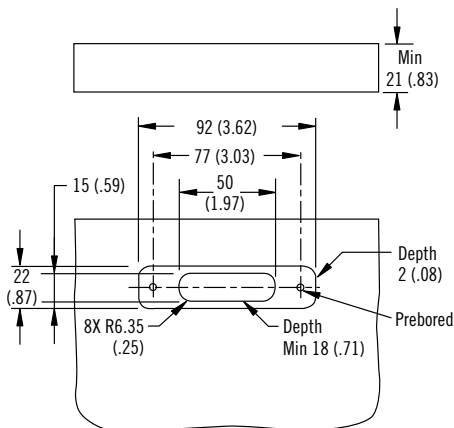

Striker Hood

The Striker Hood is designed for thin panels, or where the panel may not be suitable to directly attach the striker. Note: A striker must be used with the Striker Hood.

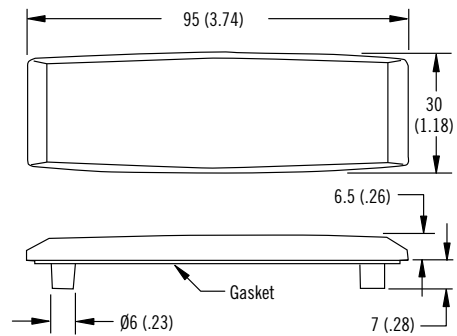

Striker Hood Part number

MG-90-330-24

Panel Preparation

