

valco
baby

PRODUCT REFERENCE GUIDE

Travel System Adaptor

for Snap and Snap 4 prams to fit:

- Safe-n-Sound Unity™ Travel System
- Babylove Snap'n Go™ Travel System
 - Maxi Cosi™ Mico Travel System



© Copyright
VE 2012
vs180612

FURTHER INFORMATION:
Australia
www.valcobaby.com.au
1300 0 VALCO

Find us on:



Travel System Adaptor

for Snap and Snap 4 prams to fit:

- Safe-n-Sound Unity™ Travel System
- Babylove Snap'n Go™ Travel System
- Maxi Cosi™ Mico Travel System

Thank you for purchasing a quality VALCO BABY product. Please read and follow the instructions outlined in this guide carefully. Familiarise yourself with the construction and safety features; be sure that you understand all the warnings and safety guidelines before use.

Important: Please read the following instructions carefully before assembling this product. Retain this guide in a safe place for future reference.

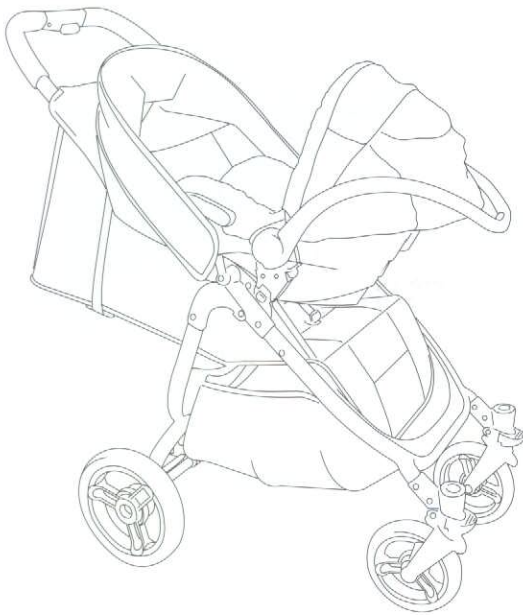

DISCLAIMER

Due to our policy of continuous product development, this product is constantly evolving. It is possible that some features or procedures outlined here have changed since this document was written. If you are unsure of any procedure shown here, please contact us via the web at support@valco.com.au or call 1300-0-VALCO to obtain the most up to date information before use. Include the batch number and model number, which can be found on a sticker on the frame.

All pictures and diagrams herein are provided for illustration purposes only. Actual product, colour or fabric may vary. VALCO BABY reserves the right to modify or alter any specification or colour without notice or obligation to modify any product previously purchased.

TRAVEL SYSTEMS

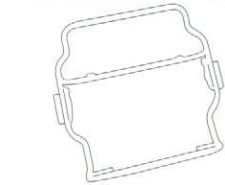

A Safe-n-Sound Unity™



B Babylove Snap'n Go™



C Maxi Cosi™ Mico

SAFE-N-SOUND UNITY™ TRAVEL SYSTEM

FOR FULL INSTRUCTIONS PLEASE REFER TO PAGE 6.

1> PARTS

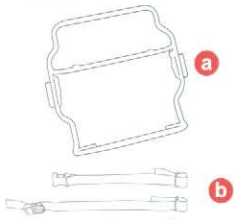

2> REMOVE BUMPER BAR



3> INSTALL SEAT

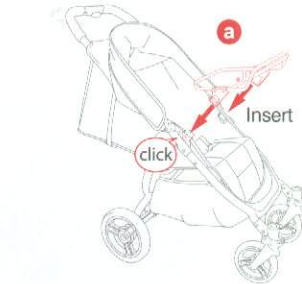
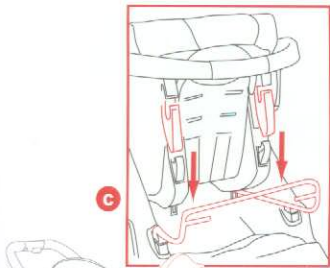

4> REMOVE SEAT

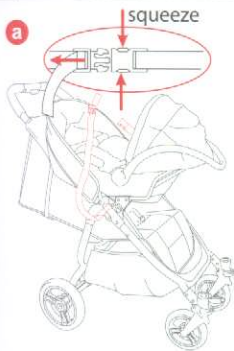

5> REMOVE ADAPTOR

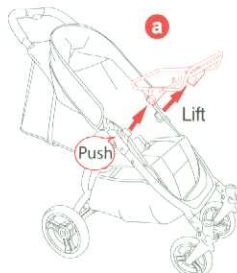

BABYLOVE SNAP'N GO™ TRAVEL SYSTEM

FOR FULL INSTRUCTIONS PLEASE REFER TO PAGE 6.

1>PARTS

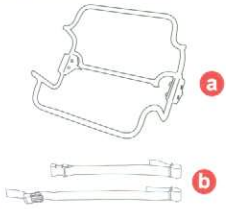

2>REMOVE BUMPER BAR

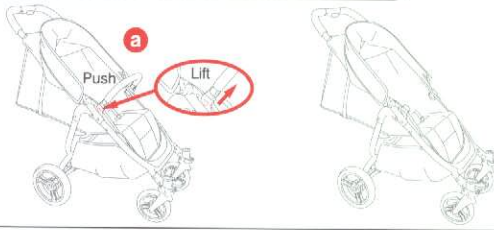

3>INSTALL SEAT

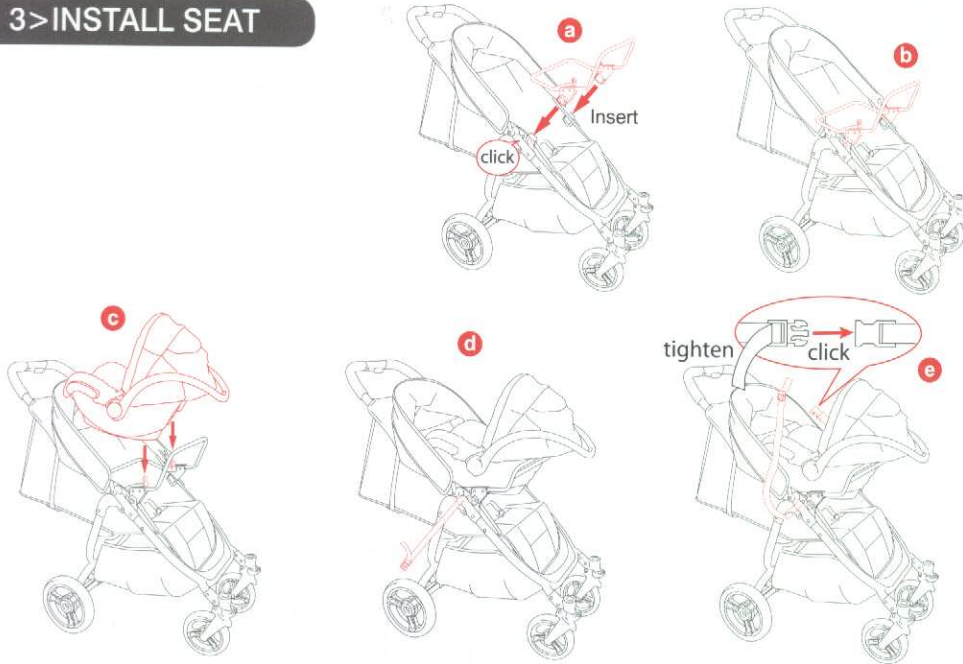

4>REMOVE SEAT

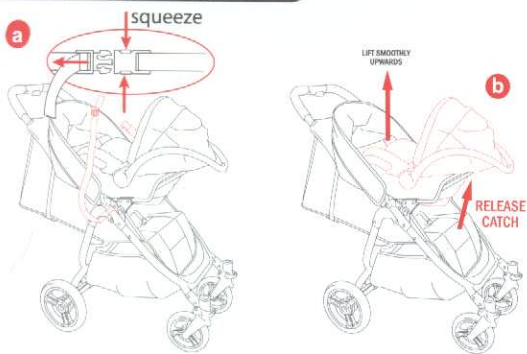

5>REMOVE ADAPTOR

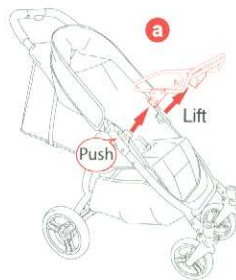

Maxi Cosi™ Mico Travel System

FOR FULL INSTRUCTIONS PLEASE REFER TO PAGE 7.

1> PARTS

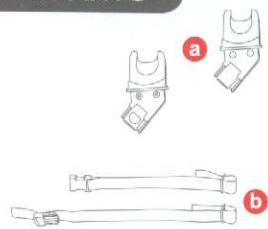

2> REMOVE BUMPER BAR

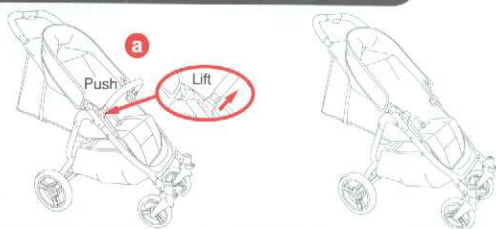

3> INSTALL SEAT

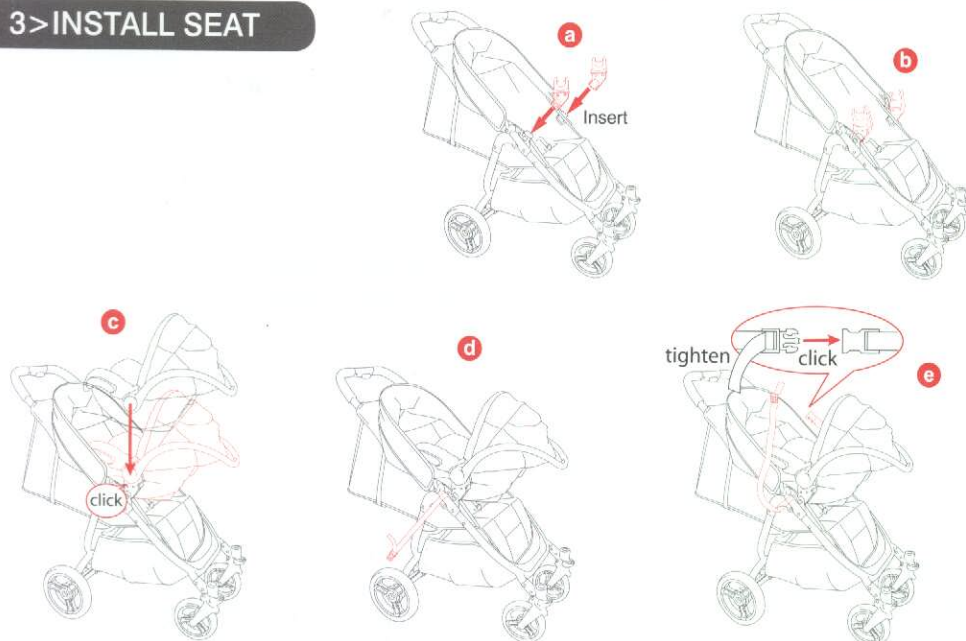

4> REMOVE SEAT

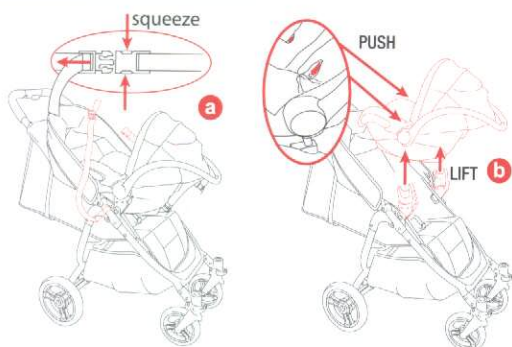

5> REMOVE ADAPTOR

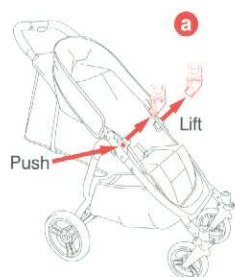

MAXI COSI™ MICO TRAVEL SYSTEM

1 > PARTS LIST

- (a) 2x infant car seat adaptors
- (b) 2x security straps

2 > REMOVE BUMPER BAR

- (a) Refer to your stroller product guide

3 > INSTALLING YOUR INFANT CAR SEAT

- (a) Install Adaptor inserting the two connectors into the corresponding settings into the bumper bar housing.
- (b) Test the adaptor is securely attached.
- (c) Align each adaptor directly beneath the round side hinges which incorporate the seat handle. Push the seat downwards over the adaptors until you hear and feel them lock in place. Test.
- (d) Attach safety strap onto both sides of stroller
- (e) Fasten and click straps together to secure car seat.

4 > TO REMOVE THE SEAT

- (a) Squeeze the clasp to release the security straps.
- (b) Press the release catch at the rear of the seat while lifting the seat vertically.

5 > TO REMOVE THE ADAPTOR

- (a) Push both side buttons to release the bumper bar and lift vertically.

WARNING: TO AVOID INJURY OR DEATH

- FOLLOW THE MANUFACTURER'S INSTRUCTIONS.
- PUT ON ALL THE BRAKES WHENEVER YOU PARK THE PRAM/STROLLER.
- DO NOT LEAVE CHILDREN UNATTENDED.
- DO NOT CARRY EXTRA CHILDREN OR BAGS ON THIS PRAM/STROLLER.
- MAKE SURE CHILDREN ARE CLEAR OF ANY MOVING PARTS IF YOU ADJUST THE PRAM/STROLLER. OTHERWISE THEY MAY BE INJURED.

Remember, your child's safety is your responsibility...

- NEVER USE ON STAIRS OR ESCALATORS.
- ALWAYS USE THE TETHER STRAP WHEN THE STROLLER IS IN USE.
- THE CORRECT USE AND MAINTENANCE OF THIS VEHICLE ARE ESSENTIAL.
- BE SURE THAT ALL CLAMPS AND BUCKLES ARE SECURELY FIXED AND IN PLACE BEFORE USE
- WHEN IN THE STROLLER, YOUR CHILD MUST ALWAYS WEAR THE SAFETY HARNESS, CORRECTLY FITTED AND ADJUSTED, AT ALL TIMES.
- NEVER EXCEED THE MAXIMUM WEIGHT OR HEIGHT OF THE CHILD FOR WHICH YOUR CAR SEAT IS INTENDED - REFER TO YOUR CAR SEAT MANUAL FOR INFORMATION REGARDING THE WEIGHT AND HEIGHT FOR WHICH THE SEAT CAN BE USED.
- REFER TO YOUR CAR SEAT MANUAL FOR USAGE INSTRUCTIONS
- NEVER RUN WITH A NEWBORN BABY IN ANY PRAM OR STROLLER.
- CHECK ALL PARTS BEFORE USE FOR BREAKAGE OR FATIGUE. DISCONTINUE USE IMMEDIATELY IF ANY PART IS FOUND TO BE DAMAGED OR BROKEN.
- MAXIMUM LOAD OF BASKETS: 3.5KGS.
- ALWAYS BE AWARE OF THE RISKS PROVIDED BY FIRE AND OTHER SIGNIFICANT SOURCES OF HEAT SUCH AS RADIATORS, ETC. WHICH MAY BE IN THE IMMEDIATE VICINITY OF YOUR STROLLER.
- IT MAY BE UNSAFE TO USE ANY ACCESSORIES OTHER THAN VALCO APPROVED ONES.
- THIS PRODUCT IS INTENDED FOR DOMESTIC USE ONLY. IT IS NOT INTENDED FOR COMMERCIAL USE.