



Manual for the DHL32 (F600 series) LCD monitor

DHL32 (F600 series)

Manual for the LCD monitor

2016 V1.0

Zhejiang Dahua Technology Co., Ltd.

1. Service environment requirements

- ◆ The equipment is designed for indoor use, therefore, it cannot be used in wet or dusty environment.
- ◆ It is not allowed to block the ventilation hole inside the equipment or hamper air circulation around it. If the ventilation hole of the equipment is blocked, the temperature inside it will rise, easily resulting in a fire.

2. Accessory inspection

Refer to the following table to check whether accessories are complete (note: the list is configured according to the standard configurations of the system, the lists for special users are subject to the packing list).

Accessory name	Qty
LCD monitor	1 unit
AC power cord	1 piece
VGA cable	1 piece
Audio cable	1 piece
Manual plus warranty card	1 piece
Base	1 piece
screws	4 piece

3. Port schematic diagram

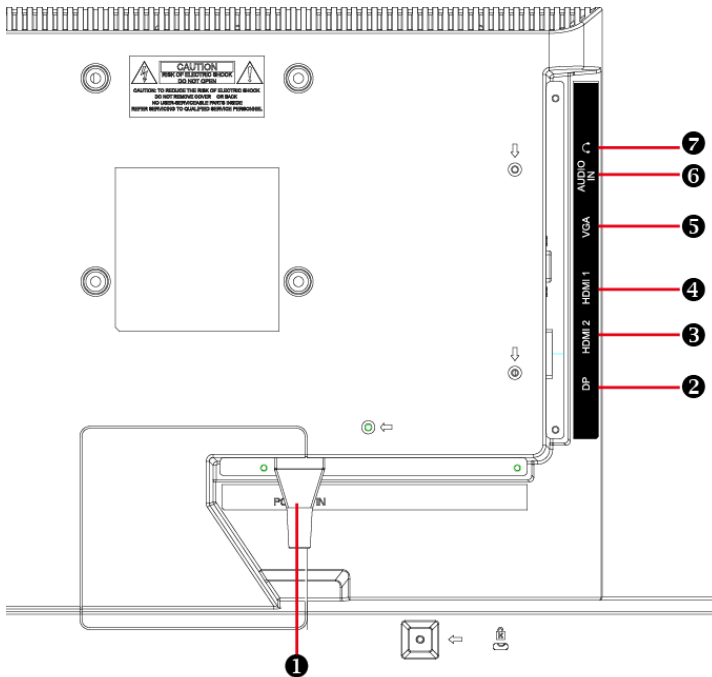

Sequence number	Name	Sequence number	Name
1	AC input outlet	2	DP input
3	HDMI 2 input	4	HDMI1 input
5	VGA input	6	Audio input
7	Earphone output		

4. Installation instructions

4.1 Installation means

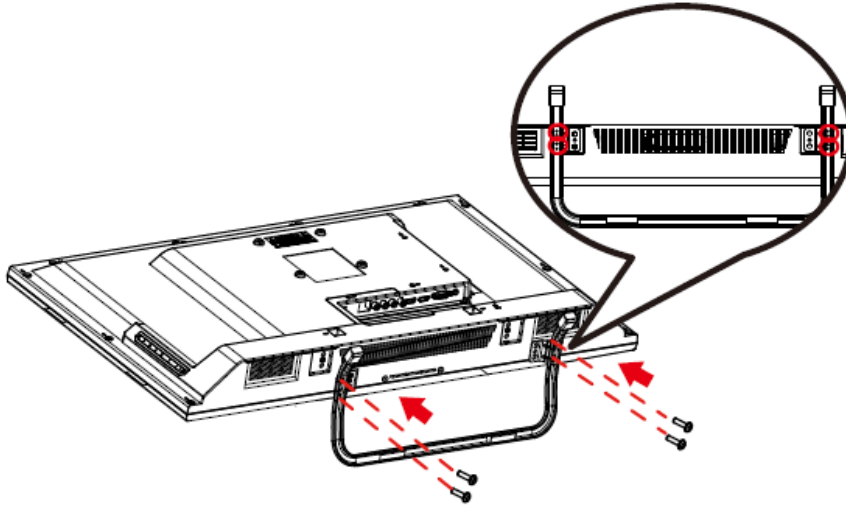

- 1.Lay the monitor flat on a table with the LED screen face down. To prevent the TV from being scratched, put a piece of soft cloth on the table on which the screen will be set. Place the base in position as shown.Insert and tighten 2 screws(provided)into pedestal holes as shown.
- 2.Stand the TV up.

4.2 Control and connection

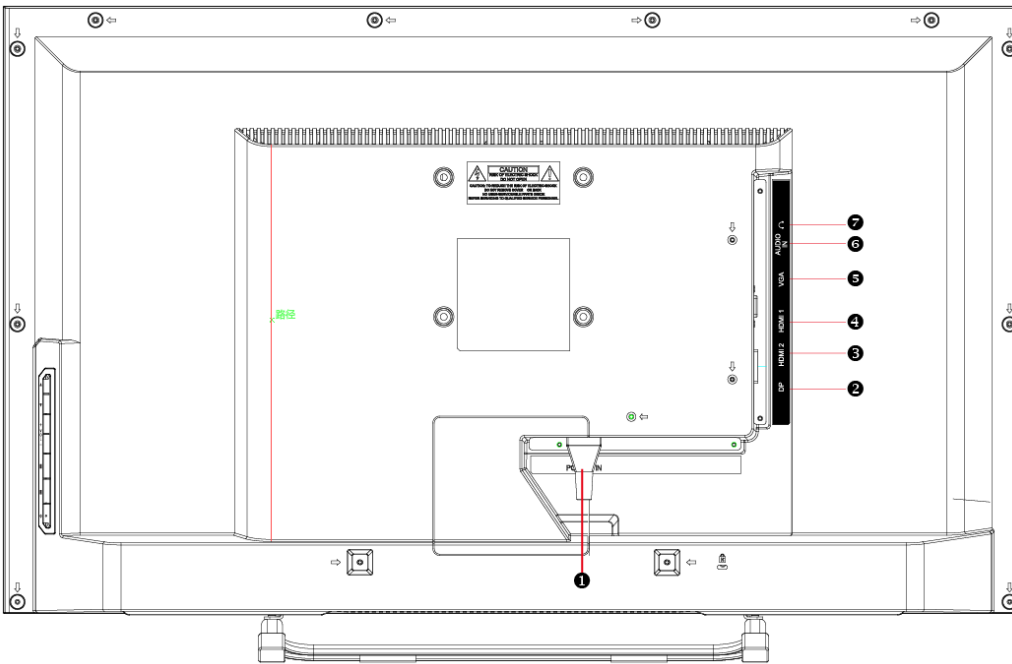

1	Power cord socket
2	DP signal line socket
3	HDMI2 signal line socket
4	HDMI1 signal line socket
3	D-SUB signal line socket
4	Audio cable socket
5	Earphone cable socket

4.3 Signal line connection

- **connect VGA cable**

Connect the VGA cable from VGA output of computer to the VGA input of the monitor.

- **or connect HDMI cable**

Connect the HDMI cable from HDMI output of computer to the HDMI input of the monitor.

- **or connect DisplayPort cable**

Connect the DisplayPort cable from DisplayPort output of computer to the DisplayPort input of the monitor.

- **3. Connect Audio cable**

Connect the Audio cable from Audio output of computer to the Audio input of the monitor.

- **Connect Earphone (not supplied)**

Connect the earphone to the earphone output terminal of the monitor. (Earphone sold separately).

4.4 Power-ON the computer, then Power-ON the monitor. **Power cord connection**

Front panel operation instructions

- Power switch: Press the power switch key to turn on/off the monitor power.
- Power indicator: Blue-ON, Orange-Standby state
- Menu/selection: Activate the OSD menu or identify adjusted functions.

5. Parameter settings

5.1 Key description

1	Picture Mode
2	Brightness/contrast,
3	Volume +
4	Volume -
5	OSD Menu On/Off
6	Input Source/ Confirm Select
7	Power switch

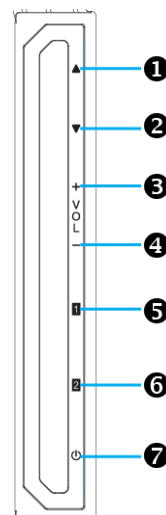

5.2 Menu description

Main menu	Sub-menu	Description
Automatic adjustment	Image auto adjustment	Adjust the horizontal and vertical positions, phase (trimming) and clock (horizontal width) of the screen.
Contrast/Brightness	Contrast	Adjust the display contrast
	Brightness	Adjust the display brightness
	DCR	Enable/disable DCR
	ECO	Enable/disable ECO
	OD	Enable/disable OD
Input source	VGA	Select the input VGA mode
	HDMI1	Select the input HDMI1 mode
	HDMI2	Select the input HDMI2 mode
	Displayport	Select the input Displayport mode
	AUTO	Select the input Auto mode
Audio adjustment	Volume	Adjust the loudspeaker output volume
	Mute	Enable/disable Mute
	Audio Input	Select Displayport/Line in/HDMI audio input
Colour Setting	Cool	Set to cold color temperature
	Normal	Set to conventional color temperature
	Warm	Set to warm color temperature
	User colour	Adjust to red (R), Green (G) and Blue (B) respectively.
	Picture mode	Select Standard, game, Video, Landscape, Text modes
Information	Information	Display information related to the current input signal (from the graphics card)
Manual image adjustment	H. /V.position	Adjust video horizontal and vertical positions
	Horizontal size	Adjust the screen image width
	Phase	Trim data and clock delay
	Sharpness	Adjust non-main signal definitions
	Video mode adjustment	Select Full-Screen / Aspect Ratio/Dot by dot modes
Menu Setting	Language select	Allow the user to select from languages provided
	OSD position	Adjust the horizontal and vertical OSD positions
	OSD time out	After the preset time, turn off the screen menu display automatically
	logo	Display logo on/off
	OSD background	Allow the user to turn on or off the menu background color
Memory recall	Restore the setting	Restore the factory settings of video and audio widgets Press Key  to select restoration of the menu item set

6. Common troubleshooting

If problems are not included in the following symptoms described, please contact the manufacturer for treatment.

Symptoms	Troubleshooting
1) The power indicator is not lit	<ol style="list-style-type: none"> 1. Turn on the power supply or not 2. Plug the power cord or not.
2) Cannot realize plug and play	<ol style="list-style-type: none"> 1. Whether the PC matches the plug-and-play. 2. Whether the display adapter matches the plug-and-play. 3. Whether the 15-pin D-type signal line contact is bent.
3) The image is dim	Adjust the brightness and contrast
4) Image jitter or ripple	There may be electric equipment around it causing electronic interference.
5) The power indicator is lit, however, the monitor does not display any image	<ol style="list-style-type: none"> 1. Inspect whether the PC power is turned on. 2. Inspect whether the PC video card has been inserted properly 3. Inspect whether the monitor signal line has been connected to the PC properly. 4. Inspect the monitor signal line contact and identify that pins are not bent. 5. Identify by pressing the Caps Lock key indicator on the PC keyboard
6) Lack of color (Red, green, blue)	Inspect the monitor signal line and identify that pins are not bent.
7) The screen is not in the middle or its size is not proper	Adjust the clock (CLOCK) and phase (PHASE) or press and hold the hot key 
8) The screen displays "The signal line is not connected"	<ol style="list-style-type: none"> 1. Inspect whether the signal line is connected correctly; if the contact gets loosened, please fasten the screws to the contact. 2. Inspect whether the pin of the signal line contact is damaged.
9) The screen displays "Input is not supported"	Your PC is set to an improper display mode, please reset your PC to the display mode listed in the table below.

7. Product marking and explicit instructions

7.1 Product pollution control marking

Products manufactured by our company have adopted the following electronic and information product pollution control markings:



7.2 Explicit instructions

Our company began to implement the requirements of the European Union's Restriction on Hazardous Substances (RoHS) Directive in electronic and electric devices and all products in the future will conform to the indicator requirements of relevant regulations.