

ANCHOR CV.

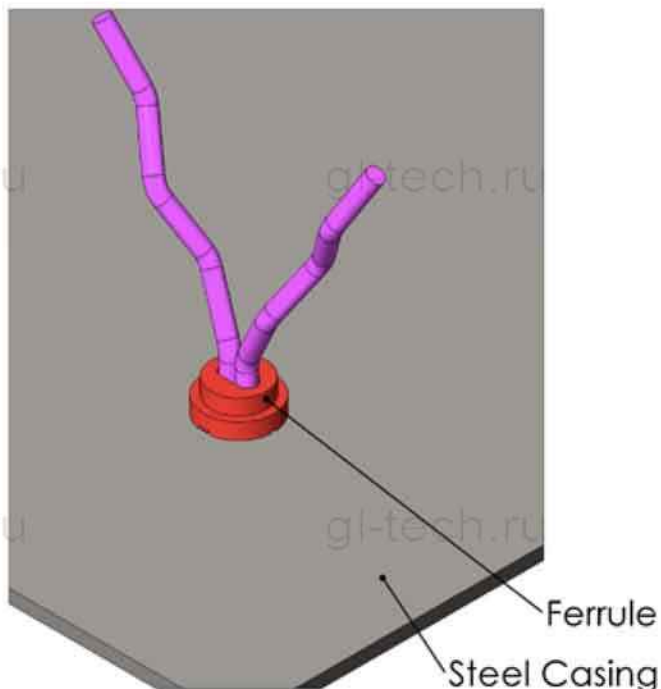

1. A ceramic ring is used to weld anchor on the steel casing through an electrical arc melting between the anchor base and the steel shell.

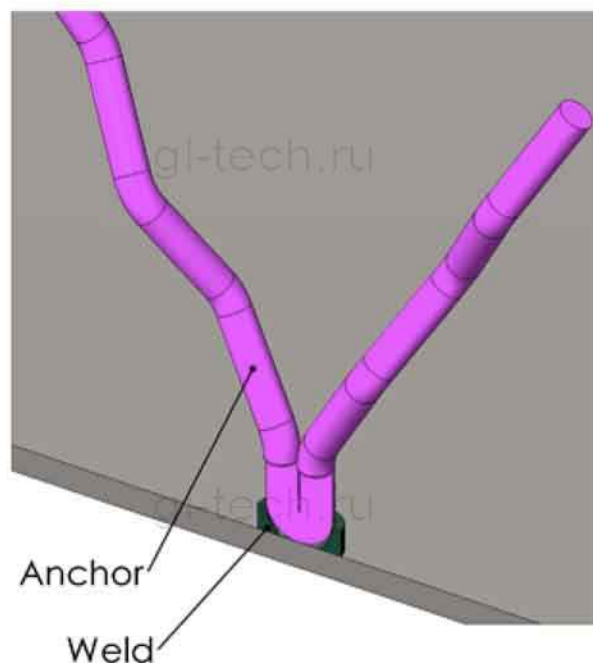

2. The ceramic ring is broken off and the weld can be inspected.

TYPICAL WELDING GUN



The aluminium ball (AB) is recommended for gun welding.



Aluminium ball



IRIS - Industrial Refractories & Insulating Specialities
Parc d'Activités Aérodrome Ouest - Rouvignies - F - 59328 VALENCIENNES Cedex (France)

Tél : +33 (0)3.27.21.52.80
E-mail: contact@irisfrance.com

Fax : +33 (0)3.27.21.52.99
Web: www.irisfrance.com

This drawing is the property of IRIS. Unauthorised use of patented features and/or reproduction of this drawing is strictly prohibited

ANCHOR CV.

CV 1



FERRULE

CV 2

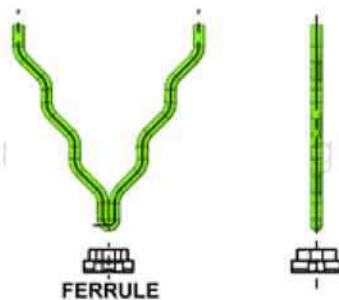

FERRULE

CV 4

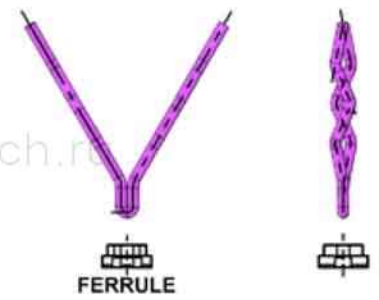

FERRULE

THESE ANCHORS CAN BE GUNWELDED TO THE STEEL CASING

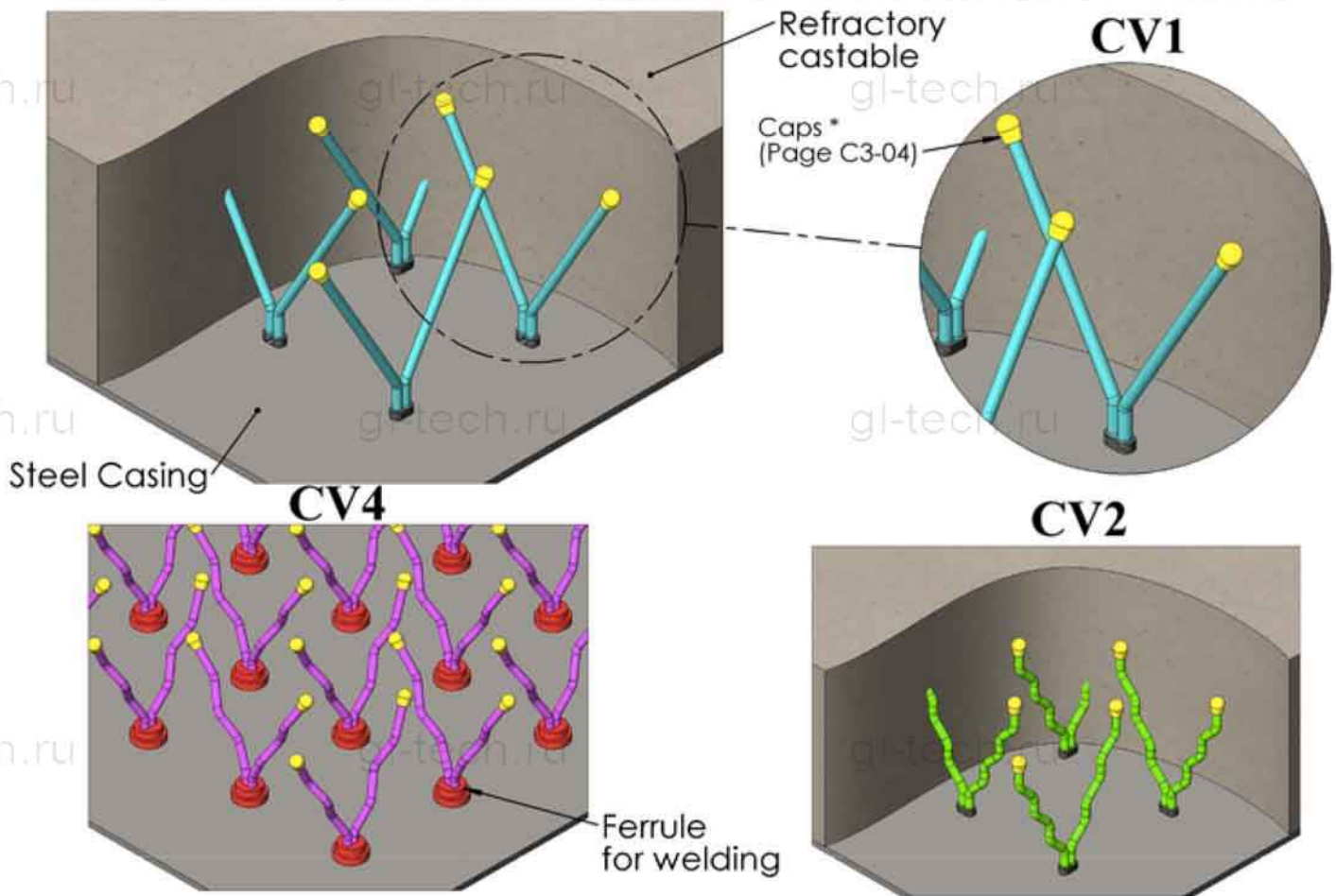

IRIS manufactures anchors from cold drawn wires, with a specific tensile strength, using a "soft bending technique", utilizing robotic machines. This "in house" developed technology, reduces mechanical stress in the steel structure and avoids the formation of micro cracks, through which corrosion can accelerate and damage the anchors. Due to the advanced bending methods developed by IRIS, there are mostly no bending marks in our metal anchors



IRIS - Industrial Refractories & Insulating Specialities
 Parc d'Activités Aérodrome Ouest - Rouvignies - F - 59328 VALENCIENNES Cedex (France)

Tél : +33 (0)3.27.21.52.80
 E-mail: contact@irisfrance.com

Fax : +33 (0)3.27.21.52.99
 Web: www.irisfrance.com

This drawing is the property of IRIS. Unauthorised use of patented features and/or reproduction of this drawing is strictly prohibited

DESIGNATION EXAMPLE

CV1.6(60) - 125 - 304

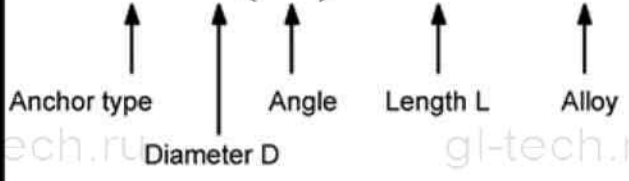

CV 1

OPTION CAPS:

UV.6(80/90)- 050/040 - 309 -C

Polyethylene caps on top of anchors allow to avoid stress and possible cracks, spalling due to the thermal expansion of steel higher than castable expansion

N.B: basic plastic is mainly PVC. C is chlorine which is not good for the CaO of the castable



OPTION LENGHT L1+L2

For unequal legs

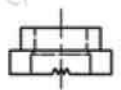
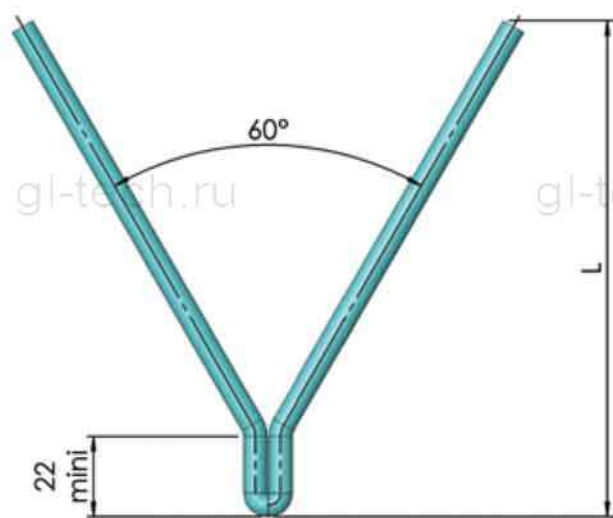
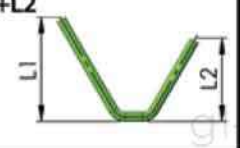

Ferrule: FER-105-000 for Ø5mm
 FER-126-000 for Ø6mm
 FER-168-000 for Ø8mm

**Sketch not contractual*

IRIS manufactures anchors from cold drawn wires, with a specific tensile strength, using a "soft bending technique", utilizing robotic machines. This "in house" developed technology, reduces mechanical stress in the steel structure and avoids the formation of micro cracks, through which corrosion can accelerate and damage the anchors. Due to the advanced bending methods developed by IRIS, there are mostly no bending marks in our metal anchors

OPTIONS

The aluminium ball (AB) is recommended for gun welding.

CV 1.AB

CV 4.AB



Ferrule FER-126-000 for Ø6mm
 FER-168-000 for Ø8mm

EXAMPLE DESIGNATION:
 CV1.6(60) - 080(22) - 310 - AB

Aluminium ball optional (AB), on request makes gun welding easier

DESIGNATION EXAMPLE

CV2.6(80) - 125 - 310

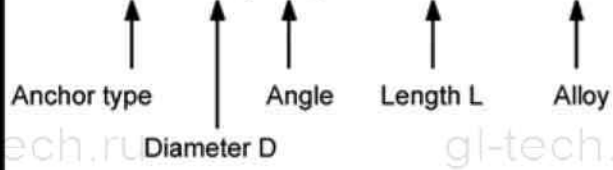

CV 2

OPTION CAPS:

UV.6(80/90)- 050/040 - 309 -C

Polyethylene caps on top of anchors allow to avoid stress and possible cracks, spalling due to the thermal expansion of steel higher than castable expansion

N.B: basic plastic is mainly PVC.
C is chlorine which is not good for the CaO of the castable

OPTION LENGHT L1+L2

For unequal legs

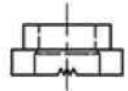
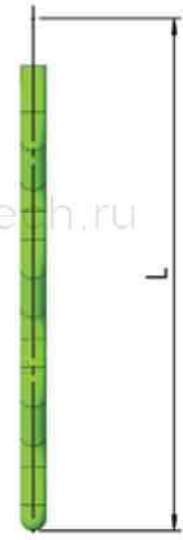
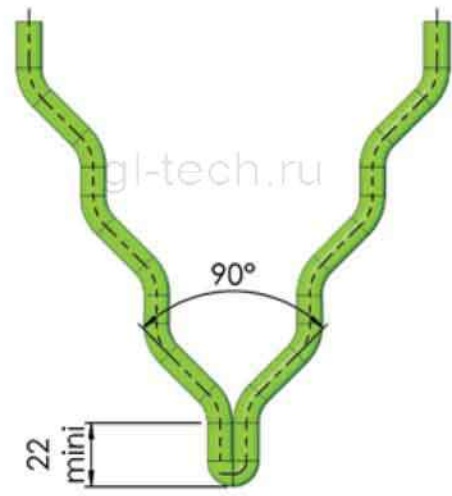
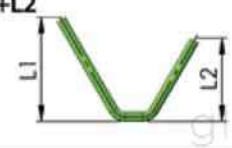

Ferrule: FER-105-000 for Ø5mm
FER-126-000 for Ø6mm
FER-168-000 for Ø8mm

**Sketch not contractual*

IRIS manufactures anchors from cold drawn wires, with a specific tensile strength, using a "soft bending technique", utilizing robotic machines. This "in house" developed technology, reduces mechanical stress in the steel structure and avoids the formation of micro cracks, through which corrosion can accelerate and damage the anchors. Due to the advanced bending methods developed by IRIS, there are mostly no bending marks in our metal anchors

OPTIONS

The aluminium ball (AB) is recommended for gun welding.

CV 1.AB

CV 4.AB



Aluminium ball



Ferrule FER-126-000 for Ø6mm
FER-168-000 for Ø8mm

EXAMPLE DESIGNATION:
CV1.6(60) - 080(22) - 310 - AB

Aluminium ball optional (AB), on request makes gun welding easier

DESIGNATION EXAMPLE

CV4.6(60) - 150 - 304

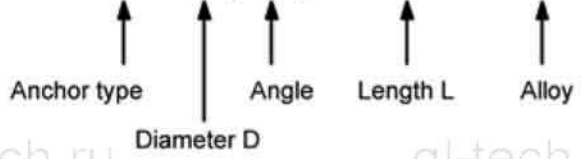

CV 4

OPTION CAPS:

UV.6(80/90)- 050/040 - 309 -C

Polyethylene caps on top of anchors allow to avoid stress and possible cracks, spalling due to the thermal expansion of steel higher than castable expansion

N.B: basic plastic is mainly PVC.
C is chlorine which is not good for the CaO of the castable



OPTION LENGHT L1+L2

For unequal legs

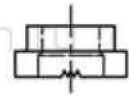
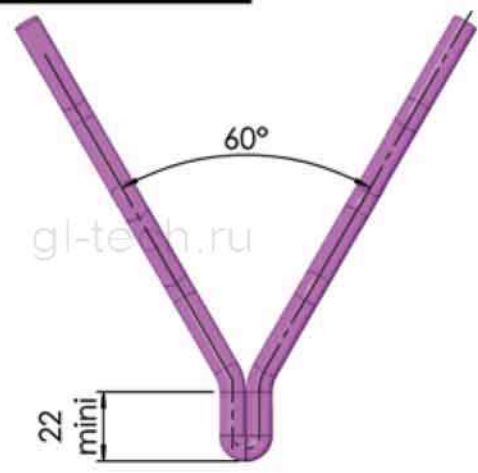
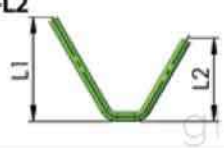

Ferrule: FER-105-000 for Ø5mm
FER-126-000 for Ø6mm
FER-168-000 for Ø8mm

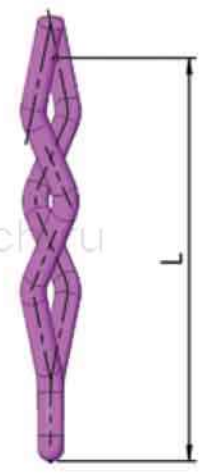

**Sketch not contractual*

IRIS manufactures anchors from cold drawn wires, with a specific tensile strength, using a "soft bending technique", utilizing robotic machines. This "in house" developed technology, reduces mechanical stress in the steel structure and avoids the formation of micro cracks, through which corrosion can accelerate and damage the anchors. Due to the advanced bending methods developed by IRIS, there are mostly no bending marks in our metal anchors

OPTIONS

The aluminium ball (AB) is recommended for gun welding.

CV 1.AB



CV 4.AB

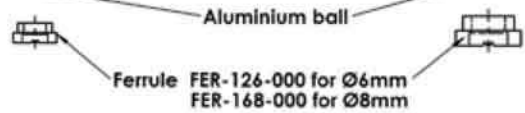

Ferrule FER-126-000 for Ø6mm
FER-168-000 for Ø8mm

EXAMPLE DESIGNATION:
CV1.6(60) - 080(22) - 310 - AB

Aluminium ball optional (AB), on request makes gun welding easier