

# Eclipse Self - Self-closing kit with covers for doors

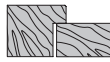

## Description

Kit with one hinge with self-closing device and one hinge without self-closing device with specific covers. Hinges are reversible for flush doors with 135° opening.

The door closing can be controlled adjusting the speed of closing and the power of the final kick to oppose gaskets resistance or depression created into the room.

## Application

The hinge has been tested for a

capacity of 80 kg (door dimensions: 1200x2100 mm).

Follow the procedure on the capacity diagram for the maximum dimensions of the possible sash.

## Fastening

Mill the sash and the frame as indicated in the picture.

Follow the fastening procedure of the sash to the frame.

- Screws for frame part: Ø 5x30 mm
- Screws for sash part: Ø 5x50 mm

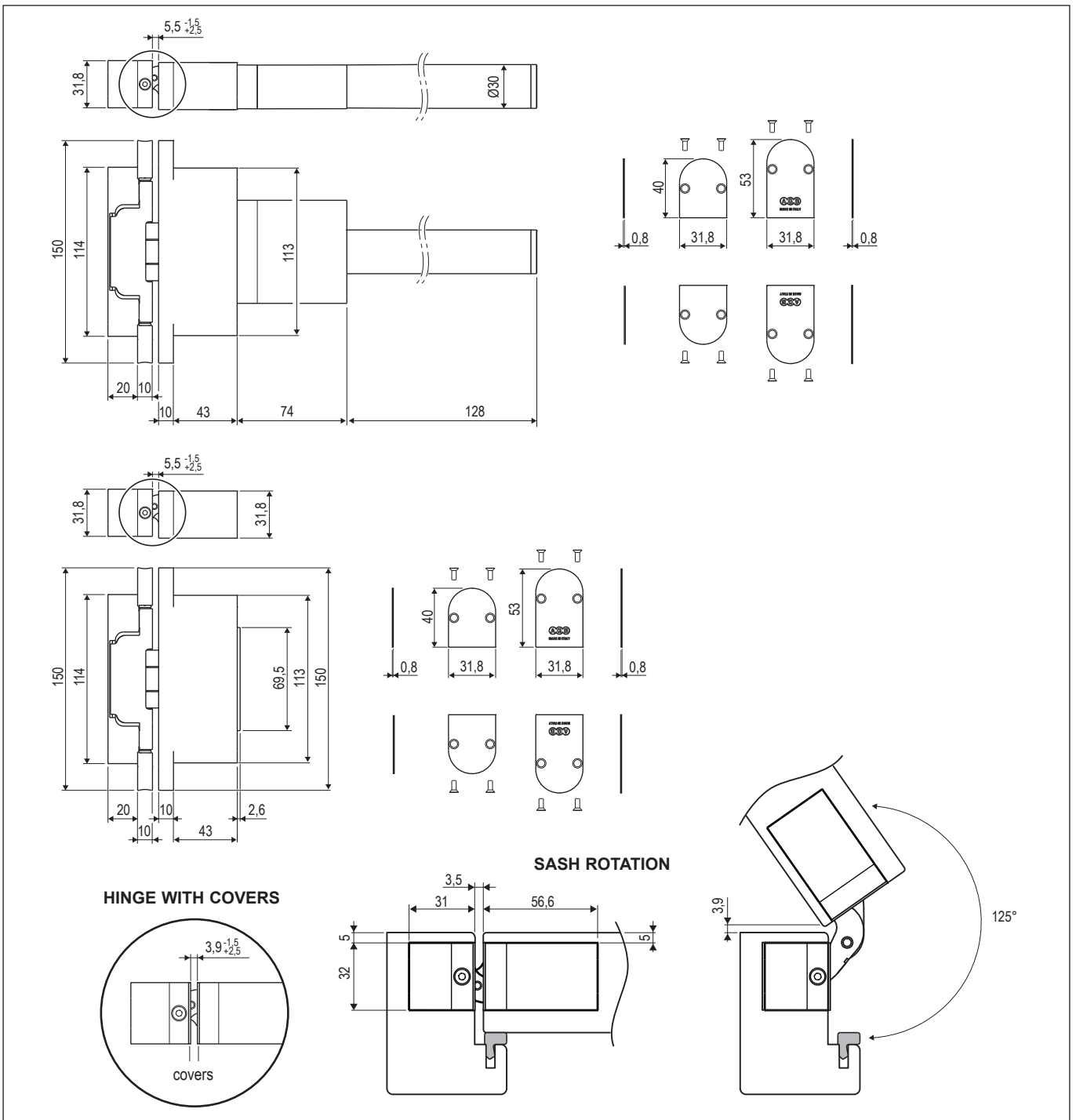

# Eclipse Self - Self-closing kit with covers for doors

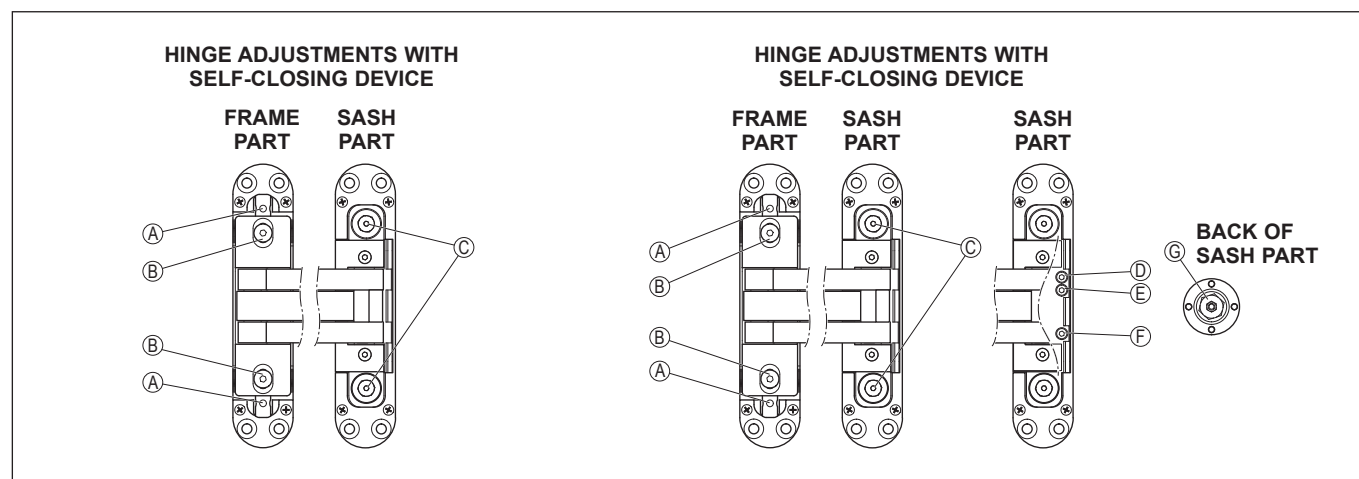
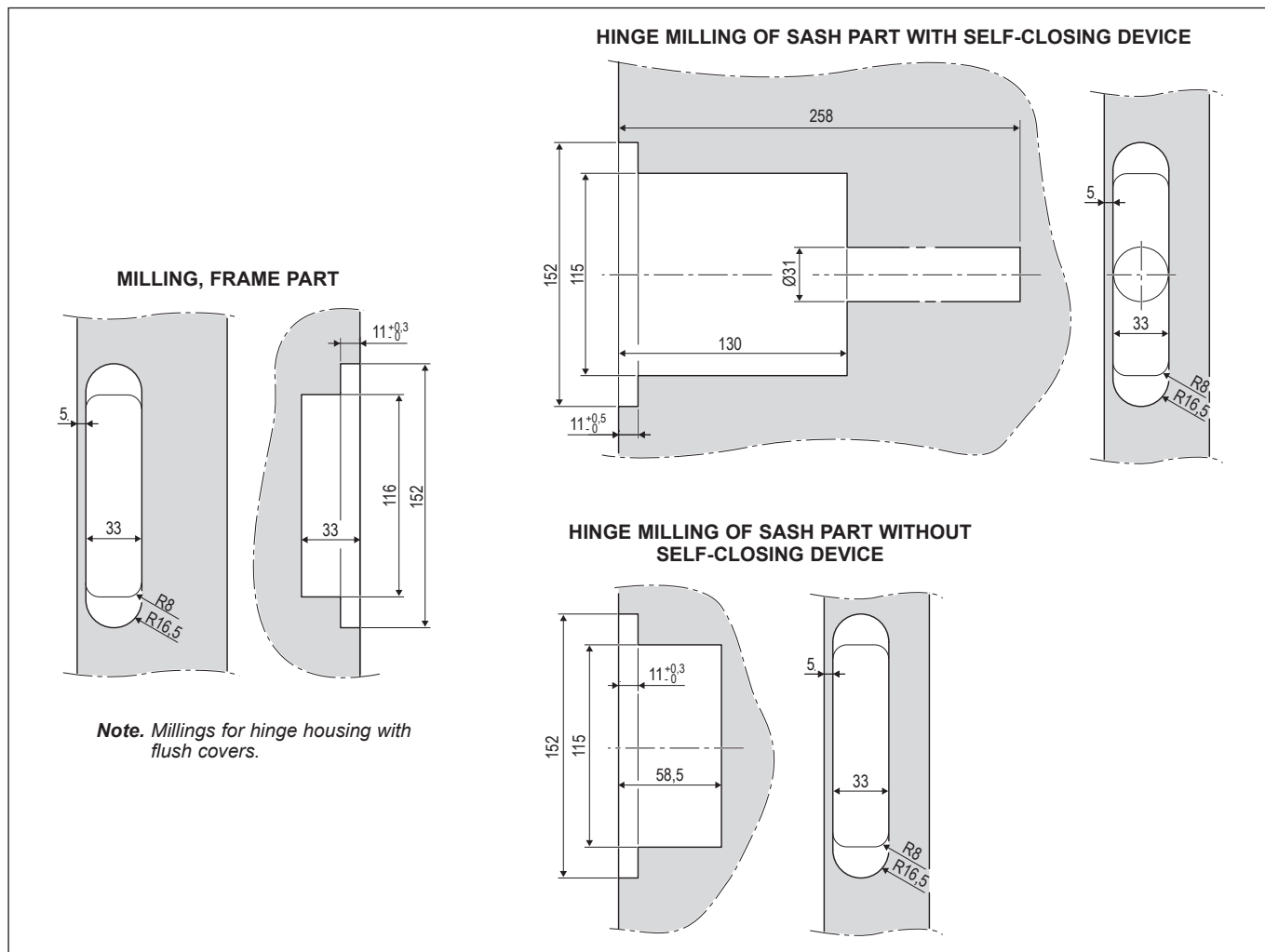

## Adjustments

The hinge can be adjusted in three ways:

- A vertical  $\pm 2$  mm, with a 3 mm Allen key;
- B pressure  $\pm 1$  mm, with a 3 mm Allen key;
- C horizontal  $\pm 2$  mm, with a 2.5 mm or 8 mm Allen key.

The door closing can be adjusted as follows:

- D power of the final step in the last  $12^\circ$  with a 2,5 mm Allen key;
- E maximum opening corner with a 2,5 mm Allen key;
- F speed of closing with a 2,5 mm Allen key;
- G speed of closing during rotation with a 12 mm.

This adjustment can be done only before installing the hinge; from the starting position, please never turn in counterclockwise.

## Order Specifications

Article	Description
E39001.01.XX	Self-closing kit with covers for doors