



JUEGOS DE REPARACIÓN PARA:

- Pinzas de freno
- Bombas de freno y embrague

CATÁLOGO GENERAL
EDICIÓN ARGENTINA | 2013



2013



www.seinsa.es



INDICE DE MARCAS

ALFA ROMEO

ALFA 145,146	3
ALFA 155.....	3

AUDI

A 3	3
-----------	---

GENERAL MOTORS

ASTRA.....	3
C-10.....	3
C-20, D-20.....	3
CHEVY	3
COMBO.....	3
CORSA.....	3
LUV	3
OPEL K180.....	3
SILVERADO	3
TIGRA	3
VECTRA.....	3

CHRYSLER

CORONADO.....	4
---------------	---

CITROËN

BERLINGO	4
ZX.....	4

DODGE

1500	4
1800	4
CORONADO.....	4
GT	4
GTX	4
RT	4

FIAT

128	4
133	4
147	5
1500 (FIAT)	5
124, 125 (FIAT)	5
DUCATO	5
DUNA	5
PALIO	5
REGATA	5
SIENA	5
SPAZIO	5
TEMPRA	5
TIPO.....	5
UNO.....	5

FORD

BRONCO.....	6
COURIER	6
ECOSPORT	6
ESCORT	6
ESCORT, ORION	6

EXPLORER	6
F-100	6
F-150	6
F-250	6
F-350	6
F-1000	6
F-4000	6
FAIRLANE	6
FALCON	7
FIESTA	7
FOCUS	7
GALAXY	7
KA	7
ORION I.....	7
RANGER PICK UP	7
SIERRA	7
TAUNUS	7
TRANSIT	7

GROSSPAL

GROSSPAL	7
----------------	---

ISUZU

AMIGO	8
PICK UP	8
RODEO	8
TROOPER	8

IVECO

DAILY	8
-------------	---

LADA

VARIOS MODELOS	8
----------------------	---

LAND ROVER

METRO	8
-------------	---

MERCEDES

180	8
SPRINTER (BM901-902)	8

NISSAN

ALMERA	8
MAXIMA	8
MICRA	8
PRIMERA	8

OPEL

COMBO	9
CORSA MEXICO	9
K180	9

PEUGEOT

205	9
206	9
306	9
404	9

405	9
406	9
504	9
505	9
BOXER	9
PARTNER	10
T5B	10
T6B	10

RENAULT

CLIO	10
EXPRESS	10
LAGUNA	10
MEGANE	10
R11	10
R12	10
R18	10
R19 I	10
R21, NEVADA	11
RAMBLER	11
RODEO	11
TORINO	11
TRAFIC	11

SEAT

IBIZA	11
LEON	11
TOLEDO	11

SKODA

OCTAVIA.....	11
--------------	----

TATA

TATA.....	11
-----------	----

VOLKSWAGEN

1500 / 1800	12
BORA	12
CADDY	12
CARAT	12
COUNTRY	12
GACEL	12
GOL	12
GOLF	12
JETTA	12
KOMBI	12
NEW BEETLE	12
PASSAT	12
POINTER	12
POLO	12
QUANTUM	12
SANTANA	13
SAVEIRO	13
TRANSPORTER.....	13



∅
(mm)

VERSION



ALFA ROMEO

1

ALFA 145,146

145, 146 1.7 16V Spider	Reparación Caliper Delantero	MN	95>>	48	LUCAS	D4110
-------------------------	------------------------------	----	------	----	-------	-------

ALFA 155

1.7 16V Spider	Reparación Caliper Delantero	MN	95>>	48	LUCAS	D4110
----------------	------------------------------	----	------	----	-------	-------

AUDI

1

A3

ALL TYPES	Reparación Caliper Delantero	MN		54	ATE	D4195
-----------	------------------------------	----	--	----	-----	-------

GENERAL MOTORS

1

ASTRA

ALL TYPES	Cilindro Maestro	MN		20,6	ATE/BENDIX	D1812
-----------	------------------	----	--	------	------------	-------

C-10

ALL TYPES	Cilindro Maestro	MN	82>>	25,4		D1808
-----------	------------------	----	------	------	--	-------

ALL TYPES	Cilindro Maestro	MN	67>>	25,4	BX	D1817
-----------	------------------	----	------	------	----	-------

ALL TYPES	Reparación Caliper Delantero	MN		78,6		D41536
-----------	------------------------------	----	--	------	--	--------

C-20, D-20

ALL TYPES	Cilindro Maestro	MN	93>>	28,6		D1880
-----------	------------------	----	------	------	--	-------

CHEVY

ALL TYPES	Cilindro Maestro	MN	70>>	25,4	BX	D1817
-----------	------------------	----	------	------	----	-------

COMBO

ALL TYPES	Cilindro Maestro	MN	94>>	20,6	ATE/BENDIX	D1812
-----------	------------------	----	------	------	------------	-------

ALL TYPES	Cilindro Maestro	MN		20,6		D1874
-----------	------------------	----	--	------	--	-------

CORSA

ALL TYPES	Cilindro Maestro	MN	94>>	20,6	ATE/BENDIX	D1812
-----------	------------------	----	------	------	------------	-------

ALL TYPES	Cilindro Maestro	MN		20,6		D1874
-----------	------------------	----	--	------	--	-------

LUV

ALL TYPES	Cilindro Maestro	MN	92>>	23,8	SR-33	D1878
-----------	------------------	----	------	------	-------	-------

OPEL K180

ALL TYPES	Cilindro Maestro	MN		20,6	TENSA	D1834
-----------	------------------	----	--	------	-------	-------

SILVERADO

ALL TYPES	Cilindro Maestro	MN	93>>	28,6		D1880
-----------	------------------	----	------	------	--	-------

TIGRA

ALL TYPES	Cilindro Maestro	MN	94>>	20,6	ATE/BENDIX	D1812
-----------	------------------	----	------	------	------------	-------

ALL TYPES	Cilindro Maestro	MN		20,6		D1874
-----------	------------------	----	--	------	--	-------

VECTRA

ALL TYPES	Cilindro Maestro	MN	94>>	20,6	ATE/BENDIX	D1812
-----------	------------------	----	------	------	------------	-------



∅
(mm)

VERSION



CHRYSLER

1

CORONADO

	ALL TYPES	Cilindro Maestro	MN	73>>80	20,6	TENSA	D1834
	ALL TYPES	Reparación Caliper Delantero	MN		40	LUCAS	D4124

CITROËN

1

BERLINGO

	ALL TYPES	Cilindro Maestro	MN	95>>	23,8	BENDIX	D1830
--	-----------	------------------	----	------	------	--------	-------

ZX

	ALL TYPES	Cilindro Maestro	MN		20,6	ATE/BENDIX	D1812
--	-----------	------------------	----	--	------	------------	-------

DODGE

1

1500

	ALL TYPES	Cilindro Maestro	MN	78>>	22,2	SR-33	D1819
	ALL TYPES	Cilindro Maestro	MN	78>>	19	BENDIX	D1824
	ALL TYPES	Cilindro Maestro	MN	77>>	19	TENSA	D1828
	ALL TYPES	Reparación Caliper Delantero	MN		40	LUCAS	D4124
	ALL TYPES	Reparación Caliper Delantero	MN	75>>78	50,8	TSA	D4901

1800

	ALL TYPES	Cilindro Maestro	MN	78>>	22,2	SR-33	D1819
	ALL TYPES	Cilindro Maestro	MN	78>>	19	BENDIX	D1824
	ALL TYPES	Cilindro Maestro	MN	77>>	19	TENSA	D1828
	ALL TYPES	Reparación Caliper Delantero	MN		40	LUCAS	D4124
	ALL TYPES	Reparación Caliper Delantero	MN	75>>78	50,8	TSA	D4901

CORONADO

	ALL TYPES	Reparación Caliper Delantero	MN		50,8	TSA	D4901
--	-----------	------------------------------	----	--	------	-----	-------

GT

	ALL TYPES	Reparación Caliper Delantero	MN		50,8	TSA	D4901
--	-----------	------------------------------	----	--	------	-----	-------

GTX

	ALL TYPES	Reparación Caliper Delantero	MN		50,8	TSA	D4901
--	-----------	------------------------------	----	--	------	-----	-------

RT

	ALL TYPES	Reparación Caliper Delantero	MN		50,8	TSA	D4901
--	-----------	------------------------------	----	--	------	-----	-------

FIAT

1 2

128

	ALL TYPES	Cilindro Maestro	MN	71>>84	19	TENSA	D1868
	ALL TYPES	Cilindro Maestro	MN	71>>84	19	TENSA	D1871

133

	ALL TYPES	Cilindro Maestro	MN	71>>84	19	TENSA	D1868
	ALL TYPES	Cilindro Maestro	MN	71>>84	19	TENSA	D1871

0
(mm)

VERSION

**FIAT****1 2**

147						
	ALL TYPES	Cilindro Maestro	MN	87>>	20,6	BENDIX D1876
	ALL TYPES	Reparación Caliper Delantero	MN		48	ATE-LUCAS D4130
1500 (FIAT)						
	ALL TYPES	Reparación Caliper Delantero	MN		34	LUCAS D4125
124, 125 (FIAT)						
	ALL TYPES	Cilindro Maestro	MN	71>>84	19	TENSA D1868
	ALL TYPES	Cilindro Maestro	MN	71>>84	19	TENSA D1871
	125	Reparación Caliper Delantero	MN		34	LUCAS D4125
DUCATO						
	1.9 D, 1.9 TD, 2.5 D, 2.5 TD	Cilindro Maestro	MN	95>>	23,8	BENDIX D1877
	2.5 D, 2.5 TD 18Q	Cilindro Maestro	MN	95>>	25,4	BENDIX D1815
	ALL TYPES	Cilindro Maestro	MN	94>>	22,2	BENDIX D1867
DUNA						
	ALL TYPES	Cilindro Maestro	MN	94>>	20,6	ATE/BENDIX D1812
	ALL TYPES	Reparación Caliper Delantero	MN		48	TOKICO D4293
	ALL TYPES	Reparación Caliper Delantero	MN		48	ATE D4900
PALIO						
	ALL TYPES	Cilindro Maestro	MN	97>>	20,6	ATE/BENDIX D1812
	ALL TYPES	Cilindro Maestro	MN	98>>	22,2	D1870
	ALL TYPES	Reparación Caliper Delantero	MN		48	ATE D4900
REGATA						
	ALL TYPES	Cilindro Maestro	MN	85>>89	19	TENSA D1868
	ALL TYPES	Cilindro Maestro	MN	71>>84	19	TENSA D1871
	ALL TYPES	Reparación Caliper Delantero	MN		48	ATE D4900
SIENA						
	ALL TYPES	Cilindro Maestro	MN	98>>	22,2	D1870
	ALL TYPES	Reparación Caliper Delantero	MN		48	ATE D4900
SPAZIO						
	ALL TYPES	Cilindro Maestro	MN	87>>	20,6	BENDIX D1876
	ALL TYPES	Reparación Caliper Delantero	MN		48	ATE-LUCAS D4130
TEMPRA						
	ALL TYPES	Reparación Caliper Delantero	MN		48	ATE D4900
TIPO						
	ALL TYPES	Reparación Caliper Delantero	MN		48	ATE D4900
UNO						
	ALL TYPES	Cilindro Maestro	MN	94>>	20,6	ATE/BENDIX D1812
	ALL TYPES	Reparación Caliper Delantero	MN		48	TOKICO D4293
	ALL TYPES	Reparación Caliper Delantero	MN		48	ATE D4900

0
(mm)

VERSION

**FORD**

1 2

BRONCO

ALL TYPES	Reparación Caliper Delantero	MN	85>>	78,7		D4902
-----------	------------------------------	----	------	------	--	-------

COURIER

ALL TYPES	Cilindro Maestro	MN	93>>	22,2		D1816
ALL TYPES	Cilindro Maestro	MN	93>>	23,8	P/SR0466	D1879

ECOSPORT

ALL TYPES	Reparación Caliper Delantero	MN		54		D4101
ALL TYPES	Reparación Caliper Delantero	MN		54	ATE	D41561
ALL TYPES	Reparación Caliper Delantero	MN		48	ATE	D4900

ESCORT

ALL TYPES	Cilindro Maestro	MN		22	BX	D1821
ALL TYPES	Reparación Caliper Delantero	MN		54		D4101

ESCORT, ORION

ALL TYPES	Cilindro Maestro	MN		23,8	BENDIX	D1830
ALL TYPES	Cilindro Maestro	MN		22,2	TSA	D1831
ALL TYPES	Reparación Caliper Delantero	MN	84>>	54	ATE	D41561

EXPLORER

ALL TYPES	Reparación Caliper Delantero	MN	85>>	78,7		D4902
-----------	------------------------------	----	------	------	--	-------

F-100

ALL TYPES	Cilindro Maestro	MN	85>>	25,4		D1808
ALL TYPES	Cilindro Maestro	MN	93>>	28,6		D1809
ALL TYPES	Cilindro Maestro	MN	85>>	25,4	TSA	D1827
ALL TYPES	Reparación Caliper Delantero	MN	85>>	78,7		D4902
DUTY XLT	Reparación Caliper Delantero	MN		54		D41532

F-150

ALL TYPES	Cilindro Maestro	MN	85>>	25,4		D1808
ALL TYPES	Cilindro Maestro	MN	93>>	28,6		D1809
ALL TYPES	Cilindro Maestro	MN	85>>	25,4	TSA	D1827
ALL TYPES	Reparación Caliper Delantero	MN	85>>	78,7		D4902

F-250

DUTY XLT	Reparación Caliper Delantero	MN		54		D41532
----------	------------------------------	----	--	----	--	--------

F-350

DUTY XLT	Reparación Caliper Delantero	MN		54		D41532
----------	------------------------------	----	--	----	--	--------

F-1000

ALL TYPES	Cilindro Maestro	MN	92>>	28,6		D1806
ALL TYPES	Cilindro Maestro	MN	93>>	28,6		D1809
ALL TYPES	Reparación Caliper Delantero	MN	93>>	54		D4903

F-4000

ALL TYPES	Cilindro Maestro	MN	92>>	28,6		D1806
ALL TYPES	Cilindro Maestro	MN	93>>	28,6		D1809

FAIRLANE

ALL TYPES	Cilindro Maestro	MN	69>>	25,4	BX	D1817
-----------	------------------	----	------	------	----	-------

0
(mm)

VERSION

**FORD**

1 2

FALCON

ALL TYPES	Cilindro Maestro	MN	82>>	22,2	TSA	D1810
ALL TYPES	Cilindro Maestro	MN	82>>	22		D1829

FIESTA

ALL TYPES	Cilindro Maestro	MN		22,2		D1816
ALL TYPES	Cilindro Maestro	MN	96>>	23,8	P/SR0466	D1879
ALL TYPES	Reparación Caliper Delantero	MN		54		D4101
ALL TYPES	Reparación Caliper Delantero	MN		54	ATE	D41561
ALL TYPES	Reparación Caliper Delantero	MN		48	ATE	D4900

FOCUS

ALL TYPES	Cilindro Maestro	MN	01>>	23,8	BENDIX	D1830
ALL TYPES	Reparación Caliper Delantero	MN		54		D4101
ALL TYPES	Reparación Caliper Delantero	MN		54	ATE	D41561
ALL TYPES	Reparación Caliper Delantero	MN		48	ATE	D4900

GALAXY

ALL TYPES	Cilindro Maestro	MN	95>>	20,6		D1820
ALL TYPES	Reparación Caliper Delantero	MN		48	ATE	D4900

KA

1.3	Cilindro Maestro	MN	97>>99	20,6		D1882
ALL TYPES	Reparación Caliper Delantero	MN		54		D4101
ALL TYPES	Reparación Caliper Delantero	MN		54	ATE	D41561
ALL TYPES	Reparación Caliper Delantero	MN		48	ATE	D4900

ORION I

ALL TYPES	Reparación Caliper Delantero	MN		54		D4101
ALL TYPES	Reparación Caliper Delantero	MN		48	ATE	D4900

RANGER PICK UP

ALL TYPES	Reparación Caliper Delantero	MN	85>>	78,7		D4902
-----------	------------------------------	----	------	------	--	-------

SIERRA

ALL TYPES	Cilindro Maestro	MN	84>>	22	BX	D1821
ALL TYPES	Cilindro Maestro	MN	84>>	22,2	TSA	D1831

TAUNUS

ALL TYPES	Cilindro Maestro	MN	81>>	22,2	TSA	D1833
ALL TYPES	Cilindro Maestro	MN	74>>77	20,6	TENSA	D1834

TRANSIT

ALL TYPES	Cilindro Maestro	MN	95>>	23,8		D1822
-----------	------------------	----	------	------	--	-------

GROSSPAL

1

GROSSPAL

ALL TYPES	Cilindro Maestro	MN	85>>	25,4	TSA	D1827
-----------	------------------	----	------	------	-----	-------

0
(mm)

VERSION

**ISUZU****1****AMIGO**

ALL TYPES	Cilindro Maestro	MN		23,8	SR-33	D1878
-----------	------------------	----	--	------	-------	-------

PICK UP

ALL TYPES	Cilindro Maestro	MN		23,8	SR-33	D1878
-----------	------------------	----	--	------	-------	-------

RODEO

ALL TYPES	Cilindro Maestro	MN		23,8	SR-33	D1878
-----------	------------------	----	--	------	-------	-------

TROOPER

ALL TYPES	Cilindro Maestro	MN		23,8	SR-33	D1878
-----------	------------------	----	--	------	-------	-------

ALL TYPES	Reparación Caliper Trasero	MN		52		D41531
-----------	----------------------------	----	--	----	--	--------

IVECO**1****DAILY**

ALL TYPES	Cilindro Maestro	MN	87>>90	28,6		D1872
-----------	------------------	----	--------	------	--	-------

LADA**1****VARIOS MODELOS**

ALL TYPES	Cilindro Maestro	MN		20,6		D1875
-----------	------------------	----	--	------	--	-------

LAND ROVER**1****METRO**

ALL TYPES	Reparación Caliper Delantero	MN	83>>	48	LUCAS	D41530
-----------	------------------------------	----	------	----	-------	--------

MERCEDES**1****180**

ALL TYPES	Cilindro Maestro	MN		23,8	BENDIX	D1830
-----------	------------------	----	--	------	--------	-------

SPRINTER (BM901-902)

ALL TYPES	Cilindro Maestro	MN	95	23,8	BENDIX	D1830
-----------	------------------	----	----	------	--------	-------

NISSAN**1****ALMERA**

ALL TYPES	Reparación Caliper Trasero	MN		33,9	LUCAS	D41534
-----------	----------------------------	----	--	------	-------	--------

MAXIMA

ALL TYPES	Reparación Caliper Trasero	MN		33,9	LUCAS	D41534
-----------	----------------------------	----	--	------	-------	--------

MICRA

ALL TYPES	Reparación Caliper Delantero	MN		48	LUCAS	D41530
-----------	------------------------------	----	--	----	-------	--------

PRIMERA

ALL TYPES	Reparación Caliper Trasero	MN		33,9	LUCAS	D41534
-----------	----------------------------	----	--	------	-------	--------



∅
(mm)

VERSION



OPEL

1

COMBO

ALL TYPES	Cilindro Maestro	MN		20,6		D1874
-----------	------------------	----	--	------	--	-------

CORSA MEXICO

ALL TYPES	Cilindro Maestro	MN		20,6		D1874
-----------	------------------	----	--	------	--	-------

K180

ALL TYPES	Cilindro Maestro	MN		20,6	TENSA	D1834
-----------	------------------	----	--	------	-------	-------

PEUGEOT

1 2

205

ALL TYPES	Cilindro Maestro	MN		20,6	ATE/BENDIX	D1812
-----------	------------------	----	--	------	------------	-------

ALL TYPES	Reparación Caliper Delantero	MN		48	LUCAS	D4110
-----------	------------------------------	----	--	----	-------	-------

206

ALL TYPES	Cilindro Maestro	MN	99>>	20,6		D1881
-----------	------------------	----	------	------	--	-------

306

ALL TYPES	Cilindro Maestro	MN	96>>	20,6	ATE/BENDIX	D1812
-----------	------------------	----	------	------	------------	-------

ALL TYPES	Cilindro Maestro	MN	99>>	20,6		D1881
-----------	------------------	----	------	------	--	-------

ALL TYPES	Reparación Caliper Delantero	MN		48	TOKICO	D4293
-----------	------------------------------	----	--	----	--------	-------

404

ALL TYPES	Cilindro Maestro	MN		20,6	BX	D1805
-----------	------------------	----	--	------	----	-------

ALL TYPES	Reparación Caliper Delantero	MN		34	LUCAS	D4125
-----------	------------------------------	----	--	----	-------	-------

405

ALL TYPES	Cilindro Maestro	MN		20,6	BX	D1805
-----------	------------------	----	--	------	----	-------

ALL TYPES	Cilindro Maestro	MN		20,6	ATE/BENDIX	D1812
-----------	------------------	----	--	------	------------	-------

ALL TYPES	Reparación Caliper Delantero	MN		48	TOKICO	D4293
-----------	------------------------------	----	--	----	--------	-------

406

1.6 TD, 1.8, 1.9	Cilindro Maestro	MN		23,8	BENDIX	D1830
------------------	------------------	----	--	------	--------	-------

504

ALL TYPES	Cilindro Maestro	MN	81>>	20,6	BX	D1807
-----------	------------------	----	------	------	----	-------

ALL TYPES	Cilindro Maestro	MN	97>>	20,6	ATE/BENDIX	D1812
-----------	------------------	----	------	------	------------	-------

ALL TYPES	Cilindro Maestro	MN	77>>83	20,6		D1823
-----------	------------------	----	--------	------	--	-------

ALL TYPES	Cilindro Maestro	MN	81>>	20,6		D1826
-----------	------------------	----	------	------	--	-------

ALL TYPES	Cilindro Maestro	MN	78>>83	20,6	TENSA	D1834
-----------	------------------	----	--------	------	-------	-------

ALL TYPES	Reparación Caliper Delantero	MN		54	BX-BOSCH	D4123
-----------	------------------------------	----	--	----	----------	-------

ALL TYPES	Reparación Caliper Delantero	MN		34	LUCAS	D4125
-----------	------------------------------	----	--	----	-------	-------

505

ALL TYPES	Cilindro Maestro	MN	81>>	20,6	BX	D1807
-----------	------------------	----	------	------	----	-------

ALL TYPES	Cilindro Maestro	MN	81>>93	20,6		D1826
-----------	------------------	----	--------	------	--	-------

ALL TYPES	Reparación Caliper Delantero	MN	82>>	54	BX-BOSCH	D4123
-----------	------------------------------	----	------	----	----------	-------

ALL TYPES	Reparación Caliper Delantero	MN		34	LUCAS	D4125
-----------	------------------------------	----	--	----	-------	-------

BOXER

1.9 D, 1.9 TD, 2.5 D, 2.5 TD	Cilindro Maestro	MN	95>>	23,8	BENDIX	D1877
------------------------------	------------------	----	------	------	--------	-------

2.5 D, 2.5 TD 18Q	Cilindro Maestro	MN	95>>	25,4	BENDIX	D1815
-------------------	------------------	----	------	------	--------	-------

0
(mm)

VERSION

**PEUGEOT**

1 2

PARTNER

ALL TYPES	Cilindro Maestro	MN	95>>	23,8	BENDIX	D1830
-----------	------------------	----	------	------	--------	-------

T5B

ALL TYPES	Cilindro Maestro	MN		20,6	BX	D1805
-----------	------------------	----	--	------	----	-------

T6B

ALL TYPES	Cilindro Maestro	MN	81>>	20,6	BX	D1807
-----------	------------------	----	------	------	----	-------

ALL TYPES	Cilindro Maestro	MN	77>>83	20,6		D1823
-----------	------------------	----	--------	------	--	-------

ALL TYPES	Cilindro Maestro	MN	81>>	20,6		D1826
-----------	------------------	----	------	------	--	-------

ALL TYPES	Cilindro Maestro	MN	78>>83	20,6	TENSA	D1834
-----------	------------------	----	--------	------	-------	-------

ALL TYPES	Reparación Caliper Delantero	MN		34	LUCAS	D4125
-----------	------------------------------	----	--	----	-------	-------

RENAULT

1 2

CLIO

ALL TYPES	Cilindro Maestro	MN		20,6	ATE/BENDIX	D1812
-----------	------------------	----	--	------	------------	-------

EXPRESS

ALL TYPES	Cilindro Maestro	MN		20,6	ATE/BENDIX	D1812
-----------	------------------	----	--	------	------------	-------

LAGUNA

ALL TYPES	Cilindro Maestro	MN		20,6	ATE/BENDIX	D1812
-----------	------------------	----	--	------	------------	-------

ALL TYPES	Cilindro Maestro	MN	94>>	23,8	BENDIX	D1830
-----------	------------------	----	------	------	--------	-------

MEGANE

ALL TYPES	Cilindro Maestro	MN		20,6	ATE/BENDIX	D1812
-----------	------------------	----	--	------	------------	-------

R11

ALL TYPES	Cilindro Maestro	MN	94>>	20,6	ATE/BENDIX	D1812
-----------	------------------	----	------	------	------------	-------

ALL TYPES	Cilindro Maestro	MN	87>>	19	BX	D1814
-----------	------------------	----	------	----	----	-------

ALL TYPES	Cilindro Maestro	MN	87>>	19	TSA	D1818
-----------	------------------	----	------	----	-----	-------

R12

ALL TYPES	Cilindro Maestro	MN	94>>	20,6	ATE/BENDIX	D1812
-----------	------------------	----	------	------	------------	-------

ALL TYPES	Cilindro Maestro	MN	87>>	19	BX	D1814
-----------	------------------	----	------	----	----	-------

ALL TYPES	Cilindro Maestro	MN	87>>	19	TSA	D1818
-----------	------------------	----	------	----	-----	-------

ALL TYPES	Cilindro Maestro	MN	76>>84	20,6	TENSA	D1834
-----------	------------------	----	--------	------	-------	-------

ALL TYPES	Cilindro Maestro	MN	85>>	20,6	TSA	D1866
-----------	------------------	----	------	------	-----	-------

ALL TYPES	Cilindro Maestro	MN		20,6	BX	D1869
-----------	------------------	----	--	------	----	-------

ALL TYPES	Cilindro Maestro	MN	85>>	20,6	BENDIX	D1876
-----------	------------------	----	------	------	--------	-------

ALL TYPES	Reparación Caliper Delantero	MN	75>>82	50,8	TSA	D4901
-----------	------------------------------	----	--------	------	-----	-------

R18

ALL TYPES	Cilindro Maestro	MN	82>>	20,6	TSA	D1825
-----------	------------------	----	------	------	-----	-------

ALL TYPES	Cilindro Maestro	MN	82>>	20,6	TSA	D1866
-----------	------------------	----	------	------	-----	-------

ALL TYPES	Cilindro Maestro	MN	81>>	20,6	BENDIX	D1876
-----------	------------------	----	------	------	--------	-------

ALL TYPES	Reparación Caliper Delantero	MN	81>>	54	BX-BOSCH	D4123
-----------	------------------------------	----	------	----	----------	-------

R19 I

ALL TYPES	Cilindro Maestro	MN		20,6	BX	D1805
-----------	------------------	----	--	------	----	-------

ALL TYPES	Cilindro Maestro	MN		20,6	ATE/BENDIX	D1812
-----------	------------------	----	--	------	------------	-------

0
(mm)

VERSION

**RENAULT**

1 2

R21, NEVADA

ALL TYPES	Cilindro Maestro	MN	94>>	20,6	BX	D1805
ALL TYPES	Cilindro Maestro	MN	94>>	20,6	ATE/BENDIX	D1812

R9

ALL TYPES	Cilindro Maestro	MN	94>>	20,6	ATE/BENDIX	D1812
ALL TYPES	Cilindro Maestro	MN	87>>	19	BX	D1814
ALL TYPES	Cilindro Maestro	MN	87>>	19	TSA	D1818

RAMBLER

ALL TYPES	Cilindro Maestro	MN	70>>80	20,6	TENSA	D1834
ALL TYPES	Reparación Caliper Delantero	MN		40	LUCAS	D4124

RODEO

ALL TYPES	Cilindro Maestro	MN	86>>	23,8		D1804
ALL TYPES	Cilindro Maestro	MN	99>>	23,8		D1832

TORINO

ALL TYPES	Cilindro Maestro	MN	70>>80	20,6	TENSA	D1834
-----------	------------------	----	--------	------	-------	-------

TRAFIC

ALL TYPES	Cilindro Maestro	MN	86>>	23,8		D1804
ALL TYPES	Cilindro Maestro	MN	99>>	23,8		D1832

SEAT

1

IBIZA

ALL TYPES	Cilindro Maestro	MN	93>>	20,6	ATE/BENDIX	D1812
ALL TYPES	Cilindro Maestro	MN	88>>93	20,6		D1820

LEON

ALL TYPES	Reparación Caliper Delantero	MN		54	ATE	D4195
-----------	------------------------------	----	--	----	-----	-------

TOLEDO

ALL TYPES	Reparación Caliper Delantero	MN		54	ATE	D4195
-----------	------------------------------	----	--	----	-----	-------

SKODA

1

OCTAVIA

ALL TYPES	Reparación Caliper Delantero	MN		54	ATE	D4195
-----------	------------------------------	----	--	----	-----	-------

TATA

1

TATA

ALL TYPES	Cilindro Maestro	MN		23,8		D1804
-----------	------------------	----	--	------	--	-------



∅
(mm)

VERSION



VOLKSWAGEN

1 2

1500/1800

↔ ALL TYPES	Cilindro Maestro	MN	78>>	22,2	SR-33	D1819
↔ ALL TYPES	Cilindro Maestro	MN	78>>	19	BENDIX	D1824
↔ ALL TYPES	Cilindro Maestro	MN	77>>	19	TENSA	D1828

BORA

↻ ALL TYPES	Reparación Caliper Delantero	MN		54	ATE	D4195
-------------	------------------------------	----	--	----	-----	-------

CADDY

↔ ALL TYPES	Cilindro Maestro	MN		22,2	SR-33	D1819
-------------	------------------	----	--	------	-------	-------

CARAT

↔ ALL TYPES	Cilindro Maestro	MN		20,6		D1820
-------------	------------------	----	--	------	--	-------

COUNTRY

↔ ALL TYPES	Cilindro Maestro	MN		20,6		D1820
-------------	------------------	----	--	------	--	-------

GACEL

↔ ALL TYPES	Cilindro Maestro	MN	85>>	20,6	BX	D1811
↔ ALL TYPES	Cilindro Maestro	MN		20,6	TSA	D1813
↔ ALL TYPES	Cilindro Maestro	MN		20,6		D1820
↻ ALL TYPES	Reparación Caliper Delantero	MN		54		D4101
↻ ALL TYPES	Reparación Caliper Delantero	MN		54	ATE	D41561
↻ ALL TYPES	Reparación Caliper Delantero	MN		48	ATE	D4900

GOL

↔ ALL TYPES	Cilindro Maestro	MN		20,6		D1820
-------------	------------------	----	--	------	--	-------

GOLF

↔ ALL TYPES	Cilindro Maestro	MN		20,6	ATE/BENDIX	D1812
↻ ALL TYPES	Reparación Caliper Delantero	MN		54	ATE	D4195

JETTA

↻ ALL TYPES	Reparación Caliper Delantero	MN		54	ATE	D4195
-------------	------------------------------	----	--	----	-----	-------

KOMBI

↔ ALL TYPES	Cilindro Maestro	MN	81>>	23,8		D1804
-------------	------------------	----	------	------	--	-------

NEW BEETLE

↻ ALL TYPES	Reparación Caliper Delantero	MN		54	ATE	D4195
-------------	------------------------------	----	--	----	-----	-------

PASSAT

↔ ALL TYPES	Cilindro Maestro	MN	96>>	20,6	ATE/BENDIX	D1812
-------------	------------------	----	------	------	------------	-------

POINTER

↔ ALL TYPES	Cilindro Maestro	MN		23,8	BENDIX	D1830
↻ ALL TYPES	Reparación Caliper Delantero	MN	97>>	54		D4101
↻ ALL TYPES	Reparación Caliper Delantero	MN	97>>	54	ATE	D41561
↻ ALL TYPES	Reparación Caliper Delantero	MN		48	ATE	D4900

POLO

↔ ALL TYPES	Cilindro Maestro	MN		20,6	ATE/BENDIX	D1812
↔ ALL TYPES	Cilindro Maestro	MN		22,2	SR-33	D1819

QUANTUM

↻ 1.8	Reparación Caliper Delantero	MN		48	ATE	D4900
-------	------------------------------	----	--	----	-----	-------



∅
(mm)

VERSION



VOLKSWAGEN

1 2

SANTANA

 ALL TYPES	Cilindro Maestro	MN	94>>	20,6	ATE/BENDIX	D1812
---	------------------	----	------	------	------------	-------



SAVEIRO



 1.5, 1.6	Reparación Caliper Delantero	MN		48	ATE	D4900
--	------------------------------	----	--	----	-----	-------

TRANSPORTER

 ALL TYPES	Cilindro Maestro	MN		22,2	SR-33	D1819
---	------------------	----	--	------	-------	-------

LISTADO DE KITS Y SUS APLICACIONES

		
D1804	RENAULT	RODEO
	RENAULT	TRAFIC
	TATA	TATA
	VOLKSWAGEN	KOMBI
D1805	PEUGEOT	404
	PEUGEOT	405
	PEUGEOT	T5B
	RENAULT	R19 I
	RENAULT	R21, NEVADA
D1806	FORD	F-1000
	FORD	F-4000
D1807	PEUGEOT	504
	PEUGEOT	505
	PEUGEOT	T6B
D1808	FORD	F-100
	FORD	F-150
	GENERAL MOTORS	C-10
D1809	FORD	F-100
	FORD	F-1000
	FORD	F-150
	FORD	F-4000
D1810	FORD	FALCON
D1811	VOLKSWAGEN	GACEL
D1812	CITROËN	ZX
	FIAT	DUNA
	FIAT	PALIO
	FIAT	UNO
	GENERAL MOTORS	ASTRA
	GENERAL MOTORS	COMBO
	GENERAL MOTORS	CORSA
	GENERAL MOTORS	TIGRA
	GENERAL MOTORS	VECTRA
	PEUGEOT	205
	PEUGEOT	306
	PEUGEOT	405
	PEUGEOT	504
	RENAULT	CLIO
	RENAULT	EXPRESS
	RENAULT	LAGUNA
	RENAULT	MEGANE
	RENAULT	R11
	RENAULT	R12
	RENAULT	R19 I
	RENAULT	R21, NEVADA
	RENAULT	R9
	SEAT	IBIZA
	VOLKSWAGEN	GOLF
	VOLKSWAGEN	PASSAT
	VOLKSWAGEN	POLO
	VOLKSWAGEN	SANTANA
D1813	VOLKSWAGEN	GACEL
D1814	RENAULT	R11
	RENAULT	R12

		
	RENAULT	R9
D1815	FIAT	DUCATO
	PEUGEOT	BOXER
D1816	FORD	COURIER
	FORD	FIESTA
D1817	FORD	FAIRLANE
	GENERAL MOTORS	C-10
	GENERAL MOTORS	CHEVY
D1818	RENAULT	R11
	RENAULT	R12
	RENAULT	R9
D1819	DODGE	1500
	DODGE	1800
	VOLKSWAGEN	1500/1800
	VOLKSWAGEN	CADDY
	VOLKSWAGEN	POLO
	VOLKSWAGEN	TRANSPORTER
D1820	FORD	GALAXY
	SEAT	IBIZA
	VOLKSWAGEN	CARAT
	VOLKSWAGEN	COUNTRY
	VOLKSWAGEN	GACEL
	VOLKSWAGEN	GOL
D1821	FORD	ESCORT
	FORD	SIERRA
D1822	FORD	TRANSIT
D1823	PEUGEOT	504
	PEUGEOT	T6B
D1824	DODGE	1500
	DODGE	1800
	VOLKSWAGEN	1500/1800
D1825	RENAULT	R18
D1826	PEUGEOT	504
	PEUGEOT	505
	PEUGEOT	T6B
D1827	FORD	F-100
	FORD	F-150
	GROSSPAL	GROSSPAL
D1828	DODGE	1500
	DODGE	1800
	VOLKSWAGEN	1500/1800
D1829	FORD	FALCON
D1830	CITROËN	BERLINGO
	FORD	ESCORT, ORION
	FORD	FOCUS
	MERCEDES	180
	MERCEDES	SPRINTER (BM901-902)
	PEUGEOT	406
	PEUGEOT	PARTNER
	RENAULT	LAGUNA
	VOLKSWAGEN	POINTER
D1831	FORD	ESCORT, ORION
	FORD	SIERRA

LISTADO DE KITS Y SUS APLICACIONES

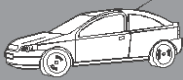
D1832	RENAULT	RODEO
	RENAULT	TRAFIC
D1833	FORD	TAUNUS
D1834	CHRYSLER	CORONADO
	FORD	TAUNUS
	GENERAL MOTORS	OPEL K180
	OPEL	K180
	PEUGEOT	504
	PEUGEOT	T6B
	RENAULT	R12
	RENAULT	RAMBLER
	RENAULT	TORINO
D1866	RENAULT	R12
	RENAULT	R18
D1867	FIAT	DUCATO
D1868	FIAT	128
	FIAT	133
	FIAT	124, 125 (FIAT)
	FIAT	REGATA
D1869	RENAULT	R12
D1870	FIAT	PALIO
	FIAT	SIENA
D1871	FIAT	128
	FIAT	133
	FIAT	124, 125 (FIAT)
	FIAT	REGATA
D1872	IVECO	DAILY
D1874	GENERAL MOTORS	COMBO
	GENERAL MOTORS	CORSA
	GENERAL MOTORS	TIGRA
	OPEL	COMBO
	OPEL	CORSA MEXICO
D1875	LADA	VARIOS MODELOS
D1876	FIAT	147
	FIAT	SPAZIO
	RENAULT	R12
	RENAULT	R18
D1877	FIAT	DUCATO
	PEUGEOT	BOXER
D1878	GENERAL MOTORS	LUV
	ISUZU	AMIGO
	ISUZU	PICK UP
	ISUZU	RODEO
	ISUZU	TROOPER
D1879	FORD	COURIER
	FORD	FIESTA
D1880	GENERAL MOTORS	C-20, D-20
	GENERAL MOTORS	SILVERADO
D1881	PEUGEOT	206
	PEUGEOT	306
D1882	FORD	KA
D4101	FORD	ECOSPORT
	FORD	ESCORT

	FORD	FIESTA
	FORD	FOCUS
	FORD	KA
	FORD	ORION I
	VOLKSWAGEN	GACEL
	VOLKSWAGEN	POINTER
D4110	ALFA ROMEO	ALFA 145,146
	ALFA ROMEO	ALFA 155
	PEUGEOT	205
D4123	PEUGEOT	504
	PEUGEOT	505
	RENAULT	R18
D4124	CHRYSLER	CORONADO
	DODGE	1500
	DODGE	1800
	RENAULT	RAMBLER
D4125	FIAT	1.500. (FIAT)
	FIAT	124, 125 (FIAT)
	PEUGEOT	404
	PEUGEOT	504
	PEUGEOT	505
	PEUGEOT	T6B
D4130	FIAT	147
	FIAT	SPAZIO
D4195	AUDI	A 3
	SEAT	LEON
	SEAT	TOLEDO
	SKODA	OCTAVIA
	VOLKSWAGEN	BORA
	VOLKSWAGEN	GOLF
	VOLKSWAGEN	JETTA
VOLKSWAGEN	NEW BEETLE	
D4293	FIAT	DUNA
	FIAT	UNO
	PEUGEOT	306
	PEUGEOT	405
D4900	FIAT	DUNA
	FIAT	PALIO
	FIAT	REGATA
	FIAT	SIENA
	FIAT	TEMPRA
	FIAT	TIPO
	FIAT	UNO
	FORD	ECOSPORT
	FORD	FIESTA
	FORD	FOCUS
	FORD	GALAXY
	FORD	KA
	FORD	ORION I
	VOLKSWAGEN	GACEL
	VOLKSWAGEN	POINTER
	VOLKSWAGEN	QUANTUM
VOLKSWAGEN	SAVEIRO	

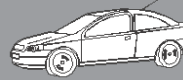
LISTADO DE KITS Y SUS APLICACIONES



D4901	DODGE	1500
	DODGE	1800
	DODGE	CORONADO
	DODGE	GT
	DODGE	GTX
	DODGE	RT
	RENAULT	R12
D4902	FORD	BRONCO
	FORD	EXPLORER
	FORD	F-100
	FORD	F-150
	FORD	RANGER PICK UP
D4903	FORD	F-1000
D41530	LAND ROVER	METRO
	NISSAN	MICRA
D41531	ISUZU	TROOPER
D41532	FORD	F-100
	FORD	F-250
	FORD	F-350
D41534	NISSAN	ALMERA
	NISSAN	MAXIMA
	NISSAN	PRIMERA
D41536	GENERAL MOTORS	C-10
D41561	FORD	ECOSPORT
	FORD	ESCORT, ORION
	FORD	FIESTA
	FORD	FOCUS
	FORD	KA
	VOLKSWAGEN	GACEL
	VOLKSWAGEN	POINTER

COMPOSICIÓN DE LOS KITS DE REPARACIÓN

D1804	0 23,80		D1813	0 20,60		D1821	0 22,00		D1830	0 23,80	
028129	2	METALICAS	02821	2	ARANDELA	02952	2	ARANDELA	028129	2	METALICAS
02993	1	ARANDELA	B1082	1	COPELA	B1051	2	COPELA	B1053	2	COPELA
B1053	2	COPELA	B1127	2	COPELA	B3005	2	COPELA	B2087	1	COPELA
B2060	1	COPELA	B2060	1	COPELA	B6126	2	TAPON DEPOSITO	B2118	1	COPELA
B2118	1	COPELA	B6086	1	JUNTA	D1822	0 23,80		B2182	1	JUNTA
B6115	1	JUNTA	B6185	1	JUNTA	028129	2	METALICAS	B6120	2	TAPON DEPOSITO
D1805	0 20,60		D1814	0 19,00		02993	1	ARANDELA	B6185	1	JUNTA
028130	1	METALICAS	029110	2	METALICAS	B1053	2	COPELA	D1831	0 22,20	
02814	2	ARANDELA	B1044	2	COPELA	B2118	1	COPELA	028137	1	PASADOR
B1041	2	COPELA	B2012	2	COPELA	B6121	2	TAPON DEPOSITO	028138	2	ARANDELA
B2055	1	COPELA	B6120	2	TAPON DEPOSITO	D1823	0 20,60		B1203	2	COPELA
B3045	1	COPELA	D1815	0 25,40		02981	2	ARANDELA	B2171	2	COPELA
B6121	2	TAPON DEPOSITO	02966	2	ARANDELA	B1067	1	JUNTA	B6126	2	TAPON DEPOSITO
B6185	1	JUNTA	B1196	2	COPELA	B1137	2	COPELA	D1832	0 23,80	
D1806	0 28,60		B2087	1	COPELA	B3031	1	COPELA	028129	2	METALICAS
028131	2	METALICAS	B2183	1	JUNTA	B6089	1	JUNTA	B1053	2	COPELA
B1081	2	COPELA	B3030	1	COPELA	B6289	2	JUNTA	B2051	1	COPELA
B2092	2	COPELA	B6185	1	JUNTA	D1824	0 19,00		B2087	1	COPELA
B6286	2	JUNTA	B6328	2	TAPON DEPOSITO	028135	2	METALICAS	B2182	1	JUNTA
D1807	0 20,60		D1816	0 22,20		B1001	1	JUNTA	B6120	2	TAPON DEPOSITO
029100	2	METALICAS	028133	2	ARANDELA	B1204	2	COPELA	B6185	1	JUNTA
B1026	3	COPELA	B1086	2	COPELA	B2146	1	COPELA	D1833	0 22,20	
B3031	1	COPELA	B2038	2	COPELA	B6089	1	JUNTA	028133	2	ARANDELA
B6121	2	TAPON DEPOSITO	B6327	2	TAPON DEPOSITO	D1825	0 20,60		028136	1	METALICAS
D1808	0 25,40		D1817	0 25,40		02821	2	ARANDELA	B1053	1	COPELA
028106	2	METALICAS	02310	2	RESORTE VALVULA	B1116	2	COPELA	B1203	2	COPELA
028132	1	METALICAS	028134	2	VALVULA	B2150	1	COPELA	B2259	2	JUNTA
B1060	2	COPELA	02966	2	ARANDELA	B2192	1	COPELA	B3005	2	COPELA
B2061	2	COPELA	B1060	2	COPELA	B6089	1	JUNTA	D1834	0 20,60	
B6126	2	TAPON DEPOSITO	B2037	1	COPELA	B6122	2	TAPON DEPOSITO	02310	1	RESORTE VALVULA
D1809	0 28,60		B2173	2	COPELA	D1826	0 20,60		028134	1	VALVULA
02987	2	ARANDELA	B6035	2	JUNTA	02821	2	ARANDELA	028136	1	METALICAS
B1081	2	COPELA	D1818	0 19,00		B1116	2	COPELA	028139	4	TAPON DE ESPONJA
B2092	1	COPELA	029100	2	METALICAS	B2150	1	COPELA	028140	1	ARANDELA ESPONJA
B2093	1	COPELA	B1044	2	COPELA	B2192	1	COPELA	028141	1	ARANDELA CIERRE
B6286	2	JUNTA	B2298	2	COPELA	B6089	1	JUNTA	02821	2	ARANDELA
D1810	0 22,20		B6055	3	JUNTA	B6288	2	JUNTA	B1127	2	COPELA
02952	2	ARANDELA	B6083	1	JUNTA	D1827	0 25,40		B1174	2	COPELA
B1203	3	COPELA	B6288	2	JUNTA	02963	2	ARANDELA	B2259	2	JUNTA
B2041	2	COPELA	D1819	0 22,20		B1156	3	COPELA	B3095	1	JUNTA
B6287	1	JUNTA	02952	2	ARANDELA	B2011	1	COPELA	B6035	1	JUNTA
D1811	0 20,60		B1203	2	COPELA	B6126	2	TAPON DEPOSITO	B6055	2	JUNTA
02981	2	ARANDELA	B2038	1	COPELA	D1828	0 19,00		B6229	1	JUNTA
B1026	1	COPELA	B2087	1	COPELA	028136	1	METALICAS	D1866	0 20,60	
B1137	2	COPELA	B2182	1	JUNTA	02993	2	ARANDELA	029100	2	METALICAS
B2060	1	COPELA	B6120	2	TAPON DEPOSITO	B1076	3	COPELA	B1116	2	COPELA
B6148	1	JUNTA	B6185	1	JUNTA	B2298	1	COPELA	B2150	1	COPELA
D1812	0 20,60		D1820	0 20,60		B3057	1	JUNTA	B2192	1	COPELA
02814	2	ARANDELA	02981	2	ARANDELA	D1829	0 22,00		B6122	2	TAPON DEPOSITO
B1041	2	COPELA	B1137	2	COPELA	02805	2	ARANDELA	D1867	0 22,20	
B2087	1	COPELA	B2060	1	COPELA	B1090	2	COPELA	028133	2	ARANDELA
B2182	1	JUNTA	B2192	1	COPELA	B2222	1	COPELA	B1203	2	COPELA
B3045	1	COPELA	B6129	2	TAPON DEPOSITO	B3005	2	COPELA	B2041	1	COPELA
B6121	2	TAPON DEPOSITO	B6185	1	JUNTA	B6089	1	JUNTA	B2060	1	COPELA
B6185	1	JUNTA							B6120	2	TAPON DEPOSITO
									B6185	1	JUNTA

COMPOSICIÓN DE LOS KITS DE REPARACIÓN

D1868	0 19,00	D1877	0 23,80	D4124	0 40,00	D41534	0 33,90					
02983	2	ARANDELA	028129	2	METALICAS	B4256	1	GUARDAPOLVOS				
B1001	1	JUNTA	B1053	2	COPELA	B4257	1	GUARDAPOLVOS				
B1124	2	COPELA	B2087	1	COPELA	B6156	2	JUNTA				
B2298	1	COPELA	B2118	1	COPELA	B6179	1	JUNTA				
B6089	1	JUNTA	B2182	1	JUNTA	B6234	2	JUNTA				
B6327	2	JUNTA	B6185	1	JUNTA	B7001	1	TAPON DE PURGA				
D1869	0 20,60	B6328	2	TAPON DEPOSITO	D4125	0 34,00	D41536	0 78,60				
02669	1	RESORTE	D1878	0 23,80	B4258	1	GUARDAPOLVOS	B4513	1	GUARDAPOLVOS		
028134	1	PURGADOR	028129	2	METALICAS	B4259	1	GUARDAPOLVOS	B6408	1	JUNTA	
02981	2	ARANDELA	B1053	2	COPELA	B6152	1	JUNTA	B7001	1	TAPON DE PURGA	
B1067	1	JUNTA	B2118	1	COPELA	B6153	2	JUNTA	D41561	0 54,00		
B1137	2	COPELA	B6089	1	JUNTA	B7001	1	TAPON DE PURGA	B4733	1	GUARDAPOLVOS	
B2217	1	COPELA	B6327	2	TAPON DEPOSITO	D4130	0 48,00	B6151	1	JUNTA		
B6035	1	JUNTA	D1879	0 23,80	B4238	1	GUARDAPOLVOS					
B6089	1	JUNTA	028132	1	PASADOR	B5051	2	GUARDAPOLVOS				
D1870	0 22,20	02967	2	ARANDELA	B6152	1	JUNTA					
028133	2	ARANDELA	B1053	2	COPELA	B7001	1	TAPON DE PURGA				
B1203	2	COPELA	B2118	1	COPELA	D4195	0 54,00					
B2087	1	COPELA	B2119	1	COPELA	B4284	1	GUARDAPOLVOS				
B2171	1	COPELA	B6327	2	TAPON DEPOSITO	B5069	2	GUARDAPOLVOS				
B2182	1	JUNTA	D1880	0 28,60	B6167	1	JUNTA					
B6120	2	TAPON DEPOSITO	028131	2	ARANDELA	B7001	1	TAPON DE PURGA				
B6162	1	JUNTA	B1081	2	COPELA	D4293	0 48,00					
D1871	0 19,00	B2092	1	COPELA	B4176	1	GUARDAPOLVOS					
028135	2	METALICAS	B2306	1	COPELA	B6152	1	JUNTA				
B1001	1	JUNTA	B6286	2	TAPON DEPOSITO	D4900	0 48,00					
B1124	2	COPELA	D1881	0 20,60	02814	2	ARANDELA					
B2298	1	COPELA	02814	2	ARANDELA	B2025	2	COPELA				
B6089	1	JUNTA	B2025	2	COPELA	B2087	1	COPELA				
B6120	2	TAPON DEPOSITO	B2087	1	COPELA	B3045	1	COPELA				
D1872	0 28,60	B6102	1	JUNTA	B6102	1	JUNTA	D4901	0 50,80			
028131	2	ARANDELA	B6126	2	TAPON DEPOSITO	B6185	1	JUNTA	02901	1	METALICA	
B1081	2	COPELA	B6185	1	JUNTA	D1882	0 20,60	B4157	1	GUARDAPOLVOS		
B2092	1	COPELA	02814	2	ARANDELA	02814	2	ARANDELA	B6158	1	JUNTA	
B2306	1	COPELA	B2025	2	COPELA	B2025	2	COPELA	D4902	0 78,70		
B6328	2	JUNTA	B2087	1	COPELA	B2087	1	COPELA	B4513	2	GUARDAPOLVOS	
D1874	0 20,60	B2111	1	COPELA	B2111	1	COPELA	B6290	2	JUNTA		
023106	1	RESORTE VALVULA	B2183	1	JUNTA	B2183	1	JUNTA	D4903	0 54,00		
02814	2	ARANDELA	B6120	2	TAPON DEPOSITO	B6120	2	TAPON DEPOSITO	B4293	2	GUARDAPOLVOS	
B1050	2	COPELA	B6185	1	JUNTA	B6185	1	JUNTA	B5305	2	GUARDAPOLVOS	
B2063	1	COPELA	D4101	0 54,00	D4101	0 54,00	D41530	0 48,00	B6151	2	JUNTA	
B2166	1	COPELA	B4169	1	GUARDAPOLVOS	B4169	1	GUARDAPOLVOS	B4238	1	GUARDAPOLVOS	
B6327	2	TAPON DEPOSITO	B6151	1	JUNTA	B6151	1	JUNTA	B5092	2	GUARDAPOLVOS	
D1875	0 20,60	B7001	1	TAPON DE PURGA	B7001	1	TAPON DE PURGA	B6152	1	JUNTA		
02981	2	ARANDELA	D4110	0 48,00	D4110	0 48,00	B7001	1	TAPON DE PURGA	D41531	0 52,00	
B1026	1	COPELA	B4176	1	GUARDAPOLVOS	B4176	1	GUARDAPOLVOS	B4159	1	GUARDAPOLVOS	
B1090	2	COPELA	B5051	2	GUARDAPOLVOS	B5051	2	GUARDAPOLVOS	B6162	1	JUNTA	
B3031	1	COPELA	B6152	1	JUNTA	B6152	1	JUNTA	B7001	1	TAPON DE PURGA	
B6327	2	TAPON DEPOSITO	B7001	1	TAPON DE PURGA	B7001	1	TAPON DE PURGA	D41532	0 54,00		
D1876	0 20,60	D4123	0 54,00	B4167	1	GUARDAPOLVOS	B4167	1	GUARDAPOLVOS	B4729	2	GUARDAPOLVOS
029100	2	METALICAS	B4167	1	GUARDAPOLVOS	B5050	4	GUARDAPOLVOS	B5050	4	GUARDAPOLVOS	
B1026	2	COPELA	B5050	4	GUARDAPOLVOS	B6017M	2	JUNTA	B6209	2	JUNTA	
B2041	2	COPELA	B6017M	2	JUNTA	B6151	1	JUNTA	B7001	1	TAPON DE PURGA	
B6122	2	TAPON DEPOSITO	B6151	1	JUNTA	B7001	1	TAPON DE PURGA				

LISTADO DE PIEZAS Y SUS KITS

PIEZA	KIT	PIEZA	KIT	PIEZA	KIT	PIEZA	KIT	PIEZA	KIT	PIEZA	KIT
02310	D1817		D1875	B1156	D1827	B2171	D1831	B4733	D41561		D4130
	D1834	02983	D1868	B1174	D1834		D1870	B5050	D4123		D4293
023106	D1874	02987	D1809	B1196	D1815	B2173	D1817	B5051	D4110		D4900
02669	D1869	02993	D1804	B1203	D1810	B2182	D1812		D4130		D41530
02805	D1829		D1822		D1819		D1819	B5069	D4195	B6153	D4125
02814	D1805		D1828		D1831		D1830	B5082	D41534		D41534
	D1812	029100	D1807		D1833		D1832	B5092	D41530	B6156	D4124
	D1874		D1818		D1867		D1870	B5305	D4903	B6158	D4901
	D1881		D1866		D1870		D1877	B5323	D41532	B6162	D1870
	D1882		D1876	B1204	D1824	B2183	D1815	B6017M	D4123		D41531
02821	D1813	029110	D1814	B2011	D1827		D1882	B6035	D1817	B6167	D4195
	D1825	B1001	D1824	B2012	D1814	B2192	D1820		D1834	B6179	D4124
	D1826		D1868	B2025	D1881		D1825		D1869	B6185	D1805
	D1834		D1871		D1882		D1826	B6055	D1818		D1812
028106	D1808	B1026	D1807	B2037	D1817		D1866		D1834		D1813
028129	D1804		D1811	B2038	D1816	B2217	D1869	B6083	D1818		D1815
	D1822		D1875		D1819	B2222	D1829	B6086	D1813		D1819
	D1830		D1876	B2041	D1810	B2259	D1833	B6089	D1823		D1820
	D1832	B1041	D1805		D1867		D1834		D1824		D1830
	D1877		D1812		D1876	B2298	D1818		D1825		D1832
	D1878	B1044	D1814	B2051	D1832		D1828		D1826		D1867
028130	D1805		D1818	B2055	D1805		D1868		D1829		D1877
028131	D1806	B1050	D1874	B2060	D1804		D1871		D1868		D1881
	D1872	B1051	D1821		D1811	B2306	D1872		D1869		D1882
	D1880	B1053	D1804		D1813		D1880		D1871	B6209	D41532
028132	D1808		D1822		D1820	B3005	D1821		D1878		D1834
	D1879		D1830		D1867		D1829	B6102	D1881	B6229	D1834
028133	D1816		D1832	B2061	D1808		D1833	B6115	D1804	B6234	D4124
	D1833		D1833	B2063	D1874	B3030	D1815	B6120	D1814	B6286	D1806
	D1867		D1877	B2087	D1812		D1807		D1819		D1809
	D1870		D1878		D1815	B3031	D1823		D1830	B6287	D1810
028134	D1817		D1879		D1819		D1875		D1832	B6288	D1818
	D1834	B1060	D1808		D1830	B3045	D1805		D1867		D1826
	D1869		D1817		D1832		D1812		D1870	B6289	D1823
028135	D1824	B1067	D1823		D1870		D1881		D1871	B6290	D4902
	D1871		D1869		D1877	B3057	D1828		D1882	B6327	D1816
028136	D1828	B1076	D1828		D1881	B3095	D1834	B6121	D1805		D1868
	D1833	B1081	D1806		D1882		D4901		D1807		D1874
	D1834		D1809	B2092	D1806		D41531		D1812		D1875
028137	D1831		D1872		D1809		D4123		D1822		D1878
028138	D1831		D1880		D1872		D4101	B6122	D1825		D1879
028139	D1834		D1872		D1880		D4110		D1866	B6328	D1815
028140	D1834	B1082	D1813	B2093	D1809		D4293		D1876		D1872
028141	D1834	B1086	D1816	B2111	D1882	B4185	D4900	B6126	D1808		D1877
02901	D4901	B1090	D1829	B2118	D1804	B4238	D4130		D1821	B6408	D41536
02952	D1810		D1875		D1822		D41530		D1827	B7001	D4101
	D1819	B1116	D1825		D1830	B4256	D4124		D1831		D4110
	D1821		D1826		D1877	B4257	D4124		D1881		D4123
02963	D1827		D1866		D1878	B4258	D4125	B6129	D1820		D4124
02966	D1815	B1124	D1868		D1879	B4259	D4125	B6148	D1811		D4125
	D1817		D1871	B2119	D1879	B4263	D41534	B6151	D4101		D4130
02967	D1879	B1127	D1813	B2146	D1824	B4284	D4195		D4123		D4195
	D1879		D1834	B2150	D1825	B4293	D4903		D41561		D41530
02981	D1811	B1137	D1811		D1826		D4902		D4903		D41531
	D1820		D1820		D1866		D41536	B6152	D4110		D41532
	D1823		D1823	B2166	D1874	B4729	D41532		D4125		D41534
	D1869		D1869								D41536

LISTADO DE PIEZAS Y SU NÚMERO DE FIGURA

PIEZA	FIG.	PÁG.	PIEZA	FIG.	PÁG.	PIEZA	FIG.	PÁG.
02310	M-23	29	B2025	1-60	26	B5305	5-78	28
023106	M-68	29	B2037	1-31	25	B5323	5-109	28
02669	M-23	29	B2038	1-60	26	B6017M	1-1	25
02805	M-17	29	B2041	1-41	25	B6035	1-148	27
02814	M-17	29	B2051	1-72	26	B6055	1-1	25
02821	M-17	29	B2055	1-50	25	B6083	1-1	25
028106	M-17	29	B2060	1-90	26	B6086	1-3	25
028129	M-17	29	B2061	1-72	26	B6089	1-1	25
028130	M-17	29	B2063	1-88	26	B6102	1-1	25
028131	M-17	29	B2087	1-51	25	B6115	1-1	25
028132	M-93	29	B2092	1-87	26	B6120	1-118	27
028133	M-17	29	B2093	1-31	25	B6121	1-117	27
028134	M-25	29	B2111	1-69	26	B6122	1-119	27
028135	M-17	29	B2118	1-69	26	B6126	1-123	27
028136	M-17	29	B2119	1-60	26	B6129	1-118	27
028137	M-94	29	B2146	1-66	26	B6148	1-1	25
028138	M-17	29	B2150	1-66	26	B6151	1-2	25
028139	M-95	29	B2166	1-58	25	B6152	1-2	25
028140	met19	29	B2171	1-69	26	B6153	1-2	25
028141	M-17	29	B2173	1-60	26	B6156	1-2	25
02901	M-6	28	B2182	1-1	25	B6158	1-2	25
02952	M-17	29	B2183	1-1	25	B6162	1-2	25
02963	M-17	29	B2192	1-66	26	B6167	1-2	25
02966	M-17	29	B2217	1-41	25	B6179	1-2	25
02967	M-17	29	B2222	1-105	27	B6185	1-2	25
02981	M-17	29	B2259	1-1	25	B6209	1-2	25
02983	M-17	29	B2298	1-60	26	B6229	1-1	25
02987	M-17	29	B2306	1-105	27	B6234	1-3	25
02993	M-17	29	B3005	1-40	25	B6286	1-118	27
029100	M-96	29	B3030	1-40	25	B6287	1-1	25
029110	M-16	29	B3031	1-40	25	B6288	1-119	25
B1001	1-5	25	B3045	1-60	26	B6289	1-2	25
B1026	1-83	26	B3057	1-1	25	B6290	1-2	25
B1041	1-60	26	B3095	1-1	25	B6327	1-117	27
B1044	1-83	26	B4157	4-32	28	B6328	1-118	27
B1050	1-83	26	B4159	4-20	27	B6408	1-2	25
B1051	1-60	26	B4167	4-27	27	B7001	2-1	27
B1053	1-83	26	B4169	4-7	27			
B1060	1-84	26	B4176	4-9	27			
B1067	1-5	25	B4185	4-7	27			
B1076	1-83	26	B4238	4-9	27			
B1081	1-84	26	B4256	4-39	28			
B1082	1-83	26	B4257	4-38	28			
B1086	1-83	26	B4258	4-39	28			
B1090	1-84	26	B4259	4-38	28			
B1116	1-84	26	B4263	4-9	27			
B1124	1-84	26	B4284	4-7	27			
B1127	1-84	26	B4293	4-46	28			
B1137	1-84	26	B4513	4-62	28			
B1156	1-84	26	B4729	4-9	27			
B1174	1-62	26	B4733	4-7	27			
B1196	1-84	26	B5050	5-65	28			
B1203	1-83	26	B5051	5-51	28			
B1204	1-168	27	B5069	5-61	28			
B2011	1-60	26	B5082	5-52	28			
B2012	1-40	25	B5092	5-52	28			

PIEZAS CLASIFICADAS POR FIGURA

FIGURA 1-1

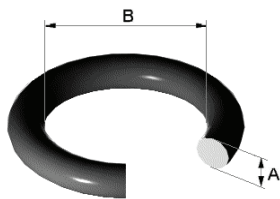

REF.	A	B	C
B6287	1,60	3,10	0,00
B6089	1,80	3,70	0,00
B6055	1,80	5,30	0,00
B6229	2,00	8,00	0,00
B6083	2,00	12,00	0,00
B6017M	2,00	20,00	0,00
B2259	2,00	24,00	0,00
B2183	2,50	30,00	0,00
B2182	2,50	32,00	0,00
B3057	2,60	13,95	0,00
B6148	2,65	36,50	0,00
B3095	2,75	15,10	0,00
B6102	3,50	31,00	0,00
B6115	3,50	39,70	0,00

FIGURA 1-2

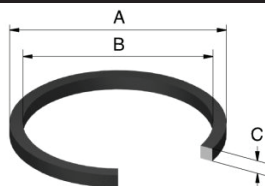

REF.	A	B	C
B6289	23,50	16,75	4,00
B6153	40,50	34,50	3,20
B6162	46,60	41,60	2,50
B6156	46,80	40,90	3,20
B6185	47,40	41,50	3,20
B6152	54,30	48,40	3,20
B6158	57,35	51,45	3,20
B6151	60,10	54,10	3,20
B6209	60,60	54,10	3,20
B6167	61,30	55,20	3,20
B6179	63,40	57,40	3,20
B6290	84,40	78,25	3,20
B6408	84,45	78,55	3,60

FIGURA 1-3

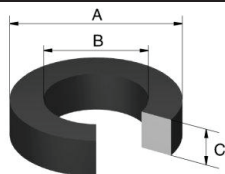

REF.	A	B	C
B6234	12,30	8,45	2,00
B6086	19,10	15,70	1,70

FIGURA 1-5

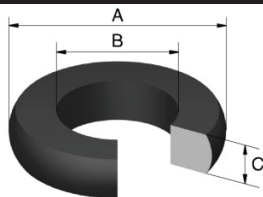

REF.	A	B	C
B1001	19,30	11,00	4,00
B1067	21,00	12,60	4,50

FIGURA 1-31

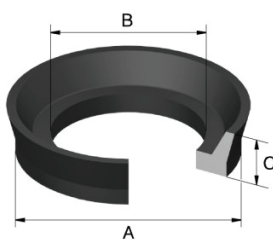

REF.	A	B	C
B2037	23,30	14,30	5,00
B2093	27,10	17,00	6,50

FIGURA 1-40

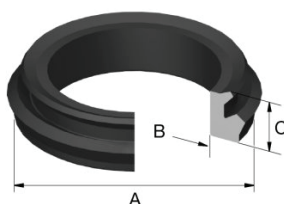

REF.	A	B	C
B2012	18,20	10,30	6,50
B3031	19,20	12,10	6,50
B3005	20,60	13,60	6,40
B3030	24,40	16,40	7,30

FIGURA 1-41

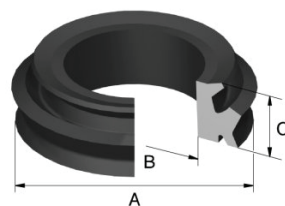

REF.	A	B	C
B2217	19,50	11,40	6,85
B2041	22,20	13,60	6,40

FIGURA 1-50

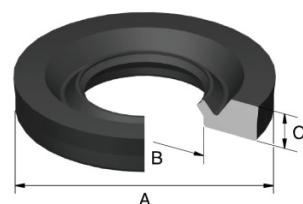

REF.	A	B	C
B2055	34,00	17,80	7,10

FIGURA 1-51

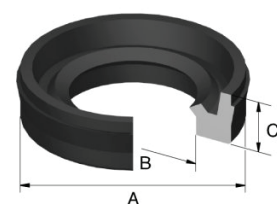

REF.	A	B	C
B2087	28,00	17,70	7,00

FIGURA 1-58

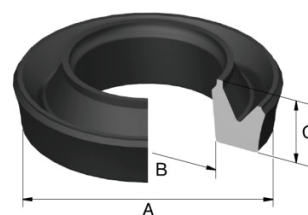

REF.	A	B	C
B2166	19,50	13,20	5,70

PIEZAS CLASIFICADAS POR FIGURA

FIGURA 1-60

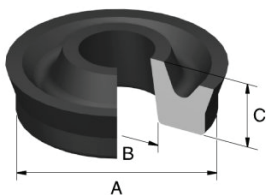

REF.	A	B	C
B2298	17,75	10,70	6,85
B2025	19,20	12,00	5,00
B1041	19,50	11,70	5,00
B3045	20,10	14,00	5,60
B1051	21,40	13,20	5,00
B2038	21,50	15,50	5,50
B2119	23,20	17,30	5,70
B2011	23,70	15,00	8,30
B2173	24,50	15,90	5,70

FIGURA 1-69

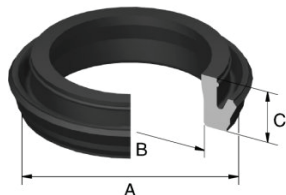

REF.	A	B	C
B2111	19,90	13,90	5,75
B2171	20,90	15,60	5,80
B2118	23,15	17,05	5,80

FIGURA 1-84

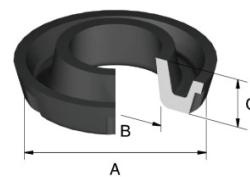

REF.	A	B	C
B1124	18,15	7,70	4,50
B1137	19,40	10,10	4,40
B1116	20,05	10,80	5,00
B1127	20,10	11,90	4,60
B1090	21,10	9,70	4,90
B1196	23,93	10,63	5,00
B1060	24,00	10,70	5,00
B1156	24,50	16,50	5,00
B1081	27,30	14,60	4,60

FIGURA 1-72

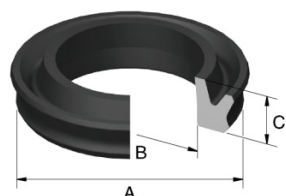

REF.	A	B	C
B2051	23,40	16,90	5,00
B2061	25,50	16,95	5,50

FIGURA 1-62

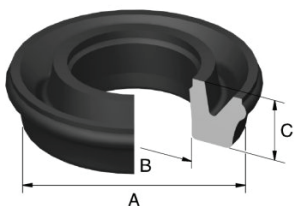

REF.	A	B	C
B1174	19,75	13,90	4,80

FIGURA 1-87

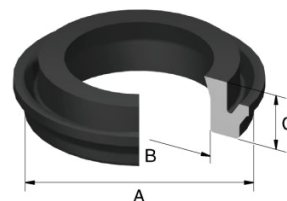

REF.	A	B	C
B2092	27,10	18,50	4,60

FIGURA 1-83

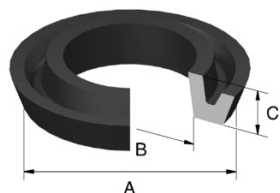

REF.	A	B	C
B1044	17,50	11,00	5,10
B1076	17,70	8,50	5,00
B1050	19,50	12,40	5,40
B1082	19,85	12,80	4,85
B1026	20,00	11,00	5,20
B1203	20,60	14,00	4,80
B1086	20,80	14,00	5,10
B1053	22,20	15,60	5,10

FIGURA 1-66

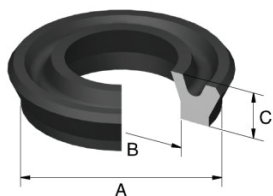

REF.	A	B	C
B2146	18,10	11,40	6,00
B2150	19,60	12,30	6,50
B2192	19,90	12,50	4,50

FIGURA 1-88

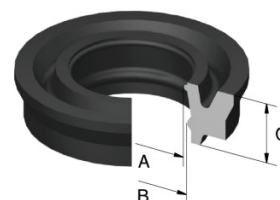

REF.	A	B	C
B2063	12,50	13,50	6,50

FIGURA 1-90

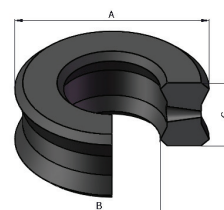

REF.	A	B	C
B2060	25,25	12,60	10,00

PIEZAS CLASIFICADAS POR FIGURA

FIGURA 1-105

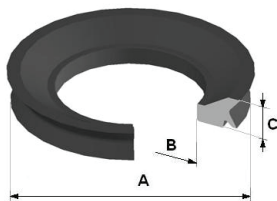

REF.	A	B	C
B2222	22,30	13,70	5,20
B2306	29,20	17,55	5,35

FIGURA 1-117

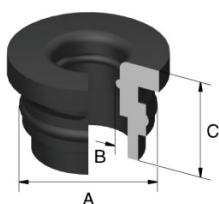

REF.	A	B	C
B6327	22,65	11,00	15,00
B6121	23,00	11,75	18,00

FIGURA 1-118

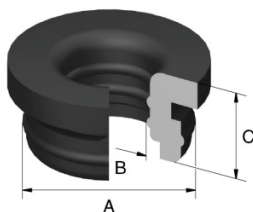

REF.	A	B	C
B6328	17,50	8,05	13,40
B6129	17,90	6,50	12,60
B6120	23,00	11,50	13,00
B6286	26,55	15,95	12,85

FIGURA 1-119

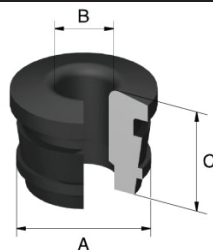

REF.	A	B	C
B6122	20,00	9,00	16,70
B6288	20,35	10,85	15,75

FIGURA 1-123

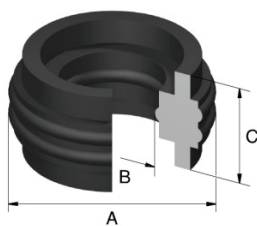

REF.	A	B	C
B6126	23,00	11,30	12,00

FIGURA 1-148

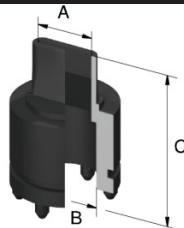

REF.	A	B	C
B6035	1,50	5,50	13,00

FIGURA 1-168

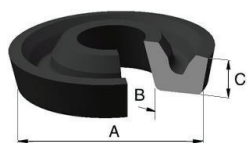

REF.	A	B	C
B1204	18,50	9,05	5,00

FIGURA 2-1

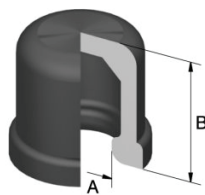

REF.	A	B	C
B7001	5,00	9,00	0,00

FIGURA 4-7

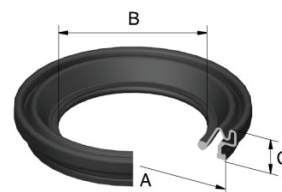

REF.	A	B	C
B4185	55,50	36,70	12,00
B4284	60,40	42,90	13,80
B4733	61,05	44,45	10,50
B4169	62,00	43,00	11,00

FIGURA 4-9

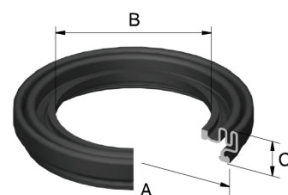

REF.	A	B	C
B4263	41,30	24,50	11,50
B4238	53,95	38,60	11,20
B4176	54,00	36,50	11,00
B4729	61,85	43,25	10,40

FIGURA 4-20

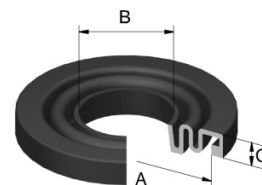

REF.	A	B	C
B4159	50,65	33,95	7,90

FIGURA 4-27

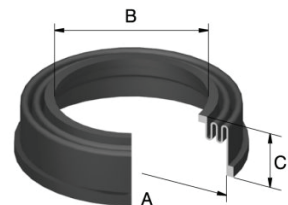

REF.	A	B	C
B4167	53,00	38,00	15,00

PIEZAS CLASIFICADAS POR FIGURA

FIGURA 4-32

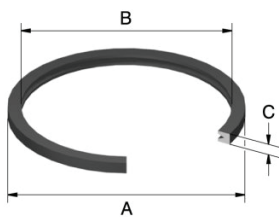

REF.	A	B	C
B4157	57,80	51,10	3,80

FIGURA 4-62



REF.	A	B	C
B4513	85,80	64,30	9,25

FIGURA 5-65

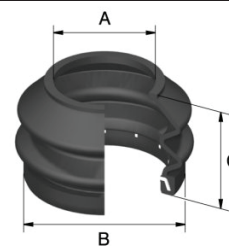

REF.	A	B	C
B5050	16,00	25,70	17,50

FIGURA 4-38

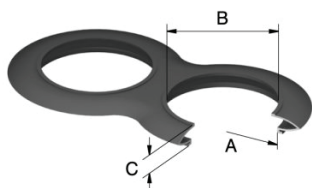

REF.	A	B	C
B4259	33,60	26,90	7,00
B4257	41,00	33,70	9,80

FIGURA 5-51

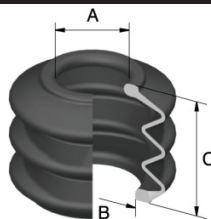

REF.	A	B	C
B5051	11,00	15,90	24,00

FIGURA 5-78

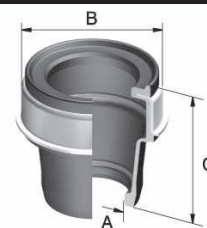

REF.	A	B	C
B5305	37,70	21,80	21,40

FIGURA 4-39

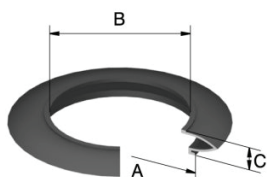

REF.	A	B	C
B4258	53,80	39,70	8,30
B4256	63,40	49,50	9,20

FIGURA 5-52

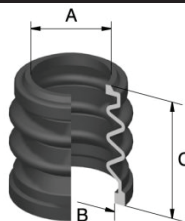

REF.	A	B	C
B5082	10,80	10,80	28,60
B5092	11,00	11,50	27,00

FIGURA 5-109

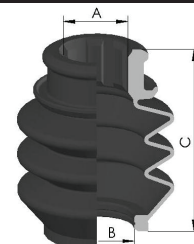

REF.	A	B	C
B5323	11,40	13,45	34,00

FIGURA 4-46

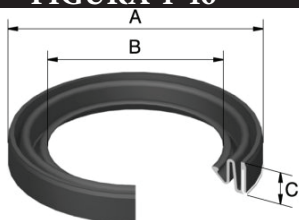

REF.	A	B	C
B4293	64,70	44,20	9,10

FIGURA 5-61

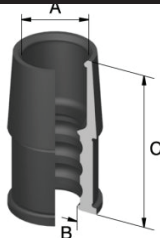

REF.	A	B	C
B5069	15,00	11,40	38,80

FIGURA M-6

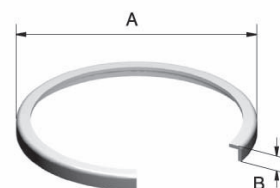

REF.	A	B	C
02901	58,80	3,70	0,00

PIEZAS CLASIFICADAS POR FIGURA

FIGURA M-16

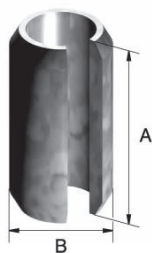

REF.	A	B	C
029110	38,00	3,80	0,00

FIGURA M-25

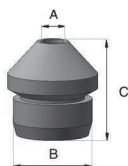

REF.	A	B	C
028134	3,10	9,70	11,60

FIGURA M-95

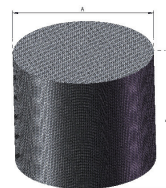

REF.	A	B	C
028139	10,75	9,00	0,00

FIGURA M-17

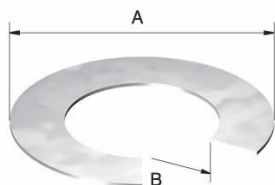

REF.	A	B	C
02993	9,80	6,10	1,00
028136	15,10	10,00	0,70
02983	18,20	8,20	0,20
028135	18,25	8,50	0,20
02814	19,30	13,30	0,20
02821	19,60	12,20	0,20
02981	19,90	10,45	0,20
02805	20,80	10,10	0,20
028138	21,15	15,10	0,20
028133	21,17	14,22	0,30
02952	21,50	14,40	0,20
028141	22,20	15,08	0,70
02967	22,95	15,35	0,20
028129	23,05	16,50	0,20
02966	24,00	13,20	0,20
02963	24,00	17,20	0,20
028106	24,50	11,20	0,10
02987	27,90	16,30	0,20
028131	27,95	15,00	0,20
028130	33,85	17,70	1,00

FIGURA M-68

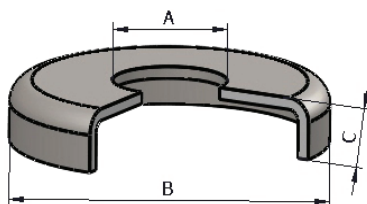

REF.	A	B	C
023106	17,30	9,20	3,05

FIGURA M-96



REF.	A	B	C
029100	4,00	2,50	32,00

FIGURA M-93

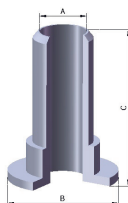

REF.	A	B	C
028132	3,9	7,10	9,75

FIGURA met19

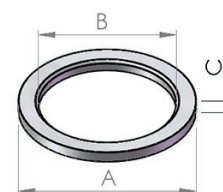

REF.	A	B	C
028140	59,00	38,00	7,00

FIGURA M-94



REF.	A	B	C
028137	3,05	6,65	10,00

FIGURA M-23

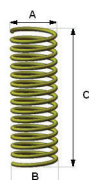

REF.	A	B	C
02669	4,50	4,50	25,8
02310	4,70	4,70	19,00

EQUIVALENCIAS

SEINSA	WILDBRAKE	SEINSA	WILDBRAKE
D1804	WH18130	D4125	WH17004
D1805	WH12630	D4130	WC835011
D1806	WH17039	D4195	WC836304
D1807	WH10024	D4293	WC318091
D1808	WH11153	D4900	WC31115
D1809	WH17074	D4900	WC315363
D1810	WH18099	D4900	WH11115
D1811	WH11139	D4900	WH15363
D1812	WH12632	D4901	WH18005
D1812	WH17083	D41561	WC315418
D1813	WH18106		
D1814	WH11102		
D1815	WH17051		
D1816	WH17071		
D1817	WH15372		
D1818	WH18116		
D1819	WH17029		
D1820	WH17076		
D1821	WH11165		
D1822	WH17043		
D1823	WH19388		
D1824	WH19058		
D1825	WH18089		
D1826	WH18098		
D1827	WH18114		
D1828	WH18053		
D1829	WH10301		
D1830	WH17031		
D1830	WH17035		
D1830	WH17047		
D1830	WH17081		
D1831	WH18113		
D1832	WH17060		
D1833	WH18088		
D1834	WH18075		
D1866	WH18094		
D1867	WH17089		
D1868	WH17045		
D1869	WH19650		
D1870	WH17192		
D1871	WH17085		
D1872	WH17069		
D1874	WH18185		
D1875	WH17195		
D1876	WH19869		
D1877	WH17053		
D1878	WH17037		
D1879	WH17073		
D1880	WH17087		
D1881	WH17201		
D1882	WH17078		
D4101	WH15418		
D4110	WC836036		
D4110	WC836110		
D4110	WH18059		

SEINSA IN THE WORLD



Elizguibel s/n
31638 EUGI (Navarra) SPAIN
General Tel. +34 948 30 40 31
Export Tel. +34 948 30 40 60
Fax. +34 948 30 42 86
General e-mail: seinsa@seinsa.es
Export e-mail: export@seinsa.es

www.seinsa.es

- ONLINE CATALOGUE CONSTANTLY UPDATED
- DOWNLOADABLE CD CATALOGUE
- PDFs, VIDEOS...