

Audi

Q7

Applicazione	kW	Da anno	Cambio	Audi OE No	L	A	B	D	Posizione	-	GR No
3.0 TDI	155	03.06-	A/M	7L0 521 101 D/F/H	631,9	86	86	50	A		AU5001
3.0 TDI	171	03.06-	A/M								
3.0 TDI	176	11.07-	A/M								
3.6 FSI	206	08.06-	A/M								
4.2 FSI	257	03.06-	A/M								

Disegno

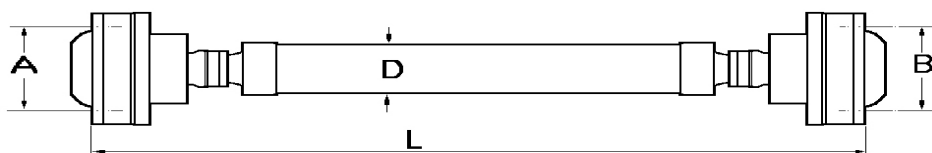

Fiat

Panda (169)

Applicazione	kW	Da anno	Cambio	Fiat OE No	L	A	B	D	-	-	GR No
1.2 4x4	44	10.04 -	A/M	55193595	1729,5	74	74				FI5005
1.3 JTD 4x4	51	10.04 -									

Disegno

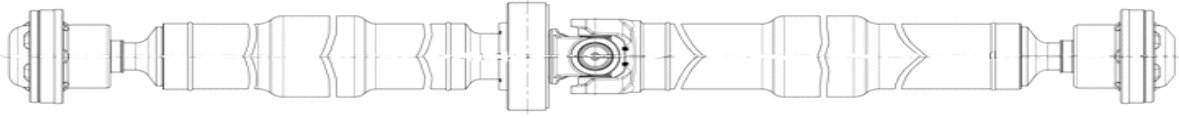

Nissan

Cabstar - Atleon

Applicazione	kW	Da anno	Cambio	Nissan OE No	L	L1	A	B	U	4xd	GR No
Cabstar			A/M	37300-F3900	1557,0	55	60,32	95	35	9,7	ND5006
Atleon			A/M	37300-9X502	1118,0	70	69,85	65	43,5	12	ND5007

Disegno

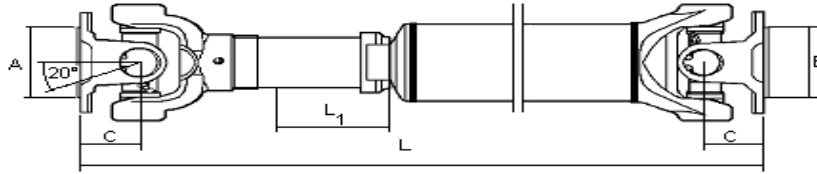

Porsche

Cayenne

Applicazione	kW	Da anno	Cambio	Audi OE No	L	A	B	D	Posizione	-	GR No
V6 3.0 TDI	176	02.09 -	MT/AT	955.421.020.03	631,9	86	86	50	A		AU5001
V8 S 4.5	250	09.02 -									
V8 Turbo 4.5	330	09.02 -									

Disegno

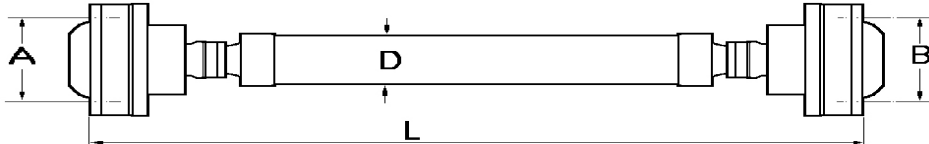

Applicazione	kW	Da anno	Cambio	Audi OE No	L	A	B	D	Posizione	-	GR No
V6 3.0 TDI	176	02.09 -	MT/AT	955.421.020.13	1246	110	99.5	70	P		PO5003
V8 S 4.5	250	09.02 -									
V8 Turbo 4.5	330	09.02 -									

Disegno

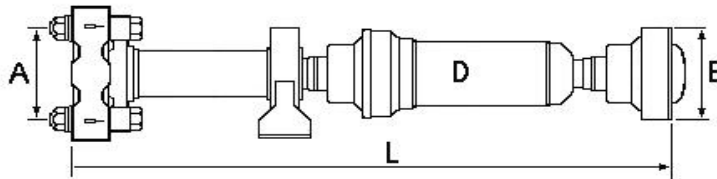

Renault

Kangoo

Applicazione	kW	Da anno	Cambio	Renault OE No	L	L1	L2	L3	A	B	GR No
1.6 16V 4x4	70	10.01-	MT/AT	8200149811	1978	680	753	545	91	91	RE5008
1.9 dCi 4x4	59	10.01-									
1.9 dCi 4x4	62	07.03-									

Disegno

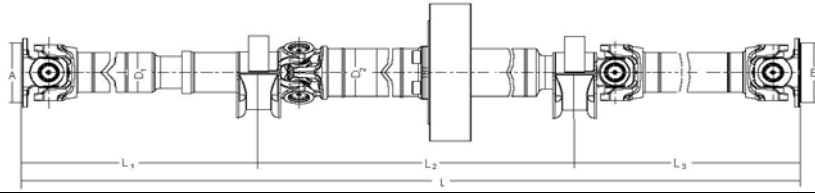

Volkswagen

Touareg

Applicazione	kW	Da anno	Cambio	VW OE No	L	A	B	D	Posizione	-	GR No
2.5 R5 TDI	128	01.03 -	AT	7L6521101C/E/G/L/N	694,3	86	86	50	A		WW5003
5.0 V10 TDI	230	10.02 -									
3.0 V6 TDI	165	11.04 -	AT	7L0521101A/B/C/D	631,9	86	86	50	A		AU5001
3.2 V6	162	10.02 - 11.06									
3.2 V6	177	11.04 - 11.06									
3.6 V6 FSI	206	03.06 -									
4.2 V8	228	12.02 - 11.06									
4.2 V8 FSI	257	12.06 -									
6.0 W12	331	03.05 -									

Disegno

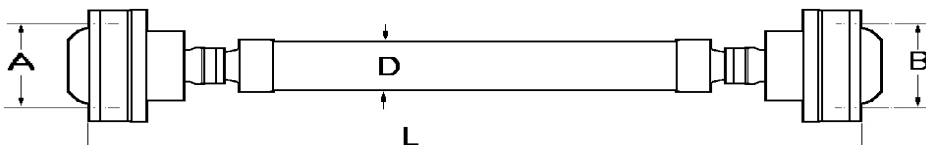

Applicazione	kW	Da anno	Cambio	VW OE No	L	A	B	D	Posizione	-	GR No
2.5 R5 TDI	128	01.03 -	AT	7L6521102B/C/D/E/F	1185	110	99,5	70	P		WW5004
5.0 V10 TDI	230	10.02 -									
3.0 V6 TDI	165	11.04 -	AT	7L6521102G/J/M/R/P	1246,4	110	99,5	70	P		PO5003
3.2 V6	162	10.02 - 11.06									
3.2 V6	177	11.04 - 11.06									
3.6 V6 FSI	206	03.06 -									
4.2 V8	228	12.02 - 11.06									
4.2 V8 FSI	257	12.06 -									
6.0 W12	331	03.05 -									

Disegno

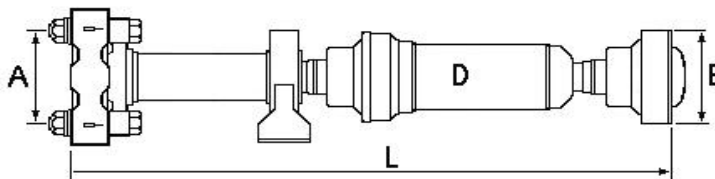

Listino General Ricambi

Codice GR	Prezzo Netto
AU5001	€ 240,00
FI5005	€ 420,00
ND5006	€ 380,00
ND5007	€ 350,00
PO5003	€ 370,00
RE5008	€ 530,00
WW5003	€ 240,00
WW5004	€ 370,00