

# Idol 1.0 Instruction

Idol 1.0 is a remote duplicator which can copy most of rolling code and fixed code remote from 300mhz-868mhz. Can store 4 different frequency fixed or rolling code in 4 different buttons. It can even re-generate a new remote. (Table 2.0 for detailed reference)

## Technical data:

Frequency: 300mhz-868mhz

Working voltage: 3V or 12V optional

Voltage: 2.4V-3.3V or 7-12V optional

Working current:  $24\text{mA} \pm 2\text{mA}$

Static current:  $0.4\mu\text{A} \pm 2\mu\text{A}$  or  $1.4\mu\text{A} \pm 2\mu\text{A}$  optional

Working range: 90m in the open air

## Copy fixed and rolling code remote:

**Please kindly noted that all the brands in the table 3.0 can be copied by IDOL**

Step1: Press together 2<sup>nd</sup> button and 3<sup>rd</sup> button for 3 seconds, the LED will be on then go off (about 1 second) till LED will light on again, release both buttons. Which means it's entering into learning mode. Please see fig 1.

Step2: Press 1<sup>st</sup> button once, Idol LED flashes slowly. Please see fig 2. (The code will be stored in the 1<sup>st</sup> button)

Step3: Place the original remote in front of Idol, about 2-3cm distance. Please see fig 3.

Step4: Keep pressing any button of original remote till the Idol LED blink. It means the code has been successfully stored. Please see fig 4

Please repeat the above steps for the 2<sup>nd</sup>, 3<sup>rd</sup>, 4<sup>th</sup> buttons of Idol.

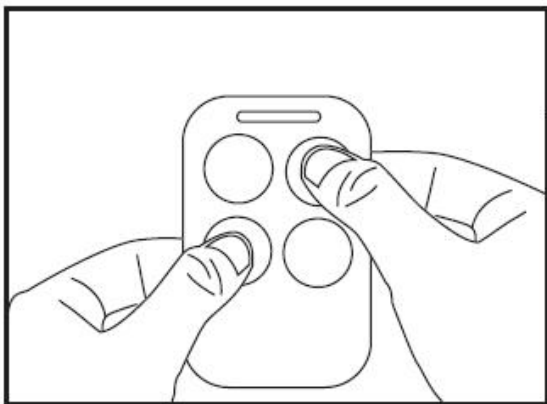

fig1

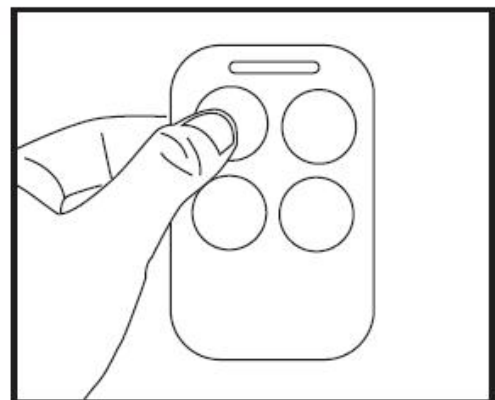

fig2

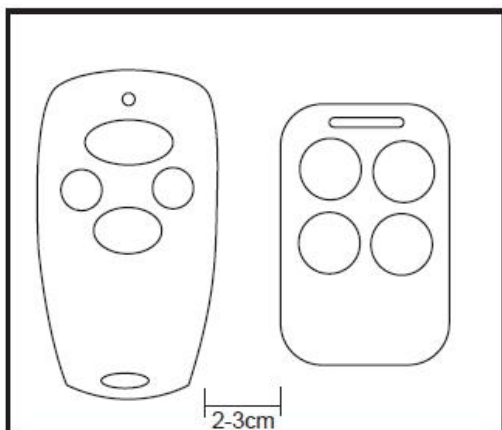

fig3

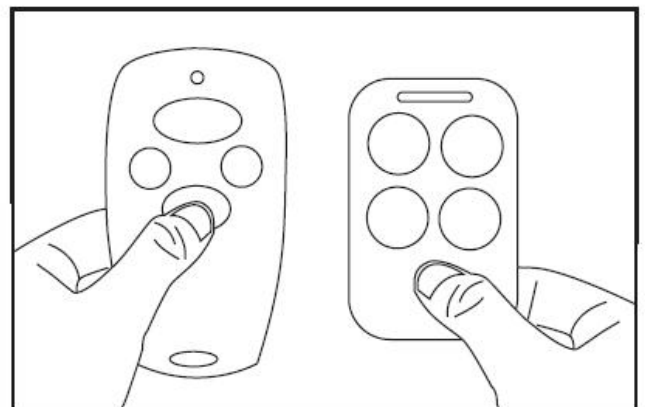

fig4

**Attention: BFT, FAAC 433-868 SLH has different operation as bellowing:**

**BFT**

Step1: Press 2<sup>nd</sup> button and 3<sup>rd</sup> button at the same time (about 3 seconds), the LED light on then go off (about 1 second) till LED light on again, release both buttons. Which means it's entering into learning mode. Please see fig1.

Step2: Press 1<sup>st</sup> button once, Idol LED flashes slowly. Please see fig2. (the code will be stored in 1<sup>st</sup> button)

Step3: Place BFT remote in front of Idol, about 2-3cm distance. Press any BFT button you want to copy (1-3cm distance from Idol ) till Idol LED light on, release the buttons. Please see fig3

Step4: Keep pressing the 1<sup>st</sup> and 2<sup>nd</sup> button of BFT at the same time (or the rear button), till Idol LED blinks, release both buttons. Now the button has successfully copied the original remote.

Please repeat the above steps for the 2<sup>nd</sup>, 3<sup>rd</sup>, 4<sup>th</sup> buttons of Idol.

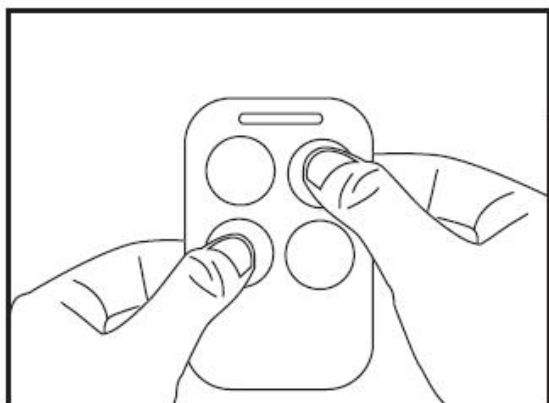

fig1

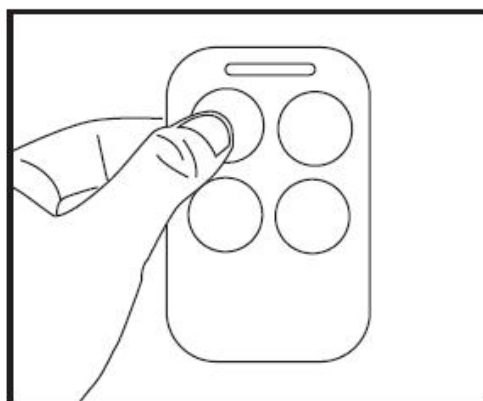

fig2

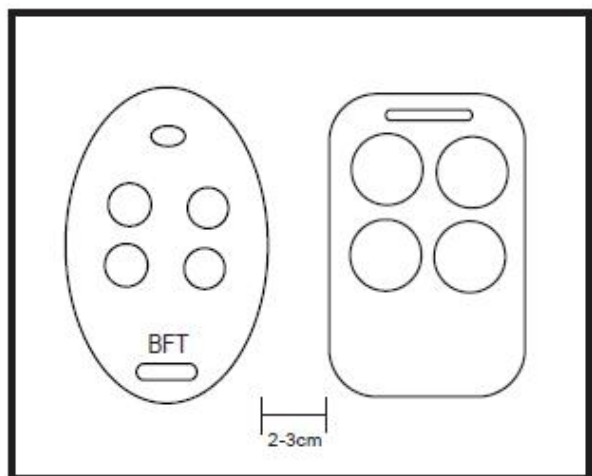

fig3

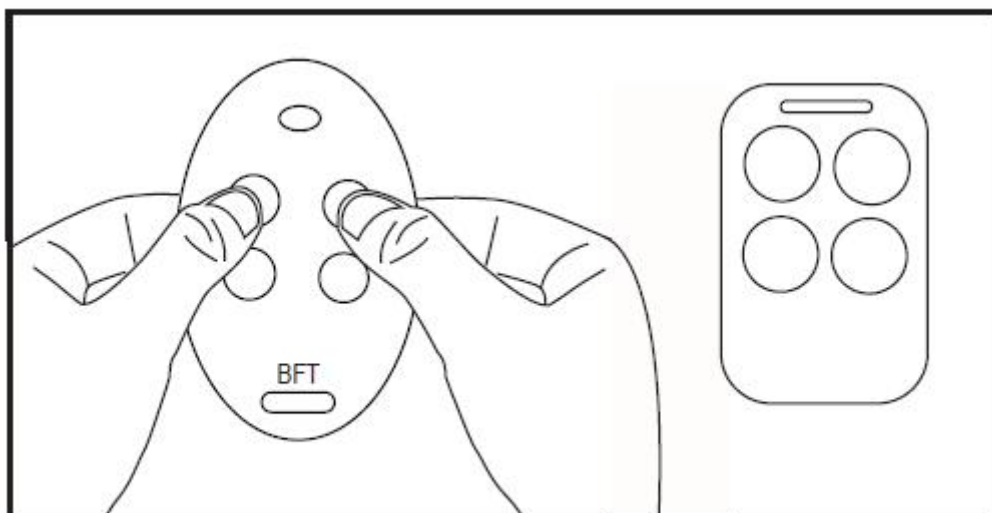
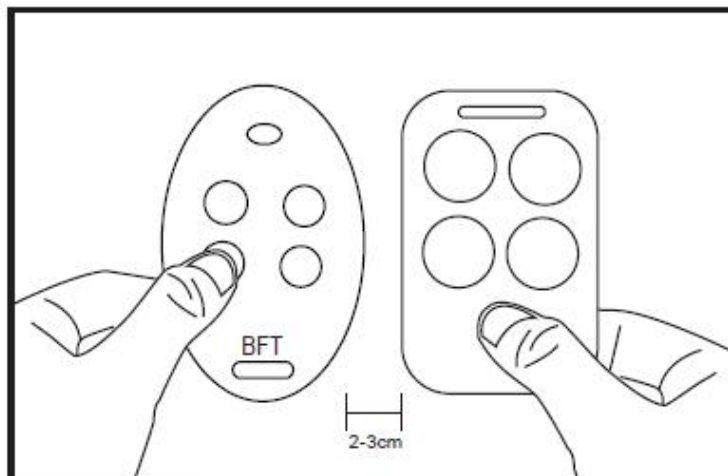

fig4

**FAAC 433-868 SLH** (The original FAAC remote must be MASTER remote)

Step1: Press together Idol's 2<sup>nd</sup> and 3<sup>rd</sup> button for 3 seconds, the LED will light on then go off (about 1 second) till LED will light on again, release the buttons. Which means it's entering into learning mode. Please see fig1.

Step2: Press 1<sup>st</sup> button once, Idol LED flashes slowly. Please see fig2

Step3: Place FAAC remote in front of Idol, about 2-3cm distance. Press any FAAC button you want to copy till Idol LED light. Please fig 3.

Step4: Press 1<sup>st</sup> and 2<sup>nd</sup> button at FAAC for 2 seconds, till FAAC remote flashes, release the buttons. Then press any button at FAAC till Idol's LED blink. It means you copy successfully.

Please repeat the above steps for the 2<sup>nd</sup>, 3<sup>rd</sup>, 4<sup>th</sup> buttons of Idol.

Notification: For **GENIUS** remote, the best distance for copying is 4-7cm.

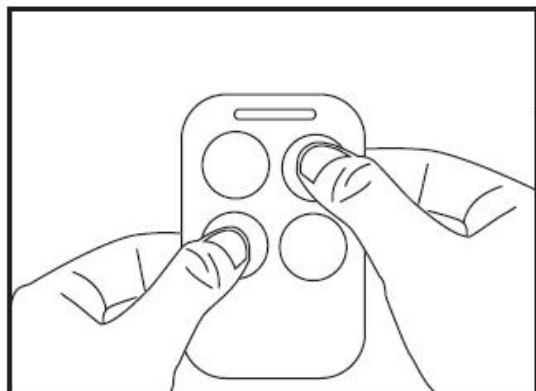

fig1

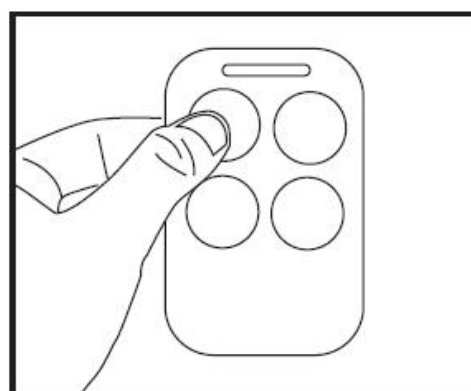

fig2

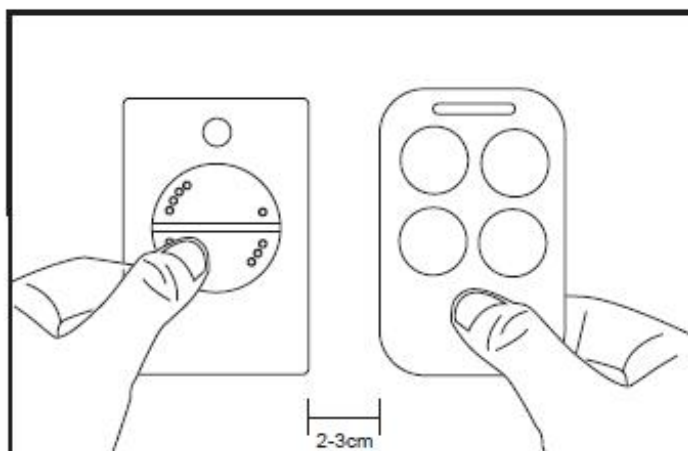
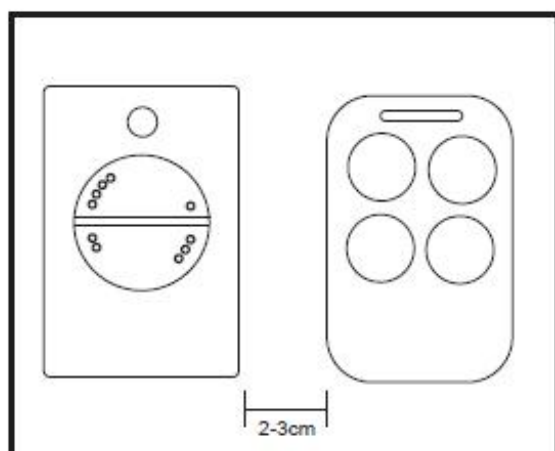

fig3

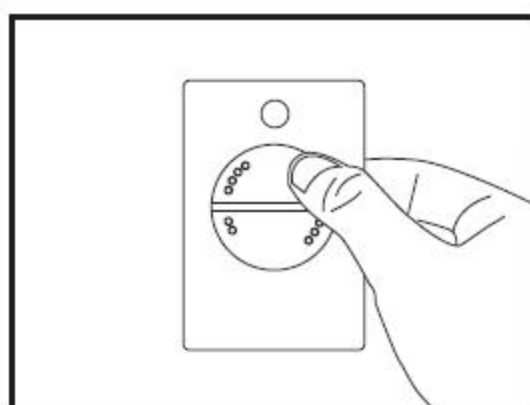
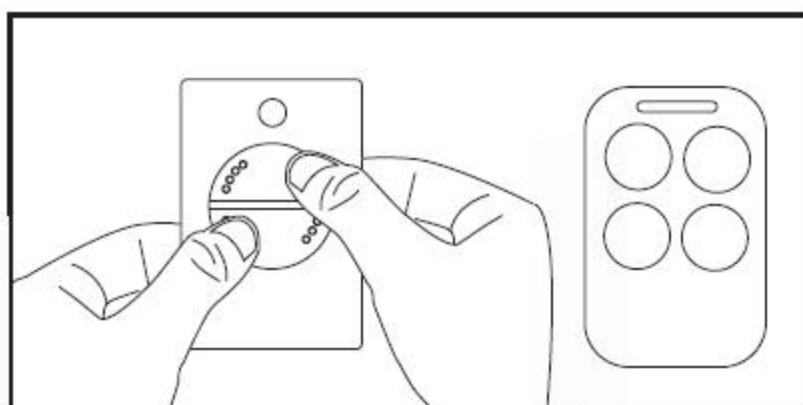

fig4

## Remotely program function:

### Please kindly note that all the brands in the table 1.0 can be program into original receiver

Get close to the receiver and press together Idol 1<sup>st</sup> and 3<sup>rd</sup> buttons for 3 seconds, the LED will light on then go off (about 1 second) till LED will light on again, release both buttons. Which means it's entering into remotely program mode. Then press any Idol's button that you already copied once, to indicate that remotely program procedure has started. After 8 seconds, wait the activation of the receiver (gate opening, lights starting, etc..) The remote control has been memorized.

**Attention:** If the receiver doesn't work, the "remote program function" maybe disarmed, if so please operate it manually.

Please kindly note that fixed code remote after copying, Idol can act as the original remote and do not need to program with receiver.

Table 1.0

List 1	List 2
<p><b>Italy</b></p> <p><b>ALLMATIC</b> B.RO OVER, B.RO 2WN, TECH3, MINIPASS, BRO.STAR</p> <p><b>APRIMATIC</b> TR2/4, TM4</p> <p><b>BENINCA</b> TO.GO2 /4 VW, TO.GO2/4 QV, IO, T2/4 VW</p> <p><b>BFT</b> MITTO 2/4M, MITTO 2/ 4A, MITTO RCB02/04, GHIBLI, KLEIO, TRC2/4, RB4 MURALE</p> <p><b>CARDIN</b> S449 TRQ449100/TRQ449200/ TRQ449300/TRQ449400, TXQ449200/TXQ449300/ TXQ449400, S486:TRQ486200/ TRQ486400, TXQ486200/ TXQ486400</p> <p><b>DITEC</b> GOL4, BIXLP2/2 RED, BIXLG4</p> <p><b>FAAC</b> XT4 433 RC, TE4433H</p> <p><b>FADINI</b> JUBI SMALL, JUBI-2, JUBI-4</p> <p><b>GENIUS</b> BRAVO TE4433H, ECHO</p> <p><b>GIBIDI</b> AU1680 WOOD, GIBIDI AU1610/1680, AU1810/1600, AU01590 AUO3000 DOMINO, DTC 4334</p>	<p><b>KING GATES</b> STYLO 4</p> <p><b>MHOUSE</b> TX4, TX3, GTX4</p> <p><b>NICE</b> SMILO2/4, FLO1/2/4R-S,VERY VR, FLO1/2/4</p> <p><b>VDS</b> TRQ, ECO-R</p> <p><b>V2</b> PHOENIX 433-868, TXC, TSC, TRC, HANDY</p> <p><b>PUJOL</b> VARIO, MARTE</p> <p><b>Australia</b></p> <p><b>BOSS</b> BHT4</p> <p><b>France</b></p> <p><b>ADYX</b> BRAVO, TE4433H, TE4433H BLUE</p> <p><b>PRASTEL</b> MPSTF2/F4RE, MPSTL-1E/2E/4E, MPSTP2E/2E BLUE, MT4E/2E, BFOR, TRQ4P, TC2E, TRQ2P</p> <p><b>SOMFY</b> TELIS 1/ 4 RTS</p>

## Re-generate function:

If customers buy an Idol remote, but they lost their original remote, they can re-generate an original remote.

Step1: Pressing 1<sup>st</sup> button and 4<sup>th</sup> button for 3 seconds, the LED will light on then go off (about 1 second) till LED light on again, release both buttons. Which means it's entering into Re-generate mode. Please see the fig1

Step2: Press buttons to choose the brands as table 2.0. For example, if you choose BFT MITTO brand, press 1<sup>st</sup> button once, then LED flashes once.

Step3: Confirm the brand. Press 3<sup>rd</sup> and 4<sup>th</sup> button at the same time. Till LED blink, release the buttons. Now the Idol remote is functioning as a new BFT MITTO remote. Please see fig2.

**Note1.** If you are using Idol to regenerate a FAAC 4 buttons remote, then re-generate a BFT 2 buttons remote, the in the Idol remote, 1<sup>st</sup> and 2<sup>nd</sup> button is BFT code, 3<sup>rd</sup> and 4<sup>th</sup> button is FAAC code.

**Note2.** If you press button once, the Idol's LED flashes once; If you press button twice , the Idol's LED flashes twice, etc.

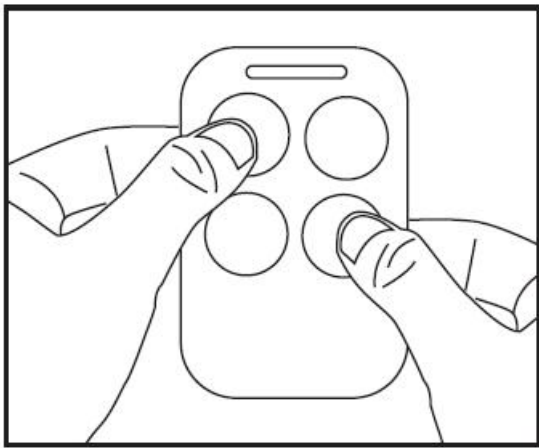

fig1

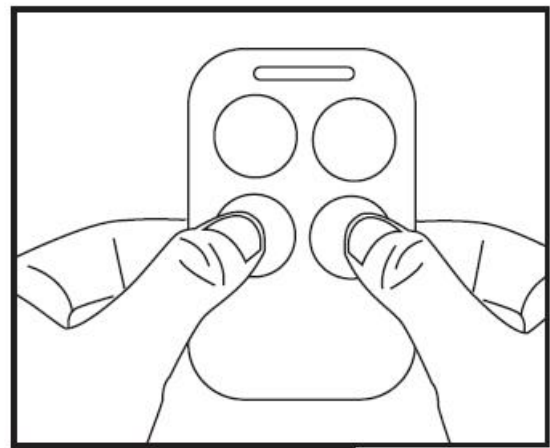

fig2

Table 2.0

Remote	Press once	Press twice	Press 3 times	Press 4 times
1 <sup>st</sup> button	BFT MITTO	BENINCA cupido	NICE SMILO	NICEFLOR-S
2 <sup>nd</sup> button	FAAC XT4 433 SLH	CAME TOP-432NA	DITEC DOL4C	LIFTMASTER/MERLIN
3 <sup>rd</sup> button	SUPERLIFT	NOVA	V2 PHOENIX2	DOORHAN TRANSMITTER 4
4 <sup>th</sup> button	BOSS BHT4	ATA PTX4		

Table 3.0

Copying list	
<p>Table 1.0+Table 2.0+Follows brands</p> <p><b>Italy</b></p> <p><b>CAME</b> TAM 432 SA, TOP 432 / NA, TOP 432 SD, TOP 432/434 EV</p> <p><b>DEA</b> TR2 /4 MIO,GENIE R, TS2/4 MIO 868/ 868</p> <p><b>FAAC</b> XT2/XT4 433 SLH, XT2/XT4 868 SLH, XT2/XT4 433 SLH LR, XT2/XT4 868 SLH LR, T2/T4 433 SLH, T2/ T4 868 SLH, TML2/TML4 433 SLH, TML2/TML4 868 SLH, DL2/DL4 868 SLH.</p> <p><b>KEY</b> 900TXB - 42R, SUB44, TXB-44R, TXG-44R</p> <p><b>NICE</b> ONE:ON1/2/4/9, ONE ERA:ON1/2/4/9E, INTI1/2</p> <p><b>SEAV</b> BE-HAPPY-RS1/2/3, BE-SMART RSX, BE-HAPPY RH1/2/3</p> <p><b>TELCOMA</b> FM 402/402 E</p> <p><b>Australia</b></p> <p><b>ATA</b> PTX4</p> <p><b>MERLIN + 2.0</b> E945M, E943M, E940M, E940M</p> <p><b>MERLIN</b> M842, M832, M844, C945, C940, C943</p> <p><b>SUPERLIFT</b></p> <p><b>Russia</b></p> <p><b>DOORHAN</b> TRANSMITTER 4</p>	<p><b>France</b></p> <p><b>SOMFY</b> KEYTIS 2/ 4 NS,KEYGO 4 RTS,SOMFY 433-NLT4 BEIGE, SOMFY 433-NLT2 RTR, SOMFY TX2 433MHZ</p> <p><b>United states</b></p> <p><b>CHAMBERLAIN LIFTMASTER MOTORLIFT</b> 94335E, 4333E, 4335E, 94334E, 4333EML, 4335EML, 84334EML, 4335EML</p> <p><b>Germany</b></p> <p><b>SOMMER</b> 4014 TX03-434-2, 4013 TX02-434-4, 4022 TX03-434-2, 4026 TX03-868-2, 4020 TX03-868-4, 4025-TX02868.4011, 4010</p> <p><b>APERTO</b> TX02-434/868-2, 4025 TX02-868-2, 4022 TX02-434-2, 4020 TX-03-868-4, 4013 TX03-434-4</p> <p><b>South Africa</b></p> <p><b>Centurion</b> NOVA</p> <p><b>Brazil</b></p> <p><b>Peccinin</b> <b>Rossi</b></p>