

# DESIGNATION EXAMPLE

**MPU4R.6.075.25(30/3)-350/25-310**

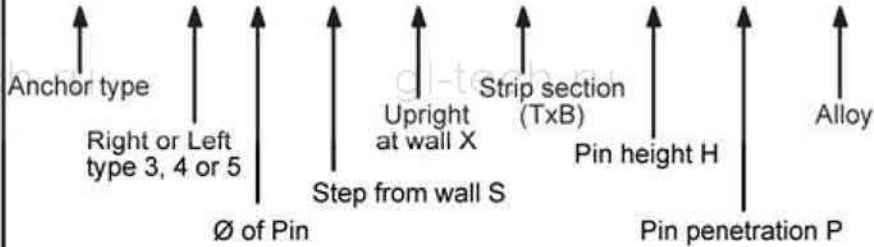

Standard alloys

# MPU

## MPU styles and forms

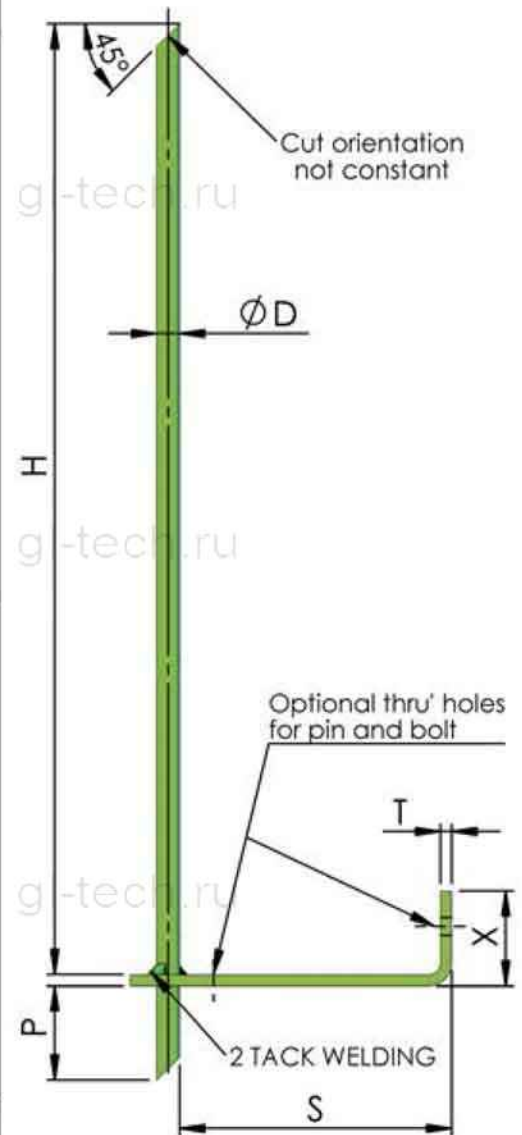
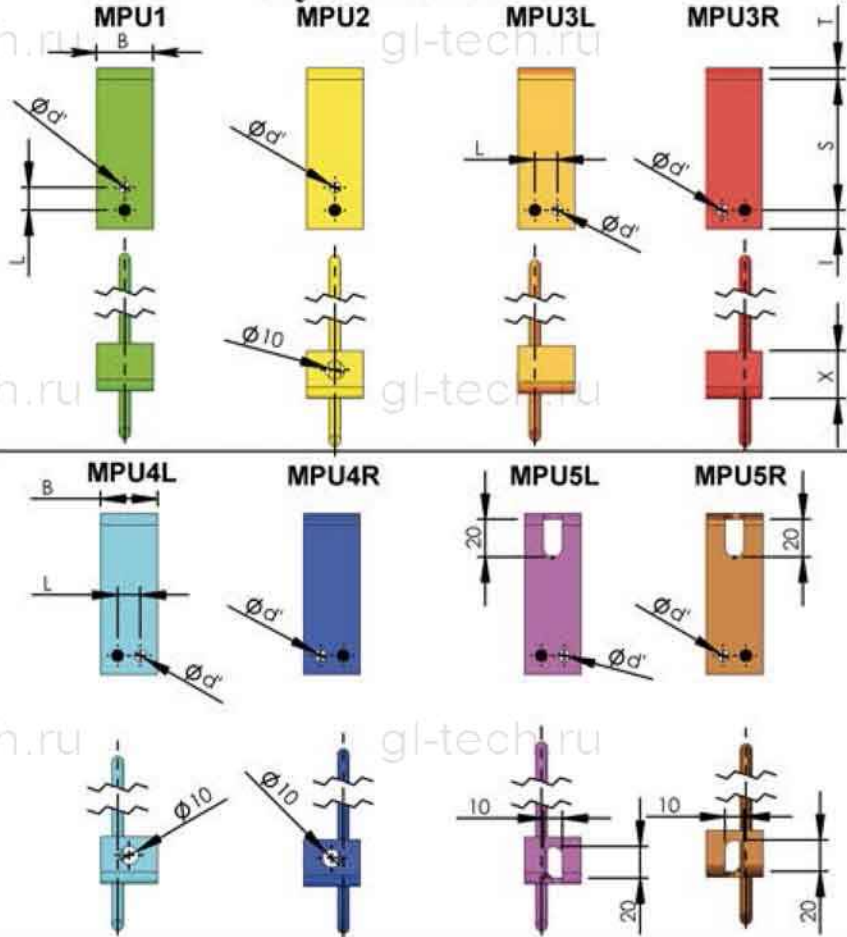

**MPU STANDARD : MPU 3 ( R & L ) .6.060.25(30/3)-330/20-310**



**IRIS - Industrial Refractories & Insulating Specialities**  
 Parc d'Activités Aérodrôme Ouest - Rouvignies - F - 59328 VALENCIENNES Cedex (France)

Tél : +33 (0)3.27.21.52.80  
 E-mail: [contact@irisfrance.com](mailto:contact@irisfrance.com)

Fax : +33 (0)3.27.21.52.99  
 Web: [www.irisfrance.com](http://www.irisfrance.com)

This drawing is the property of IRIS. Unauthorised use of patented features and/or reproduction of this drawing is strictly prohibited

# FIBERBLOK & FIBERBLOK ANCHOR

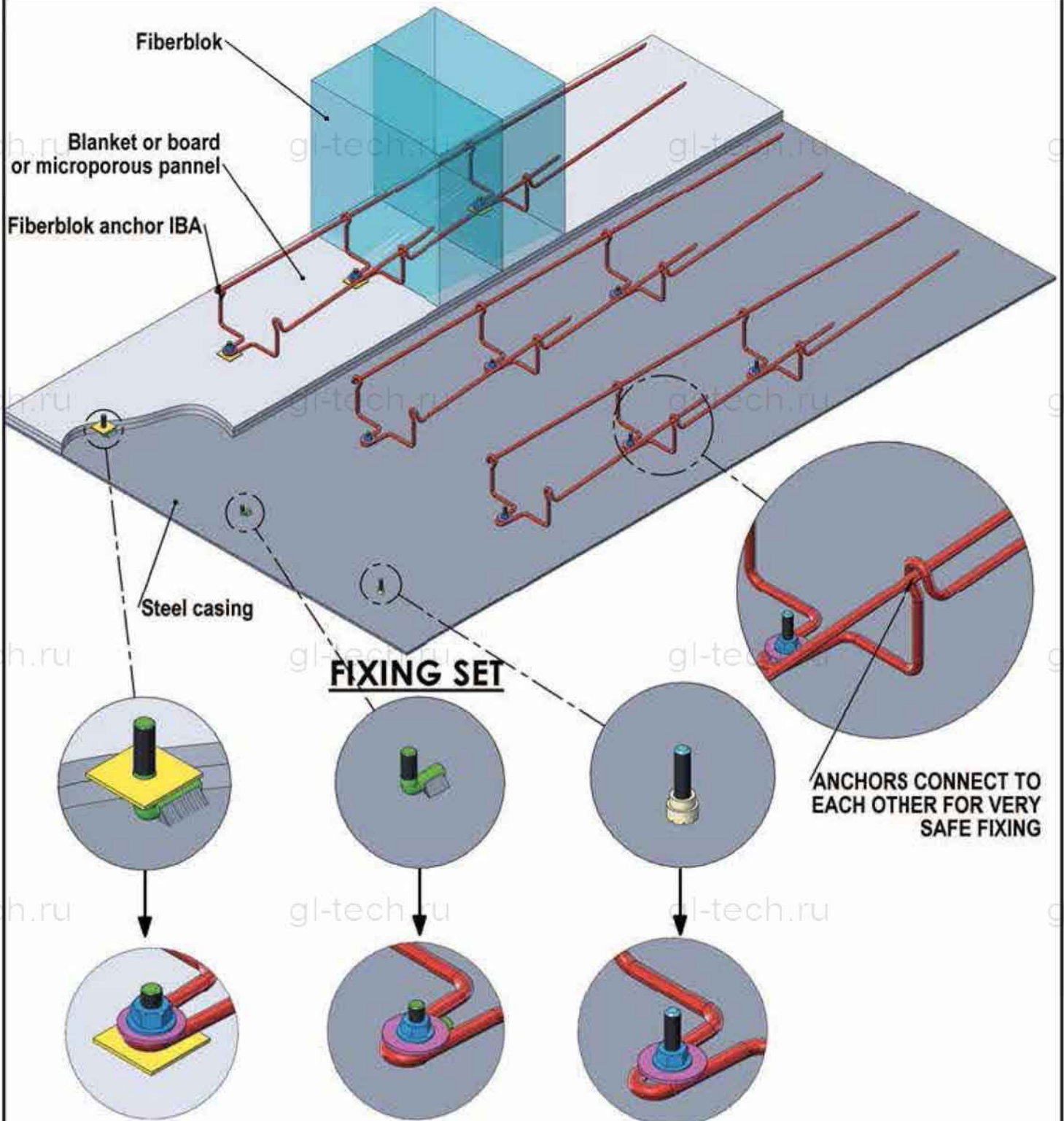

**IRIS - Industrial Refractories & Insulating Specialities**  
Parc d'Activités Aéroport Ouest - Rouvignies - F - 59328 VALENCIENNES Cedex (France)

Tél : +33 (0)3.27.21.52.80  
E-mail: [contact@irisfrance.com](mailto:contact@irisfrance.com)

Fax : +33 (0)3.27.21.52.99  
Web: [www.irisfrance.com](http://www.irisfrance.com)

This drawing is the property of IRIS. Unauthorised use of patented features and/or reproduction of this drawing is strictly prohibited

# FIBERBLOK & FIBERBLOK ANCHOR

## ROOF ASSEMBLY

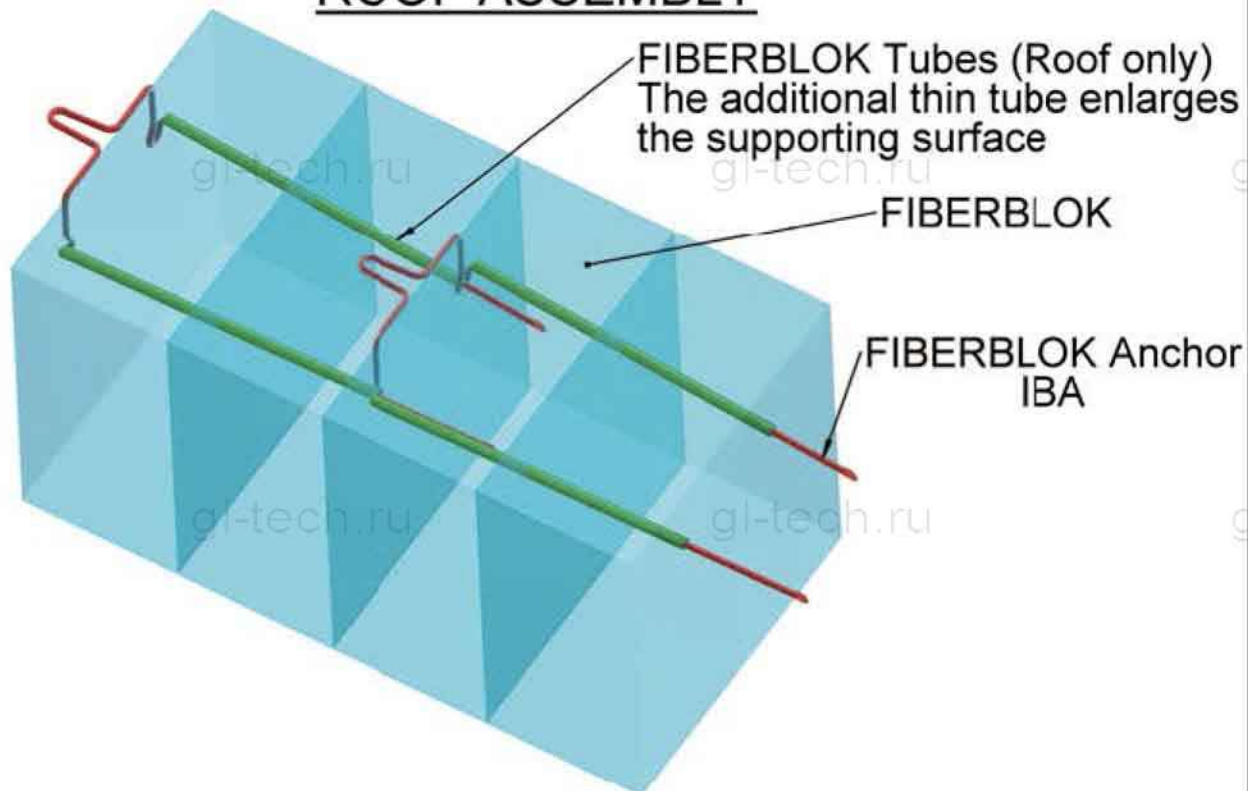

## WALL ASSEMBLY

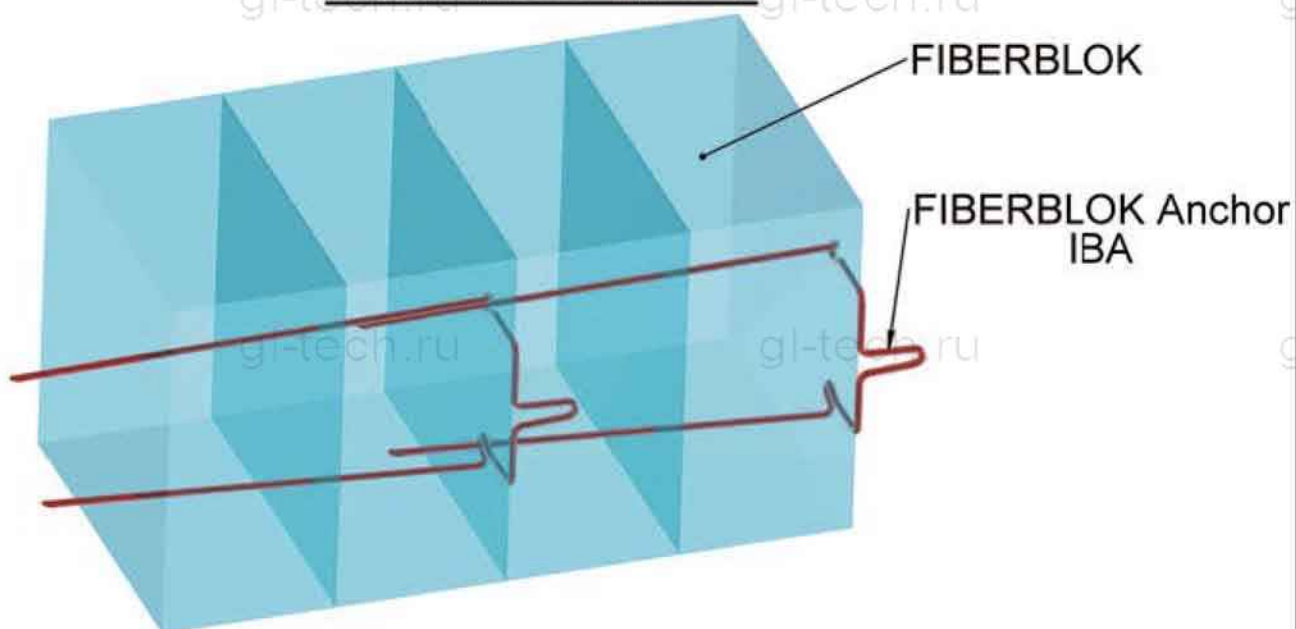

**IRIS - Industrial Refractories & Insulating Specialities**  
Parc d'Activités Aéroport Ouest - Rouvignies - F - 59328 VALENCIENNES Cedex (France)

Tél : +33 (0)3.27.21.52.80  
E-mail: [contact@irisfrance.com](mailto:contact@irisfrance.com)

Fax : +33 (0)3.27.21.52.99  
Web: [www.irisfrance.com](http://www.irisfrance.com)

This drawing is the property of IRIS. Unauthorised use of patented features and/or reproduction of this drawing is strictly prohibited

# FIBERBLOK & FIBERBLOK ANCHOR

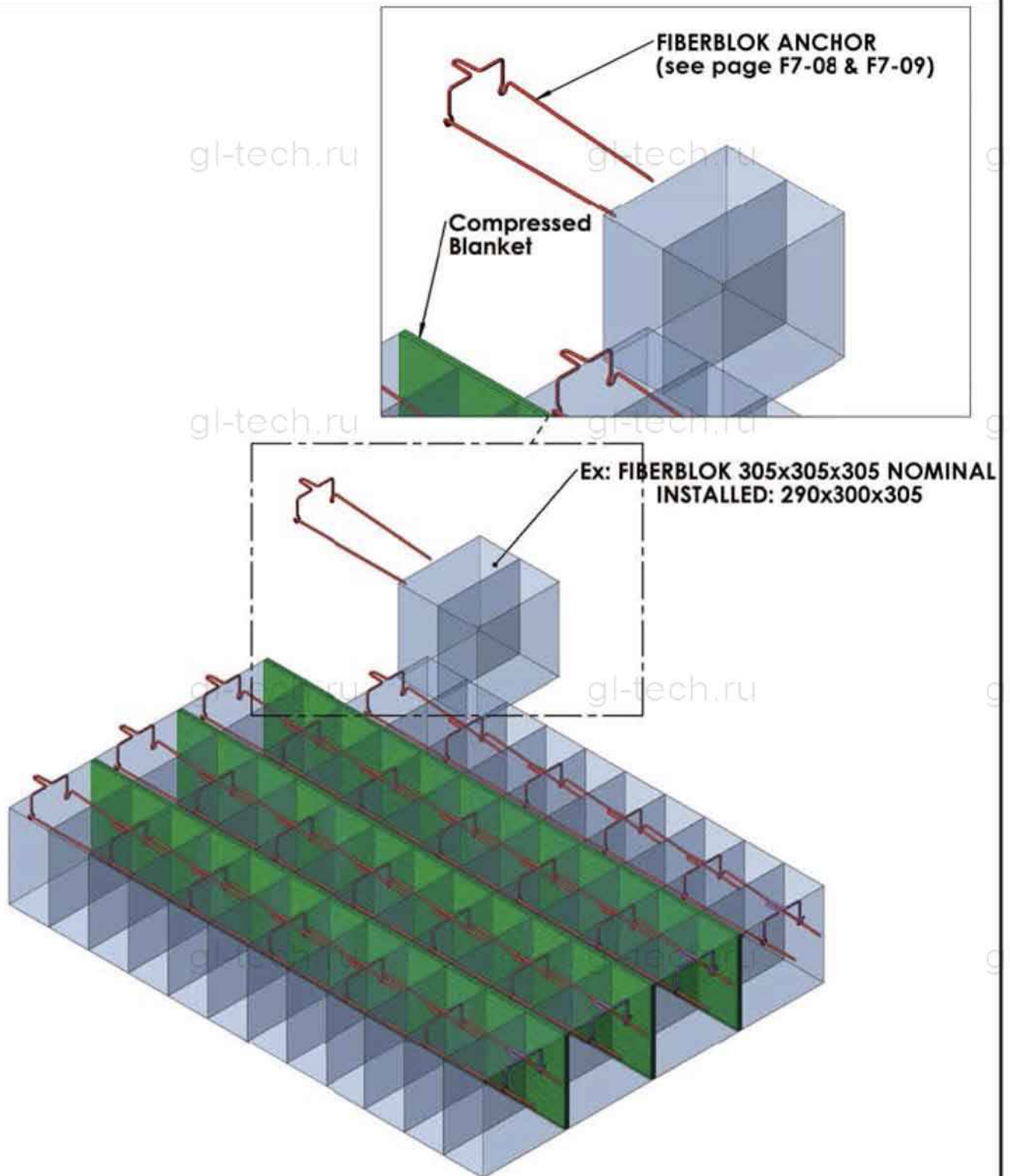

**IRIS - Industrial Refractories & Insulating Specialities**  
Parc d'Activités Aéroport Ouest - Rouvignies - F - 59328 VALENCIENNES Cedex (France)

Tél : +33 (0)3.27.21.52.80  
E-mail: [contact@irisfrance.com](mailto:contact@irisfrance.com)

Fax : +33 (0)3.27.21.52.99  
Web: [www.irisfrance.com](http://www.irisfrance.com)

This drawing is the property of IRIS. Unauthorised use of patented features and/or reproduction of this drawing is strictly prohibited

# FIBERBLOK & FIBERBLOK ANCHOR

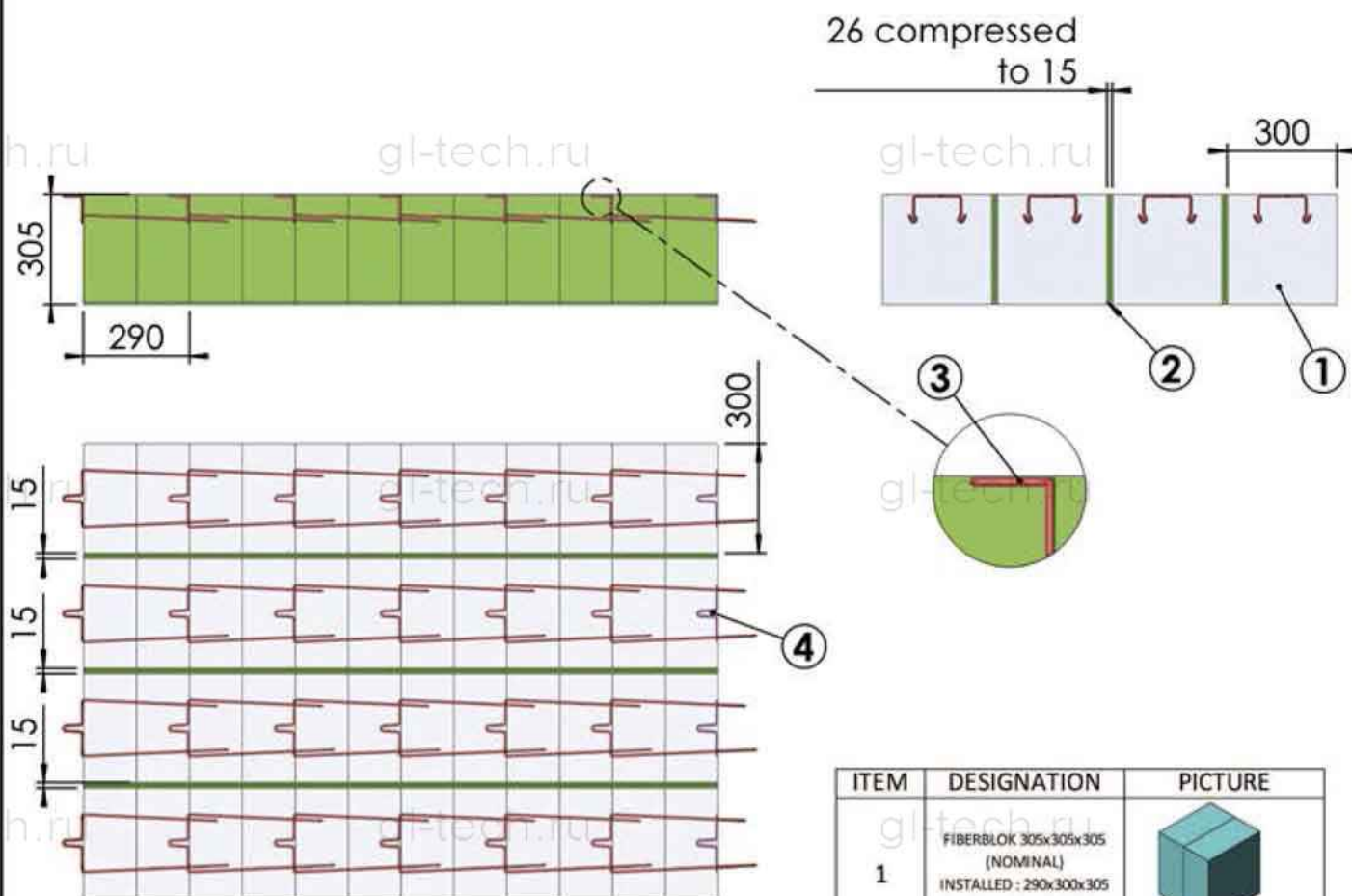

## FOR 1 SQUARE METER:

- 11 FIBERBLOKS
- 0.2 Blanket density 96Kg/m<sup>3</sup>
- thk: 13mm, length 14.6m, width 0.61m.
- 11 Fixing Sets
- 11 IBA

### Optional:

- 22 tubes for roof
- 5% of total quantity of IBA in STARTIBA (page F7-10)

SPARES TO BE ADDED

THEORETICAL QUANTITIES TO ADAPT ACCORDING TO SPECIAL LAY OUT.

ITEM	DESIGNATION	PICTURE
1	FIBERBLOK 305x305x305 (NOMINAL) INSTALLED : 290x300x305	
2	BLANKET PACKING 2 x 13 mm = 26 COMPRESSED TO 15 mm	
3	FIBERBLOK ANCHOR IBA	
4	FIBERBLOK STARTING ANCHOR STARTIBA	



**IRIS - Industrial Refractories & Insulating Specialities**  
 Parc d'Activités Aérodrome Ouest - Rouvignies - F - 59328 VALENCIENNES Cedex (France)

Tél : +33 (0)3.27.21.52.80  
 E-mail: [contact@irisfrance.com](mailto:contact@irisfrance.com)

Fax : +33 (0)3.27.21.52.99  
 Web: [www.irisfrance.com](http://www.irisfrance.com)

This drawing is the property of IRIS. Unauthorised use of patented features and/or reproduction of this drawing is strictly prohibited

# FIBERBLOK & FIBERBLOK ANCHOR

## INSTALLATION EXAMPLE

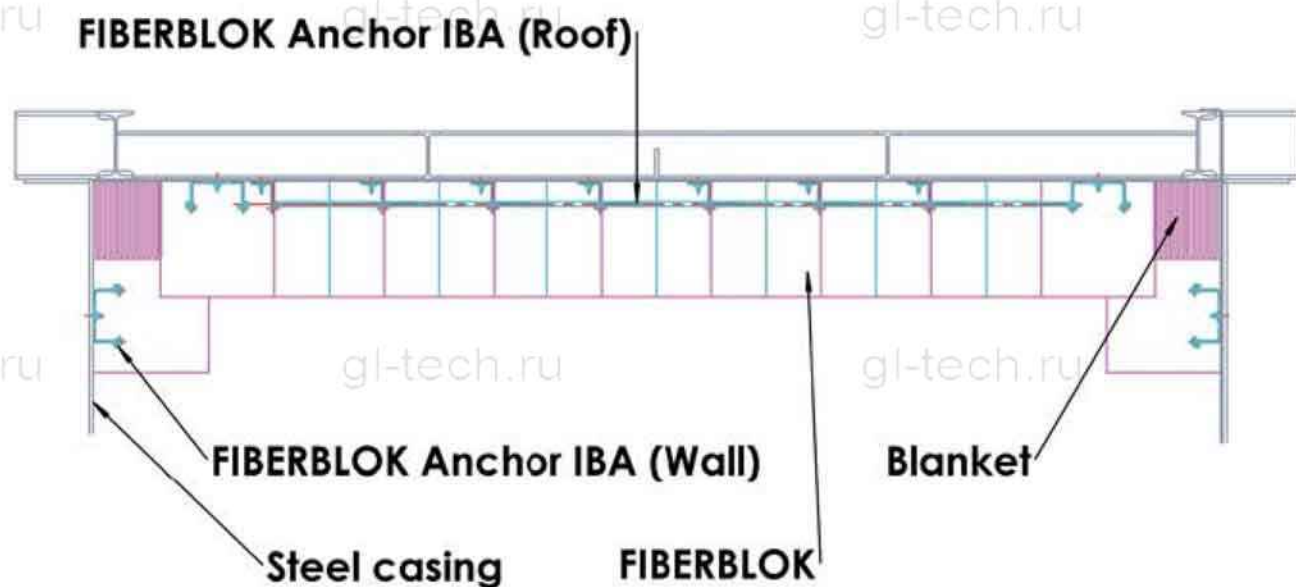
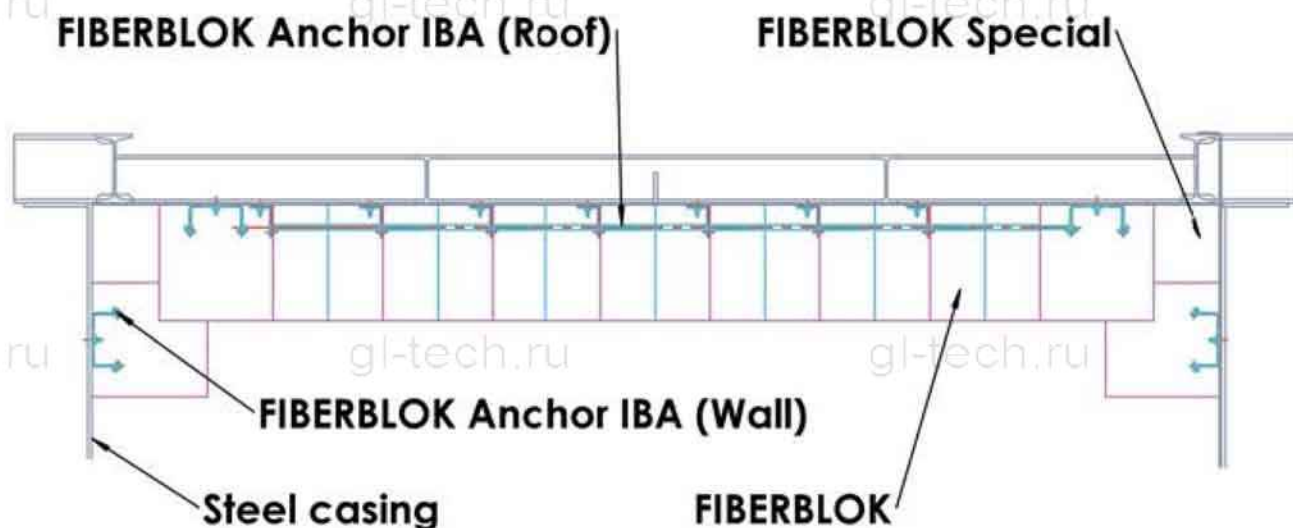

**IRIS - Industrial Refractories & Insulating Specialities**  
Parc d'Activités Aéroport Ouest - Rouvignies - F - 59328 VALENCIENNES Cedex (France)

Tél : +33 (0)3.27.21.52.80  
E-mail: [contact@irisfrance.com](mailto:contact@irisfrance.com)

Fax : +33 (0)3.27.21.52.99  
Web: [www.irisfrance.com](http://www.irisfrance.com)

This drawing is the property of IRIS. Unauthorised use of patented features and/or reproduction of this drawing is strictly prohibited

# FIXING SET FOR FIBERBLOK

NO BACK UP material between FIBERBLOK and STEEL CASING

STUD WELDING EQUIPMENT and SKILED WELDERS AVAILABLE



**NUT HM6 or HM8 -DIN934 - AISI 304 or AISI 310**



**WASHER M8-DIN 125 - AISI 304 or AISI 310**



**DRS.6 or 8.RT.040.304 - AB (FULLY THREADED)  
(other alloys on request)**

Alu Ball (option "AB") requested from  
M8 and more. Makes gun welding easier

Aluminium ball



**CERAMIC FERRULE FOR STUD WELDING**

**1 FIXING SET includes :**

**1 DRS length 30mm  
1 FERRULE  
1 WASHER  
1 NUT**



**IRIS - Industrial Refractories & Insulating Specialities**

Parc d'Activités Aéroport Ouest - Rouvignies - F - 59328 VALENCIENNES Cedex (France)

**Tél : +33 (0)3.27.21.52.80**

**E-mail: [contact@irisfrance.com](mailto:contact@irisfrance.com)**

**Fax : +33 (0)3.27.21.52.99**

**Web: [www.irisfrance.com](http://www.irisfrance.com)**

This drawing is the property of IRIS. Unauthorised use of patented features and/or reproduction of this drawing is strictly prohibited

# FIXING SET FOR FIBERBLOK

## WITH BACK UP BEHIND FIBERBLOK (recommended)

A 25mm blanket is sometimes used but a rigid board 25 or 30mm is much better.

Microporous panel gives much lower heat loss, much better insulation

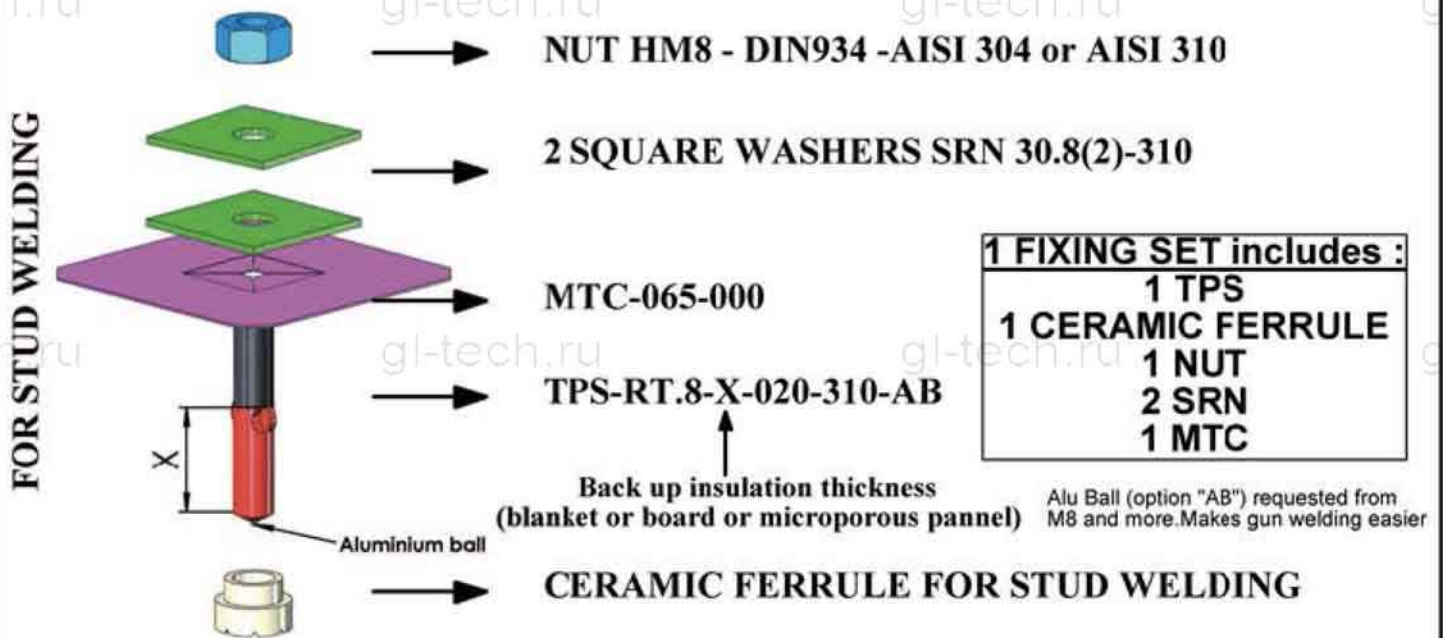
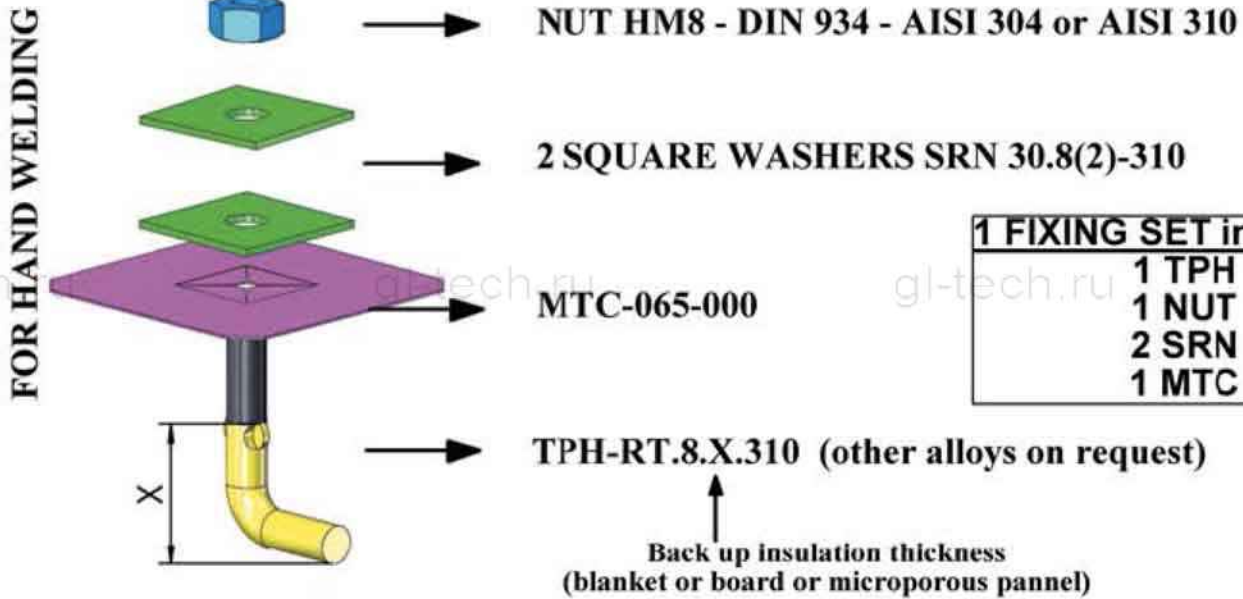

**IRIS - Industrial Refractories & Insulating Specialities**  
Parc d'Activités Aéroport Ouest - Rouvignies - F - 59328 VALENCIENNES Cedex (France)

Tél : +33 (0)3.27.21.52.80  
E-mail: [contact@irisfrance.com](mailto:contact@irisfrance.com)

Fax : +33 (0)3.27.21.52.99  
Web: [www.irisfrance.com](http://www.irisfrance.com)

This drawing is the property of IRIS. Unauthorised use of patented features and/or reproduction of this drawing is strictly prohibited



# DESIGNATION EXAMPLE

Standard alloys and siz

## IBA.6 - 400/155/060 - 310

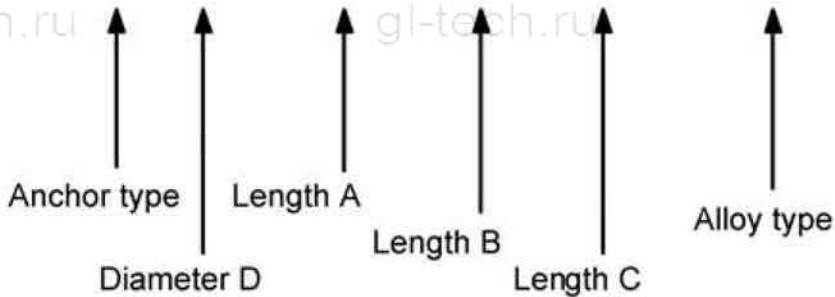

# FIBERBLOK ANCHOR

**STANDARD DESIGNATION : IBA.6 - 400/155/060 - 310  
or IBA.8 - 400/155/060 - 310  
(other dimensions on request)**

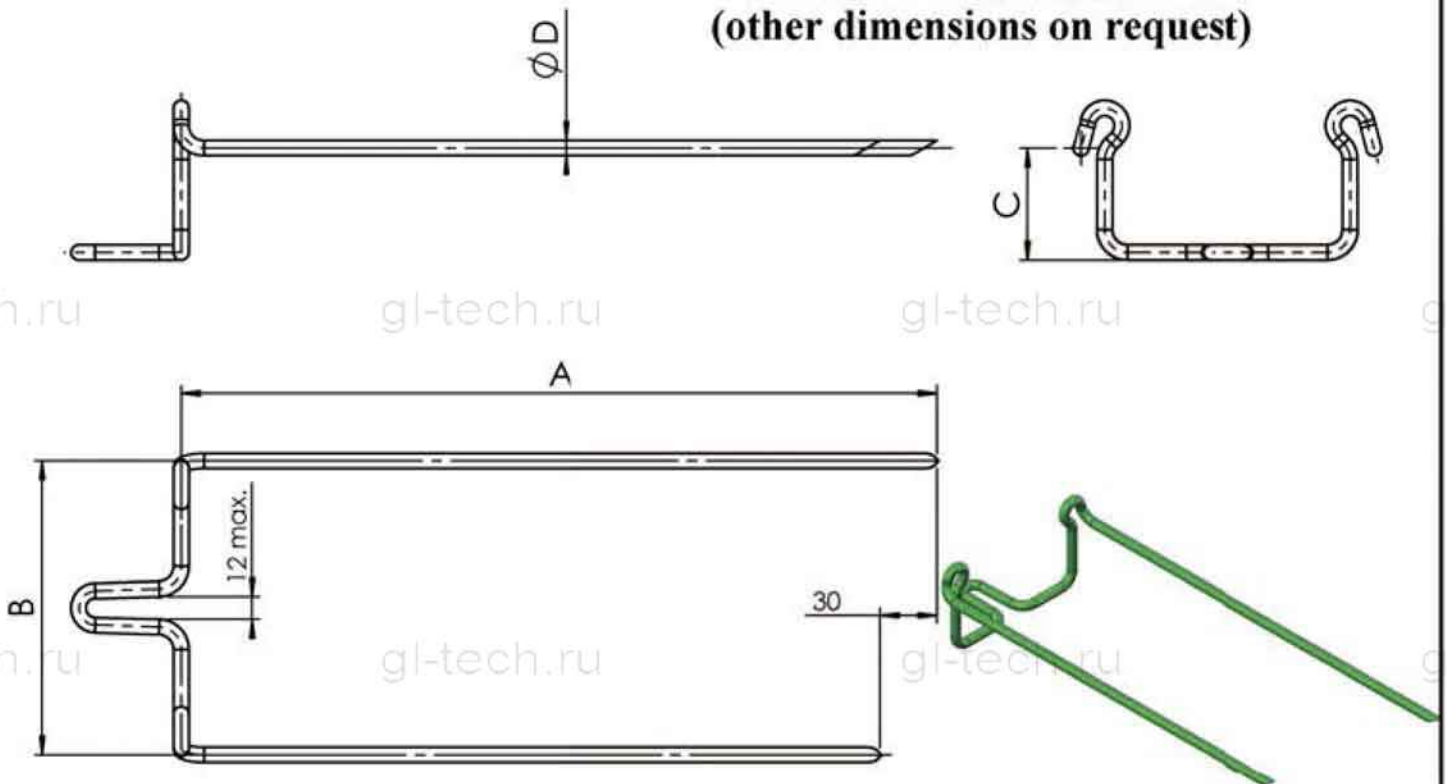

IRIS manufactures anchors from cold drawn wires, with a specific tensile strength, using a "soft bending technique", utilizing rootic machines. This "in house" developed technology, reduces mechanical stress in the steel structure and avoids the formation of micro cracks, through which corrosion can accelerate; and damage the anchors.  
Due to the advanced bending methods developed by IRIS, there are mostly no bending marks in our metal anchors



**IRIS - Industrial Refractories & Insulating Specialities**  
Parc d'Activités Aéroport Ouest - Rouvignies - F - 59328 VALENCIENNES Cedex (France)

Tél : +33 (0)3.27.21.52.80  
E-mail: [contact@irisfrance.com](mailto:contact@irisfrance.com)

Fax : +33 (0)3.27.21.52.99  
Web: [www.irisfrance.com](http://www.irisfrance.com)

This drawing is the property of IRIS. Unauthorised use of patented features and/or reproduction of this drawing is strictly prohibited

# DESIGNATION EXAMPLE

Standard alloys and siz

**IBA.6 - 400/155/059 - 310 - WW**

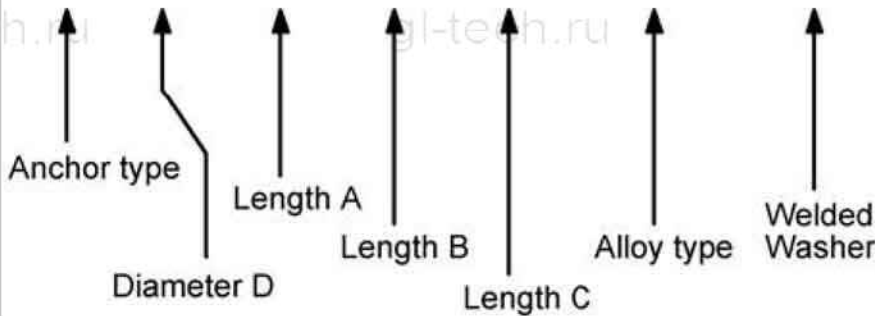

## **FIBERBLOK ANCHOR WELDED WASHER**

**STANDARD DESIGNATION : IBA.6 - 400/155/059 - 310 - WW  
or IBA.8 - 400/155/060 - 310 - WW  
(other dimensions on request)**

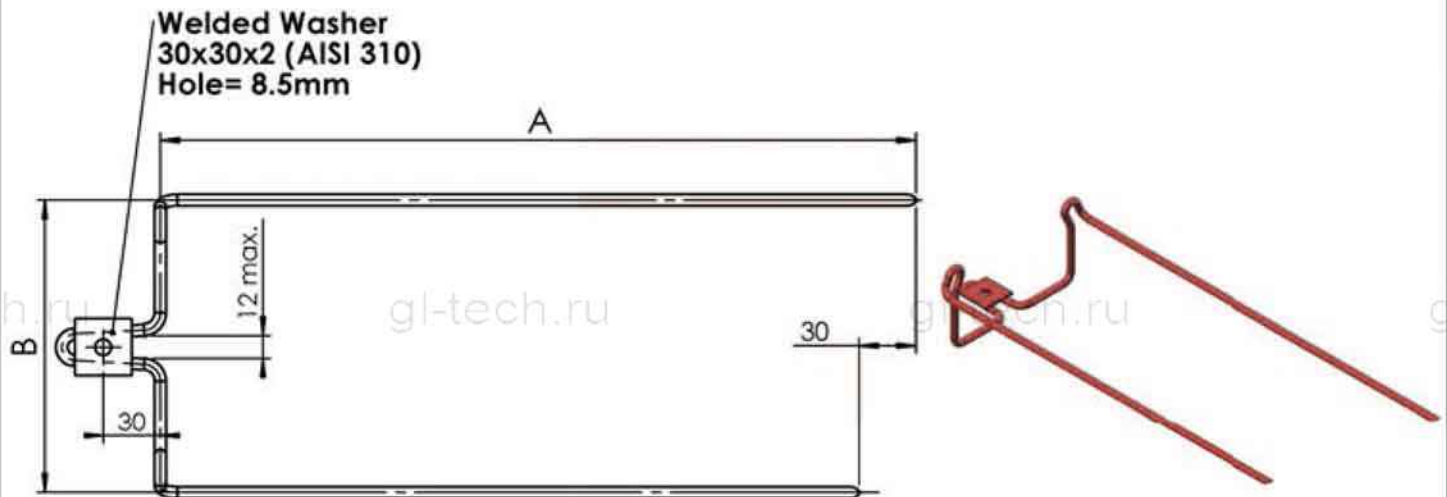
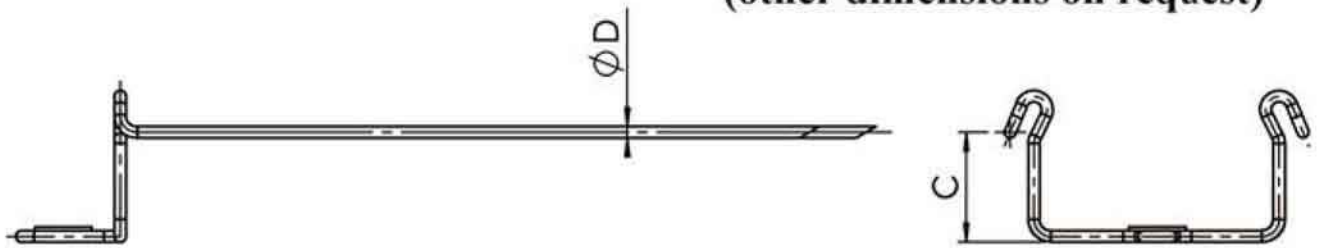

IRIS manufactures anchors from cold drawn wires, with a specific tensile strength, using a "soft bending technique", utilizing robotic machines. This "in house" developed technology, reduces mechanical stress in the steel structure and avoids the formation of micro cracks, through which corrosion can accelerate; and damage the anchors.  
Due to the advanced bending methods developed by IRIS, there are mostly no bending marks in our metal anchors



**IRIS - Industrial Refractories & Insulating Specialities**  
Parc d'Activités Aéroport Ouest - Rouvignies - F - 59328 VALENCIENNES Cedex (France)

Tél : +33 (0)3.27.21.52.80  
E-mail: [contact@irisfrance.com](mailto:contact@irisfrance.com)

Fax : +33 (0)3.27.21.52.99  
Web: [www.irisfrance.com](http://www.irisfrance.com)

This drawing is the property of IRIS. Unauthorised use of patented features and/or reproduction of this drawing is strictly prohibited

# DESIGNATION EXAMPLE

Standard alloys and siz

**STARTIBA.6.050.155.059 - 310**

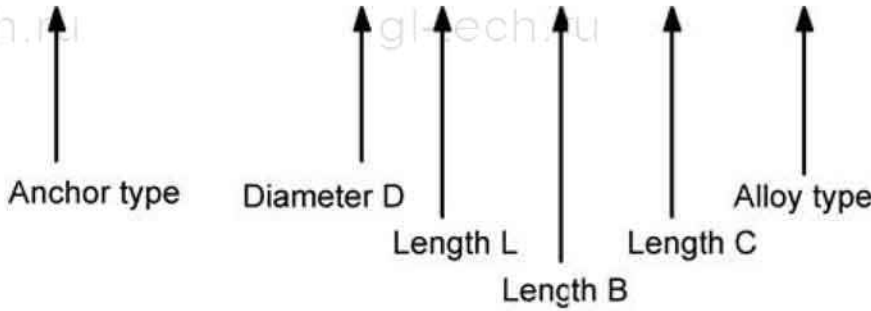

# STARTING ANCHOR

L mini = 35mm

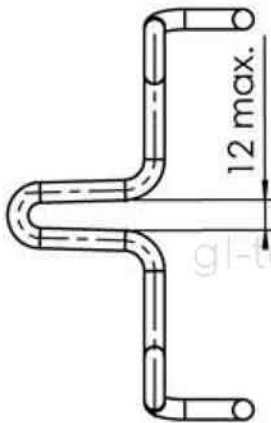
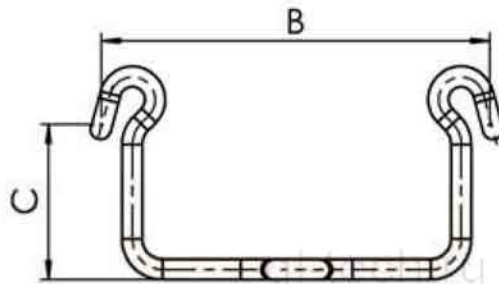
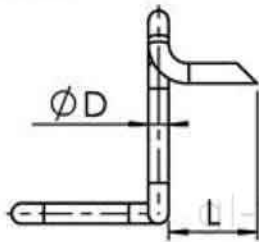

IRIS manufactures anchors from cold drawn wires, with a specific tensile strength, using a "soft bending technique", utilizing robotic machines. This "in house" developed technology, reduces mechanical stress in the steel structure and avoids the formation of micro cracks, through which corrosion can accelerate; and damage the anchors.  
Due to the advanced bending methods developed by IRIS, there are mostly no bending marks in our metal anchors



**IRIS - Industrial Refractories & Insulating Specialities**  
Parc d'Activités Aéroport Ouest - Rouvignies - F - 59328 VALENCIENNES Cedex (France)

Tél : +33 (0)3.27.21.52.80  
E-mail: [contact@irisfrance.com](mailto:contact@irisfrance.com)

Fax : +33 (0)3.27.21.52.99  
Web: [www.irisfrance.com](http://www.irisfrance.com)

This drawing is the property of IRIS. Unauthorised use of patented features and/or reproduction of this drawing is strictly prohibited

DESIGNATION EXAMPLE

Standard alloys

**TRN.60 - 010(6) - 304**

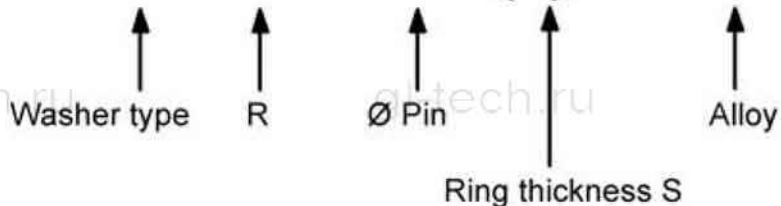

**THREADED CENTRAL HOLE**

**TRN**

**TSR**

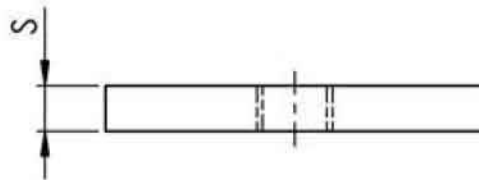
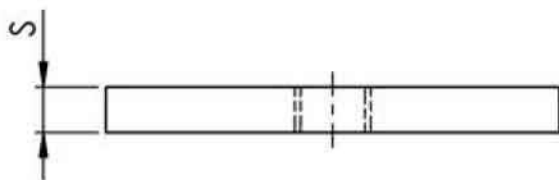
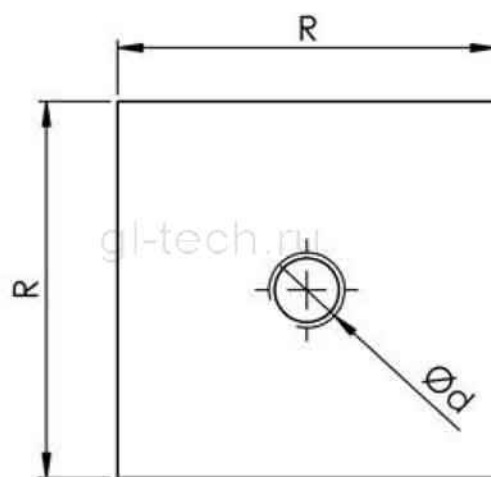
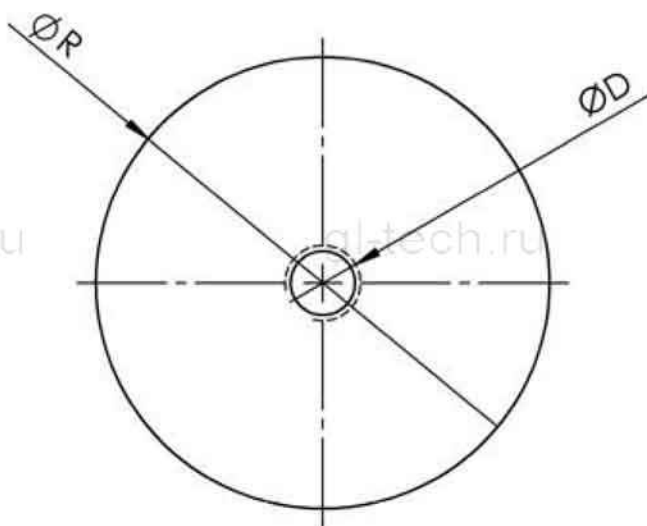

**IRIS - Industrial Refractories & Insulating Specialities**  
 Parc d'Activités Aérodrome Ouest - Rouvignies - F - 59328 VALENCIENNES Cedex (France)

Tél : +33 (0)3.27.21.52.80  
 E-mail: [contact@irisfrance.com](mailto:contact@irisfrance.com)

Fax : +33 (0)3.27.21.52.99  
 Web: [www.irisfrance.com](http://www.irisfrance.com)

This drawing is the property of IRIS. Unauthorised use of patented features and/or reproduction of this drawing is strictly prohibited